

# PHONIC

## Sound Ambassador 75 Deluxe Sound Ambassador 120 Deluxe

Wireless Portable Sound System

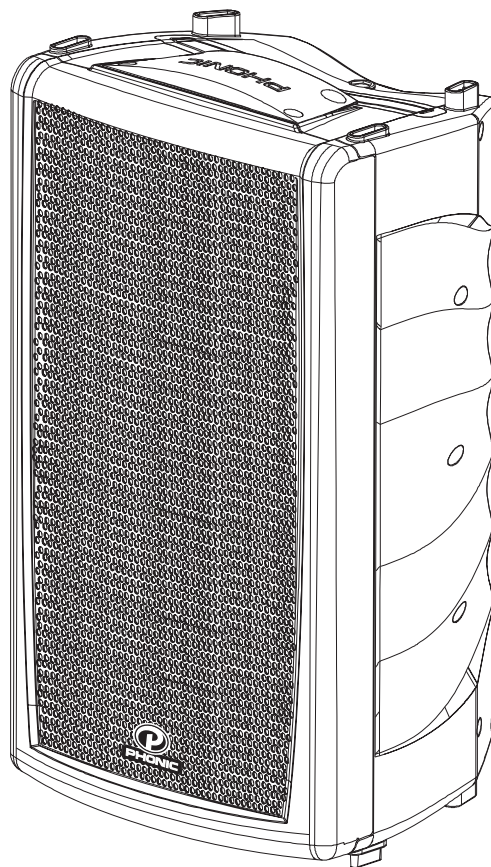

English

User's Manual

## IMPORTANT SAFETY INSTRUCTIONS

The apparatus shall not be exposed to dripping or splashing and that no objects filled with liquids, such as vases, shall be placed on the apparatus. The MAINS plug is used as the disconnect device, the disconnect device shall remain readily operable.

**Warning:** the user shall not place this apparatus in the confined area during the operation so that the mains switch can be easily accessible.

1. Read these instructions before operating this apparatus.
2. Keep these instructions for future reference.
3. Heed all warnings to ensure safe operation.
4. Follow all instructions provided in this document.
5. Do not use this apparatus near water or in locations where condensation may occur.
6. Clean only with dry cloth. Do not use aerosol or liquid cleaners. Unplug this apparatus before cleaning.
7. Do not block any of the ventilation openings. Install in accordance with the manufacturer's instructions.
8. Do not install near any heat sources such as radiators, heat registers, stoves, or other apparatus (including amplifiers) that produce heat.
9. Do not defeat the safety purpose of the polarized or grounding-type plug. A polarized plug has two blades with one wider than the other. A grounding type plug has two blades and a third grounding prong. The wide blade or the third prong is provided for your safety. If the provided plug does not fit into your outlet, consult an electrician for replacement of the obsolete outlet.
10. Protect the power cord from being walked on or pinched particularly at plug, convenience receptacles, and the point where they exit from the apparatus.
11. Only use attachments/accessories specified by the manufacturer.
12. Use only with a cart, stand, tripod, bracket, or table specified by the manufacturer, or sold with the apparatus. When a cart is used, use caution when moving the cart/apparatus combination to avoid injury from tip-over.
13. Unplug this apparatus during lightning storms or when unused for long periods of time.
14. Refer all servicing to qualified service personnel. Servicing is required when the apparatus has been damaged in any way, such as power-supply cord or plug is damaged, liquid has been spilled or objects have fallen into the apparatus, the apparatus has been exposed to rain or moisture, does not operate normally, or has been dropped.

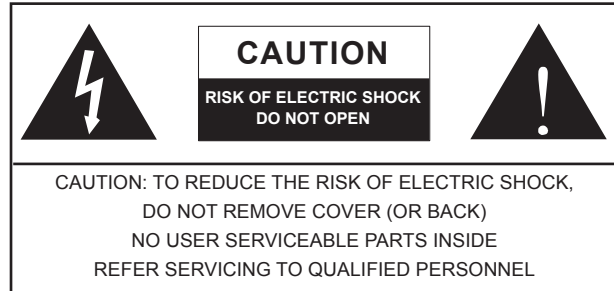

The lightning flash with arrowhead symbol, within an equilateral triangle, is intended to alert the user to the presence of uninsulated "dangerous voltage" within the product's enclosure that may be of sufficient magnitude to constitute a risk of electric shock to persons.



The exclamation point within an equilateral triangle is intended to alert the user to the presence of important operating and maintenance (servicing) instructions in the literature accompanying the appliance.

**WARNING:** To reduce the risk of fire or electric shock, do not expose this apparatus to rain or moisture.

**CAUTION:** Use of controls or adjustments or performance of procedures other than those specified may result in hazardous radiation exposure.



# Sound Ambassador 75/120 Deluxe

## Wireless Portable Sound System

### USER'S MANUAL

#### TABLE OF CONTENTS

INTRODUCTION.....	4
FEATURES.....	4
OPTIONAL ACCESSORIES.....	5
BASIC SETUP.....	5
CONNECTIONS AND SETTINGS.....	6
WIRELESS MICROPHONE RECEIVER.....	8
CD PLAYER.....	8
TAPE PLAYER.....	9
OTHER IMPORTANT FEATURES.....	10
APPLICATION.....	11
SPECIFICATIONS.....	12
DIMENSIONS.....	14
BLOCK DIAGRAM.....	15

## Introduction

We at Phonic would like to congratulate you on your purchase of our Sound Ambassador 75 Deluxe or 120 Deluxe wireless portable sound system. This extremely stylish system will allow you to carry all the gear you need to set up a moderate front of house sound system anywhere you go without lugging around chunky mixers, speakers and cords.

Including microphone and line inputs, as well as mini stereo in/out, the Sound Ambassador Deluxe provides just enough room for a small band, choir or DJ to give their audience crystal clear sound. The Sound Ambassador can be further customized to include a CD Player and Tape Player for adding to the versatility of these great speakers. The built-in amplifier pumps 75 or 120 Watts of power through the 1" tweeter and 10" woofer – all of which is built right into the cabinet!

This owner's manual was designed to give you a clear picture of all the features and functions of the Sound Ambassador Deluxe. It is strongly advised that you read this manual carefully before storing it in an easily accessible in case it is needed for future reference.

## Features

- All-in-one portable sound system with retractable trolley and wheels
- 10" 2-way speaker system (120 Watts @ 4 ohms on the Sound Ambassador 120 Deluxe, 75 Watts @ 4 ohms on the Sound Ambassador 75 Deluxe)
- Optional UHF wireless microphones, CD player with anti-shock, MP3 recorder, and audio cassette recorder
- 100-240VAC switching power supply
- Built-in DC charging circuit
- 24 VDC supply from two built-in, maintenance-free lead acid type rechargeable batteries
- 24-32VDC inlet for external power supply
- Slot for choice of two UHF PLL synthesized diversity or fixed frequency type wireless receiver modules
- Built-in diversity receiving antennas
- One XLR and one 1/4" phone jack for wired microphone input
- 1/4" phone jacks and mini-stereo jacks for line-level input and output
- Built-in limiter and protection circuitry to minimize distortion and overload
- Individual volume control for wired and wireless microphones
- Master volume control and two-band system EQ
- Switched and unswitched speaker output jacks
- Tripod stand adapter included
- Luxury molded cabinet, stackable or can be used as a floor monitor or mounted as a raised sound reinforcement system

## Optional Accessories

- *UM30*: UHF (16-ch) Wireless Handheld System including a HT-100 transmitter and UM-R10 receiver
- *UM40*: UHF (16-ch) Wireless Lavalier System including a BT-200 transmitter, ML-10 Microphone and UM-R10 receiver
- *UM50*: UHF (16-ch) Wireless Headset System including BT-200 transmitter, MH-20 Microphone and UM-R10 receiver
- *MK3-SA*: Wall/Ceiling Mounting kit
- *CD Player*
- *Cassette Recorder*
- *MP3 recorder*

## Basic Setup

1. Ensure all power is turned off on the Sound Ambassador Deluxe.
2. All level controls should be set at the lowest level to ensure no sound is inadvertently sent through the outputs when the device is switched on. All levels can be adjusted to acceptable degrees after the device is turned on.
3. Plug all necessary instruments and/or equipment into the Sound Ambassador's various inputs as required. This may include devices such as microphones, electric guitars, keyboards, etc.
4. Though it is not required (as the Sound Ambassador Deluxe's speaker is built-in), you may wish to connect various devices to the Sound Ambassador Deluxe's outputs, which could further enhance your set up.
5. Plug the supplied AC cable into the AC inlet on the back of the device, ensuring the local voltage level is identical to that set by the voltage selection switch on your device. Plug the other end into an AC power outlet. This is, of course, not really necessary as the Sound Ambassador Deluxe has an internal battery.
6. Turn the power switch on, and you should be ready to go.

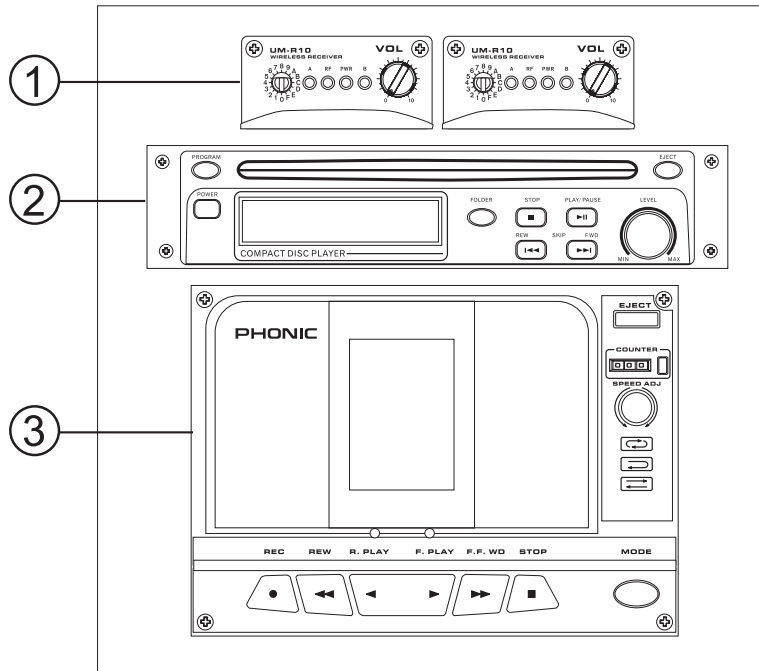

## Connections and Settings

### 1. Wireless Microphone Module Slot

These two slots are for the addition of wireless microphone modules to your Sound Ambassador. They allow users to use microphones from various locations without a cord getting in the way. For information on purchasing the wireless microphone kit, please contact your nearest Phonic dealer. For more information, please consult page 8.

**Please Note:** The wireless modules act as their own, individual channel, with its own volume control – the signal of which is sent to the main mixing bus.

### 2. CD Player Module Slot

This slot is for the addition of an optional Compact Disc player to the Ambassador Deluxe. By adding the CD player users are able to feed the audio from CDs to the built-in mixer. For more information, please consult page 8.

### 3. Cassette Player Module Slot

This slot is for the addition of an optional Tape Deck to the Ambassador Deluxe. By adding the Cassette player users are able to combine the audio from Audio Cassettes with the main signal of the built-in mixer. The final level of the optional Cassette Player is adjustable by the Tape In control on the main mixing panel. Other devices may also be used in this slot, such as an MP3 recorder. For more information, please consult page 9.

### 4. Level Control

These level controls on Mic 1 and 2, as well as the Line Input channel, adjust the level of the audio that is received through the corresponding inputs.

### 5. Microphone Input

This 3-pin XLR microphone jack and 1/4" Phone Jack are for the addition of low and high impedance microphones to the Sound Ambassador Deluxe. On the XLR Mic inputs, we recommend using professional balanced dynamic or ribbon mics as they are less likely to have interference and provide a good quality of sound.

### 6. Line Input

These inputs accept typical 1/4" TRS or TS inputs, for balanced or unbalanced signals, as well as mini stereo inputs. The 1/4" jacks are best suited for input of electric guitars, bass guitars, synthesizers and drum machines, as well as other similar line-level instruments, whereas the mini stereo inputs are suitable for many portable consumer playback devices such as MP3 players.

### 7. Line Outputs

This 1/4" and mini stereo output send the main signal of the Sound Ambassador Deluxe to external devices. Users are able to send the signal to other sound systems, allowing the signal to be incorporated in other mixes, or to an amplifier, allowing other speakers to output the signal in addition to the built-in speaker, as well as link to other Sound Ambassadors Deluxe. These outputs are in no way affected by the master level control.

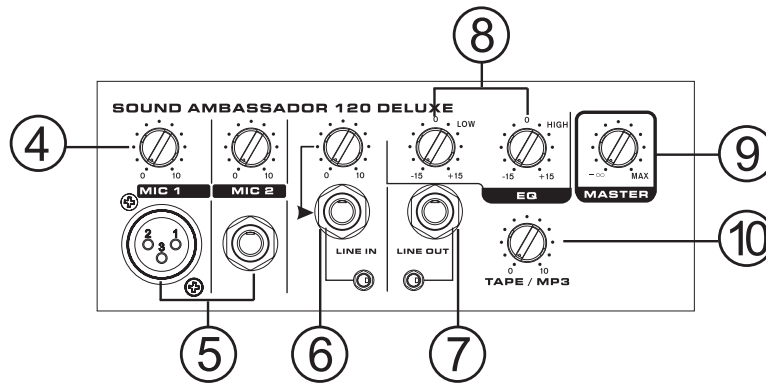

**8. Master EQ**

This 2-band EQ allows users to adjust the high and low frequency sounds of their main signal at 80 Hz and 10 kHz, respectively.

**9. Master Level Control**

This control will allow users to adjust the final level of the signal sent to the built-in power amplifier and speakers. This will in no way affect the line outputs.

**10. Tape In / MP3 Control**

This rotary control allows users to adjust the level of audio that is received from the optional Tape player or MP3 recorder.

**11. Speaker Outputs**

These 1/4" TS outputs allow users to send the main signal of the Sound Ambassador Deluxe to an external passive speaker. The impedance of the passive speaker should be no less than 8 ohms. When a speaker is connected to the left output, the built-in speakers will run in parallel with the connected speaker. When a speaker is connected to the right output ("switched"), the Sound Ambassador's built-in speaker will be bypassed.

**12. DC Power Input**

This inlet is for the connection of a 24V – 32V DC power source, which can be provided by an external DC power source.

**13. Power Indicators**

The lights just to the left of the DC input allow users to see the status of the battery. Batt. Full, illuminates when the Battery is at full capacity, and Charging flashes when the internal battery is in the process of charging. The Power LED will light up when the Sound Ambassador is on, whether it is powered through the internal battery or AC power. When the battery level is low, the Power LED will flash for a few seconds before shutting the device down.

**14. AC Power Inlet and Fuse Holder**

This is for the addition of an AC power source to the Sound Ambassadors 75 and 120 Deluxe. Connect the provided power cable into this inlet, and the other end into a suitable AC power source. This power outlet also features a fuse holder. If the fuse blows, it must be replaced with another suitable fuse (as indicated on the fuse holder's cover). The Sound Ambassador will not operate on AC power if the fuse is damaged or missing.

**15. Power Switch**

Flicking this switch turns the Sound Ambassador on and off. If no AC power source is connected to the device, power will be supplied by the built-in battery. When the power is turned on, the blue Power LED (below the Charge LED) will illuminate.

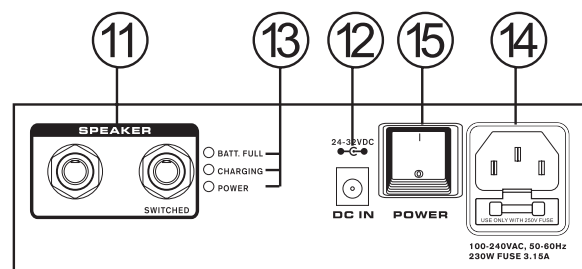

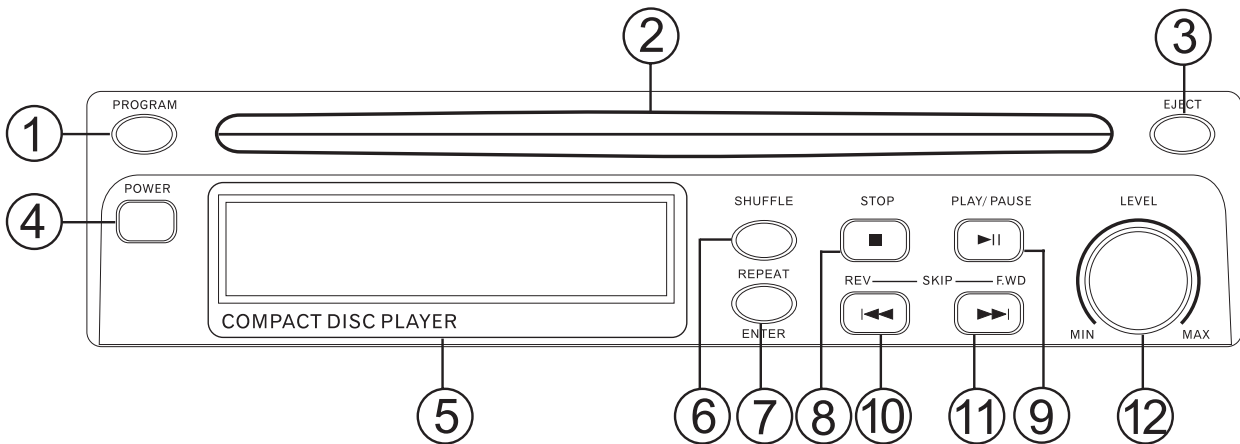

**Wireless Microphone Receiver**

1. **Frequency Select** – Use this to select the frequency at which the wireless module will receive signals. The wireless microphone should be set to the same frequency.
2. **A Indicator** – Depending which antennae is being used, either the A or B indicators will illuminate.
3. **AF Indicator** – AF Indicator - This will illuminate when a wireless microphone audio signal is received.
4. **B Indicator** – Depending which antennae is being used, either the A or B indicators will illuminate.
5. **PWR Indicator** – When the device is turned on, this LED will light up.
6. **Volume Control** – The volume of the microphone signal can be adjusted using this. Turning this control all the way to the left will effectively turn the wireless microphone module off.

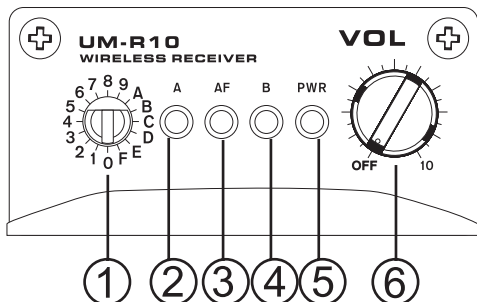

**CD Player**

1. **Program** – Push this button to enter a track into your program memory, to play the CD in the track order of your choosing.
2. **CD Slot** – Insert your CD here. Ensure the CD's label is facing upwards.
3. **Eject** – When a CD is loaded, push this button to remove.
4. **Power** – Pushing this button turns the power of the CD player on and off.
5. **Digital Display** – View the track number and elapsed time here.
6. **Shuffle** – Pushing this button allows the CD player to play tracks in a random order.
7. **Repeat / Enter** – Push this button to set the repeat mode.
8. **Stop** – When a CD is playing, push this button to stop it.
9. **Pause/Play** – Pushing this button plays or pauses the selected track.
10. **Reverse** – Push this button to go back through the tracks. Hold it down to rewind an individual track.
11. **Forwards** – Pushing this button skips forward through the tracks. Holding it down will allow you to skip forward through an individual track.
12. **Level Control** – adjust the level of the CD player's audio using this knob.

When the Sound Ambassador is used as a floor monitor, do not attempt to use the built-in CD player.

Information contained within this page may be outdated by time of printing.

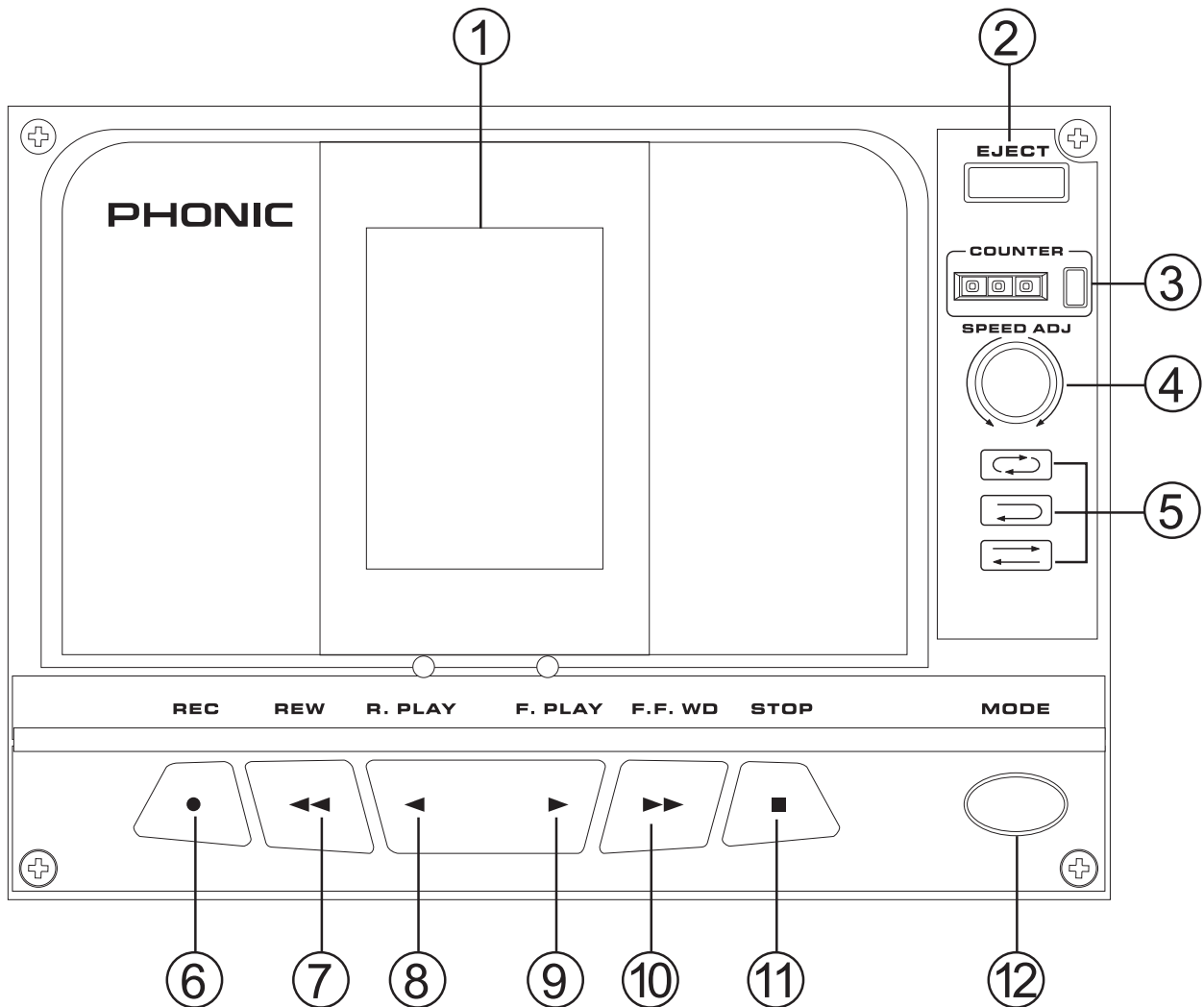

## Tape Player

1. **Tape Deck** – when the tape deck has been opened, insert a cassette (magnetic tape down) here.
2. **Eject** – Push this button to open the tape deck.
3. **Counter** – Gives a visual indication of time elapsed on the tape. Press the restart button to set to 000.
4. **Speed Adjust** – Slow down or speed up the tape using this.
5. **Repeat Display** – Users can see how their tape will react when it gets to the end of the current side. Select the repeat type by pushing the Mode button.
6. **Record** – Push this button and either the reverse play or forward play buttons to record any signal sent to the tape player.
7. **Rewind** – Rewind the tape using this button.
8. **Reverse Play** – Play the “other side” of your tape, using this button.
9. **Forward Play** – Play your cassette on the side that you inserted it.
10. **Fast Forward** – Quickly skip through the tape using this.
11. **Stop** – Stop playing your tape by pushing this button.
12. **Mode** – This allows you to adjust the tape player so it plays a single side then stops, plays both sides and stops, or continuously plays both sides until you stop it manually. Your option will be shown on the repeat display (5).

Information contained within this page may be outdated by time of printing.

## OTHER IMPORTANT FEATURES

### Opening the Battery Cover

Remove the screws to open the battery cover. If a replacement battery is necessary, please contact your nearest Phonic dealer.

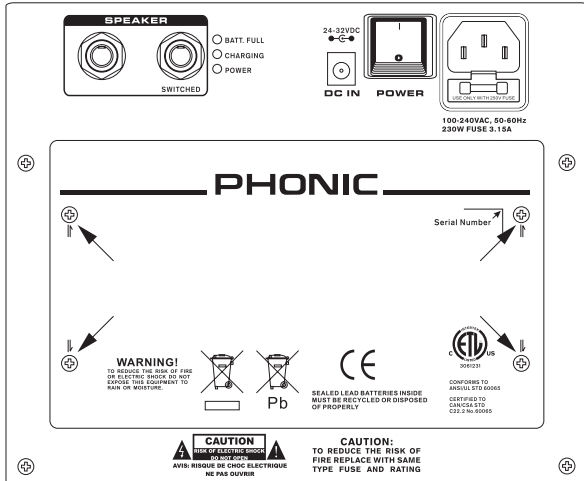

### Retractable Handle and Wheels

The retractable handle on the top of the Sound Ambassador Deluxe, and the inbuilt wheels, makes moving the unit around trouble-free.

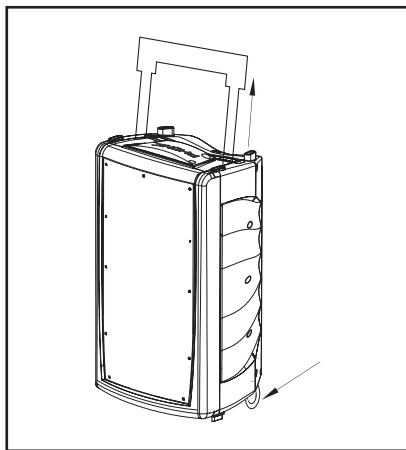

### As a Floor Monitor

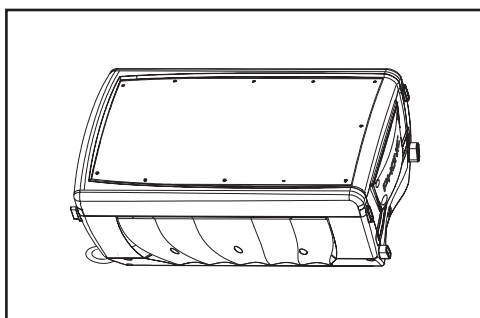

### Stack-Points

These four points on the Sound Ambassador Deluxe making stacking multiple devices a whole lot easier.

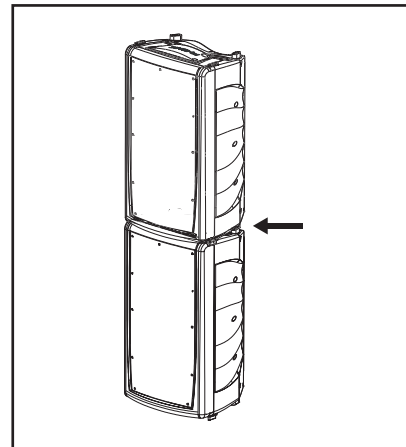

### Tripod Stand Socket

Flip the Sound Ambassador over. On the bottom, you will find a hole ideal for use with tripod stands (35mm in diameter).

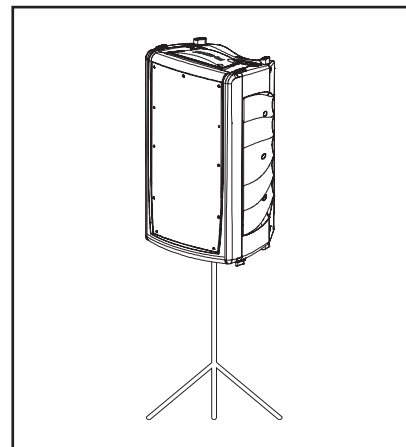

### Wall Mount Points

The optional wall mount can be attached to the Sound Ambassador deluxe modules using the M10 screw holes on the top and bottom of the unit.

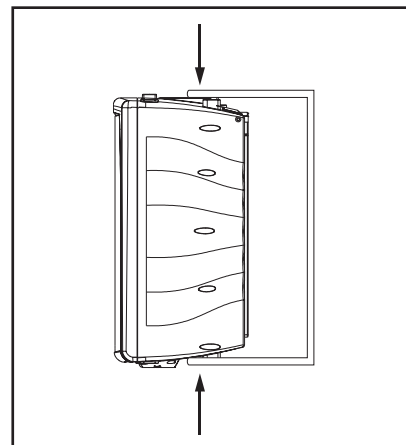

APPLICATION

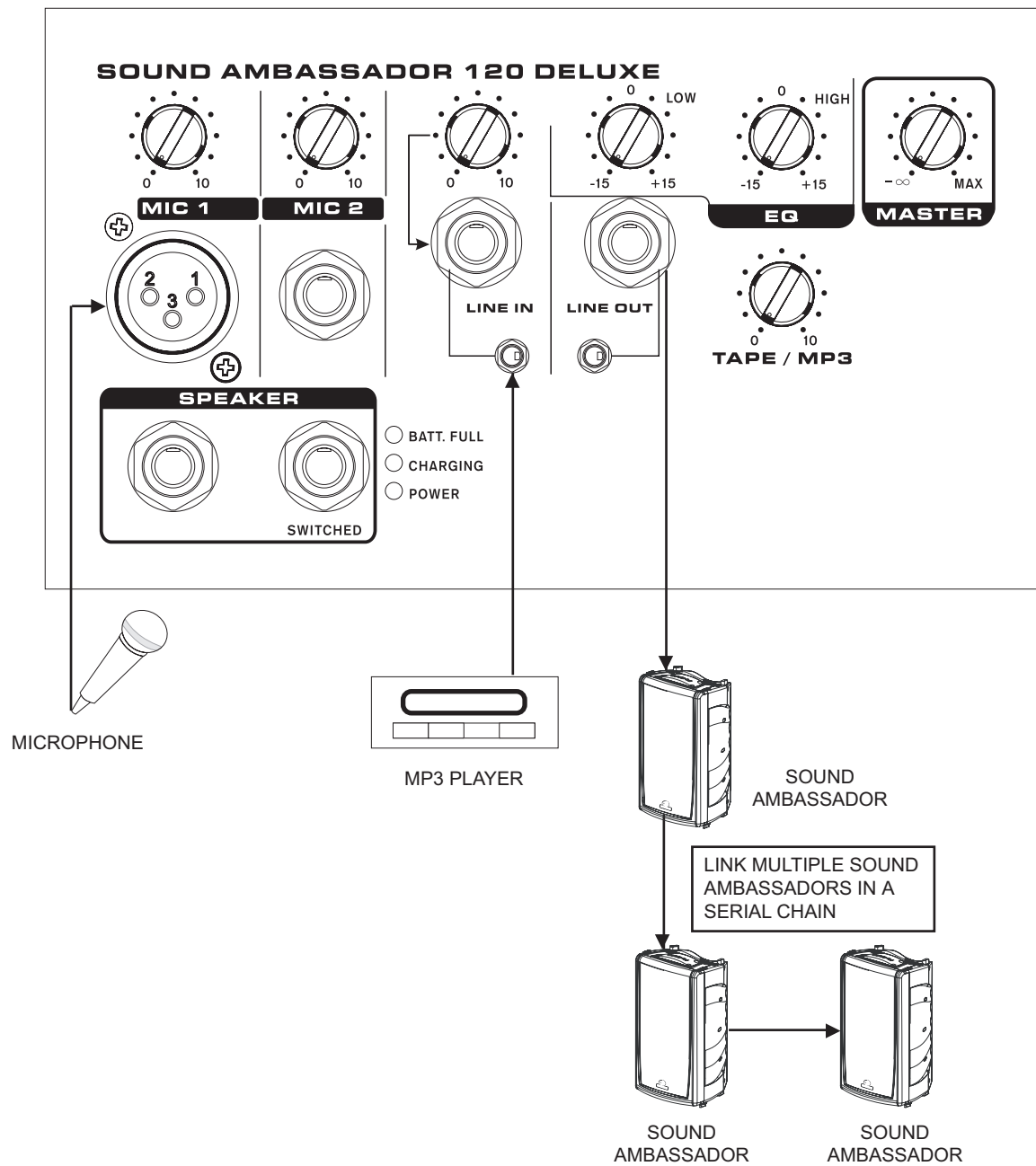

## SPECIFICATIONS

	<b>Sound Ambassador 75 Deluxe</b>	<b>Sound Ambassador 120 Deluxe</b>
Woofers	10"	10"
Tweeter	1" driver	1" driver
Amplifier (watts), RMS	75 Watt @ 4 ohm; 50 Watt @ 8 ohm	120 Watt @ 4 ohm; 75 Watt @ 8 ohms
Inputs & Outputs	1x XLR mic, 1x 1/4" mic, 1x1/4" & 1x mini stereo line in; 1x 1/4" & 1x mini-stereo line out, 2x 1/4" speaker out	1x XLR mic, 1x 1/4" mic, 1x1/4" & 1x mini stereo line in; 1x 1/4" & 1x mini-stereo line out, 2x 1/4" speaker out
Tone control		
Treble	+/- 15dB @10k Hz	+/- 15dB @10k Hz
Bass	+/- 15dB @ 80Hz	+/- 15dB @ 80Hz
Frequency response (-10dB point)	50Hz~20KHz	50Hz~20KHz
Indicator		
Battery Full	Green	Green
Charging LED	Red (flashing)	Red (flashing)
Power LED	Blue	Blue
Appearance		
Retractable Trolley	Yes	Yes
Wheels	Yes	Yes
Handle	on top	on top
Mount standable	35mm tripod stand socket	35mm tripod stand socket
Stackable	Yes	Yes
Floor monitor version	Yes	Yes
Built-In limiter	Yes	Yes
Protection circuitry	thermal, subsonic, RF protection, Output DC offset, Power on/off muting and HF driver protection	thermal, subsonic, RF protection, Output DC offset, Power on/off muting and HF driver protection
Built-In Battery	2x 12V/4.5Ah	2x 12V/4.5Ah

Recharging time	8 hours	8 hours
Battery life	4-8 hours continuous use	4-8 hours continuous use
Optional accessories	CD player module, MP3 Recorder module, Audio Cassette Recorder, 2x UHF wireless mics	CD player module, MP3 Recorder module, Audio Cassette Recorder, 2x UHF wireless mics
Safety Certificate	CETL, CE	CETL, CE
Power Requirement	100-240VAC, 50/60Hz, or 2x battery power, or external 24-32VDC power	100-240VAC, 50/60Hz, or battery power, or external 24-32VDC power
Dimensions (HxWxD)	24"x11.8"x13.8" (612x300x350 mm)	24"x11.8"x13.8" (612x300x350 mm)
Weight	43 lbs (19.5 kg)	45.2bs (20.5 kg)

## DIMENSIONS

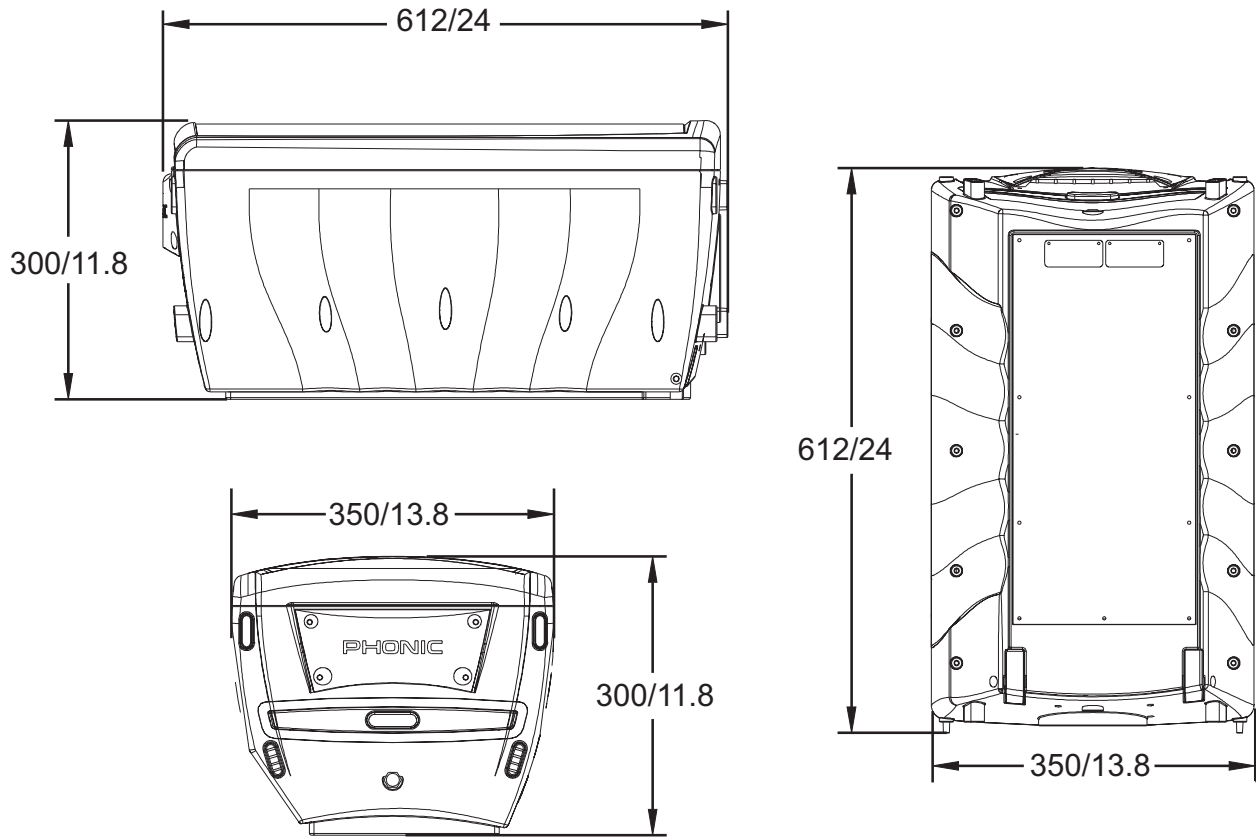

Dimensions are shown in mm/inches

BLOCK DIAGRAM

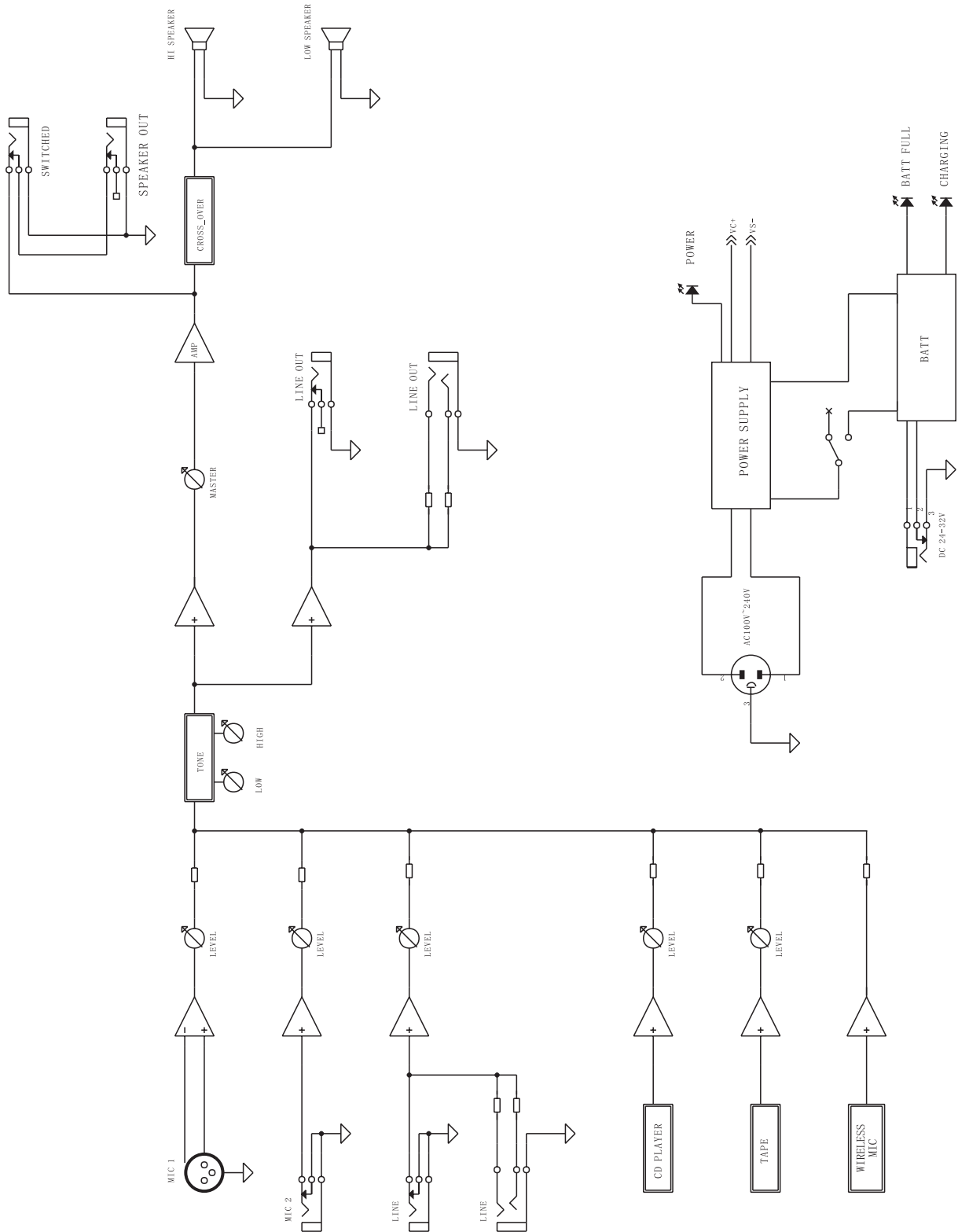

## **TO PURCHASE ADDITIONAL PHONIC GEAR AND ACCESSORIES**

To purchase Phonic gear and optional accessories, contact any authorized Phonic distributor. For a list of Phonic distributors please visit our website at [www.phonic.com](http://www.phonic.com) and click on Get Gear. You may also contact Phonic directly and we will assist you in locating a distributor near you.

## **SERVICE AND REPAIR**

Phonic has over 100 service centers worldwide. For replacement parts, service and repairs please contact the Phonic distributor in your country. Phonic does not release service manuals to consumers, and advice users to not attempt any self repairs, as doing so voids all warranties. You can locate a dealer near you at [www.phonic.com](http://www.phonic.com).

## **WARRANTY INFORMATION**

Phonic stands behind every product we make with a no-hassles warranty. Warranty coverage may be extended, depending on your region. Phonic Corporation warrants this product for a minimum of one year from the original date of purchase against defects in material and workmanship under use as instructed by the user's manual. Phonic, at its option, shall repair or replace the defective unit covered by this warranty. Please retain the dated sales receipt as evidence of the date of purchase. You will need it for any warranty service. No returns or repairs will be accepted without a proper RMA number (return merchandise authorization). In order to keep this warranty in effect, the product must have been handled and used as prescribed in the instructions accompanying this warranty. Any tempering of the product or attempts of self repair voids all warranty. This warranty does not cover any damage due to accident, misuse, abuse, or negligence. This warranty is valid only if the product was purchased new from an authorized Phonic dealer/distributor. For complete warranty policy information, please visit <http://www.phonic.com>.

## **CUSTOMER SERVICE AND TECHNICAL SUPPORT**

We encourage you to visit our online help at <http://www.phonic.com/help/>. There you can find answers to frequently asked questions, tech tips, driver downloads, returns instruction and other helpful information. We make every effort to answer your questions within one business day.

**Phonic America Corporation**  
**5411 Johns Road, #605**  
**Tampa, FL 33634**  
**(813) 890-8872**  
**[support@phonic.com](mailto:support@phonic.com)**  
**<http://www.phonic.com>**

# **PHONIC**