

# DENON

**Digital Controller and Media Player**

# **DN-SC2900**

---

**Owner's Manual**



**CAUTION**  
**RISK OF ELECTRIC SHOCK**  
**DO NOT OPEN**



**CAUTION:**

**TO REDUCE THE RISK OF ELECTRIC SHOCK, DO NOT REMOVE COVER (OR BACK). NO USER-SERVICEABLE PARTS INSIDE. REFER SERVICING TO QUALIFIED SERVICE PERSONNEL.**



The lightning flash with arrowhead symbol, within an equilateral triangle, is intended to alert the user to the presence of uninsulated "dangerous voltage" within the product's enclosure that may be of sufficient magnitude to constitute a risk of electric shock to persons.



The exclamation point within an equilateral triangle is intended to alert the user to the presence of important operating and maintenance (servicing) instructions in the literature accompanying the appliance.

**IMPORTANT TO SAFETY**

**WARNING:**

**To reduce the risk of fire and electric shock, this apparatus should not be exposed to rain or moisture and objects filled with liquids, such as vases, should not be placed on this apparatus.**

**CAUTION:**

**USE OF CONTROLS OR ADJUSTMENTS OR PERFORMANCE OF PROCEDURES OTHER THAN THOSE SPECIFIED HEREIN MAY RESULT IN HAZARDOUS RADIATION EXPOSURE.**

**THIS PRODUCT SHOULD NOT BE ADJUSTED OR REPAIRED BY ANYONE EXCEPT PROPERLY QUALIFIED SERVICE PERSONNEL.**

**FCC INFORMATION**  
**(For US customers)**

**1. COMPLIANCE INFORMATION**

**Product Name: Digital Controller and Media Player**

**Model Number: DN-SC2900**

This product complies with Part 15 of the FCC Rules. Operation is subject to the following two conditions: (1) this product may not cause harmful interference, and (2) this product must accept any interference received, including interference that may cause undesired operation.

Denon Professional div. D&M Professional  
 1100 Maplewood Drive Itasca, IL 60143  
 Tel. 630-741-0330

**2. IMPORTANT NOTICE: DO NOT MODIFY THIS PRODUCT**

This product, when installed as indicated in the instructions contained in this manual, meets FCC requirements. Modification not expressly approved by DENON may void your authority, granted by the FCC, to use the product.

**3. IMPORTANT**

When connecting this product to network hub or router, use only a shielded STP or ScTP LAN cable which is available at retailer.

Follow all installation instructions. Failure to follow instructions could void your authority, granted by the FCC, to use the product.

**4. NOTE**

This product has been tested and found to comply with the limits for a Class B digital device, pursuant to Part 15 of the FCC Rules. These limits are designed to provide reasonable protection against harmful interference in a residential installation.

This product generates, uses and can radiate radio frequency energy and, if not installed and used in accordance with the instructions, may cause harmful interference to radio communications. However, there is no guarantee that interference will not occur in a particular installation. If this product does cause harmful interference to radio or television reception, which can be determined by turning the product OFF and ON, the user is encouraged to try to correct the interference by one or more of the following measures:

- Reorient or relocate the receiving antenna.
- Increase the separation between the equipment and receiver.
- Connect the product into an outlet on a circuit different from that to which the receiver is connected.
- Consult the local retailer authorized to distribute this type of product or an experienced radio/TV technician for help.

For Canadian customers:

This Class B apparatus complies with Canadian ICES-003.

Cet appareil numérique de la classe B est conforme à la norme NMB-003 du Canada.

# IMPORTANT SAFETY INSTRUCTIONS

## READ BEFORE OPERATING EQUIPMENT

This product was designed and manufactured to meet strict quality and safety standards. There are, however, some installation and operation precautions which you should be particularly aware of.

1. Read these instructions.
2. Keep these instructions.
3. Heed all warnings.
4. Follow all instructions.
5. Do not use this apparatus near water.
6. Clean only with dry cloth.
7. Do not block any ventilation openings. Install in accordance with the manufacturer's instructions.
8. Do not install near any heat sources such as radiators, heat registers, stoves, or other apparatus (including amplifiers) that produce heat.
9. Do not defeat the safety purpose of the polarized or grounding-type plug. A polarized plug has two blades with one wider than the other. A grounding type plug has two blades and a third grounding prong. The wide blade or the third prong are provided for your safety. If the provided plug does not fit into your outlet, consult an electrician for replacement of the obsolete outlet.
10. Protect the power cord from being walked on or pinched particularly at plugs, convenience receptacles, and the point where they exit from the apparatus.
11. Only use attachments/accessories specified by the manufacturer.
12. Use only with the cart, stand, tripod, bracket, or table specified by the manufacturer, or sold with the apparatus. When a cart is used, use caution when moving the cart/apparatus combination to avoid injury from tip-over.
13. Unplug this apparatus during lightning storms or when unused for long periods of time.
14. Refer all servicing to qualified service personnel. Servicing is required when the apparatus has been damaged in any way, such as power-supply cord or plug is damaged, liquid has been spilled or objects have fallen into the apparatus, the apparatus has been exposed to rain or moisture, does not operate normally, or has been dropped.



### □ Laser Class (IEC60825-1:2007) CLASS 1 LASER PRODUCT LUOKAN 1 LASERLAITE KLASS 1 LASERAPPARAT

**ADVARSEL:** USYNLIG LASERSTRÅLING VED ÅBNING, NÅR SIKKERHEDSAFBRYDERE ER UDE AF FUNKTION. UNGDÅ UDSÆTTELSE FOR STRÅLING.

**VAROITUS!** LAITTEEN KÄYTTÄMINEN MUULLA KUIN TÄSSÄ KÄYTTÖOHJEESSA MAINITULLA TAVALLA SAATTA AALTISTAA KÄYTTÄJÄN TURVALLISUUSLUOKAN 1 YLITTÄVÄLLE NÄKYMÄMTTÖMÄLLE LASERSÄTEILYLLE.

**WARNING:** OM APPARATEN ANVÄNDS PÅ ANNAT SÄTT ÄN I DENNA BRUKSANVISNING SPECIFICERATS, KAN ANVÄNDAREN UTSÄTTAS FÖR OSYNLIG LASERSTRÅLNING SOM ÖVERSKRIDER GRÄNSEN FÖR LASERKLASS 1.



ATTENZIONE: QUESTO APPARECCHIO E' DOTATO DI DISPOSITIVO OTTICO CON RAGGIO LASER. L'USO IMPROPRIO DELL'APPARECCHIO PUO' CAUSARE PERICOLOSE ESPOSIZIONI A RADIAZIONI!

## CAUTION

### 1. Handle the power supply cord carefully

Do not damage or deform the power supply cord. If it is damaged or deformed, it may cause electric shock or malfunction when used. When removing from wall outlet, be sure to remove by holding the plug attachment and not by pulling the cord.

### 2. Do not open the rear cover

In order to prevent electric shock, do not open the top cover. If problems occur, contact your DENON DEALER.

### 3. Do not place anything inside

Do not place metal objects or spill liquid inside the system. Electric shock or malfunction may result.

Please, record and retain the Model name and serial number of your set shown on the rating label.

Model No. DN-SC2900

Serial No. \_\_\_\_\_

“CLASS 1  
LASER PRODUCT”

□ **NOTES ON USE/HINWEISE ZUM GEBRAUCH/OBSERVATIONS RELATIVES A L'UTILISATION/  
NOTE SULL'USO/NOTAS SOBRE EL USO/ALVORENS TE GEBRUIKEN/OBSERVERA**

WARNINGS	WARNHINWEISE	AVERTISSEMENTS	AVVERTENZE	ADVERTENCIAS	WAARSCHUWINGEN	VARNINGAR
<ul style="list-style-type: none"> <li>Handle the power cord carefully. Hold the plug when unplugging the cord.</li> <li>Keep the unit free from moisture, water, and dust.</li> <li>Unplug the power cord when not using the unit for long periods of time.</li> <li>Do not obstruct the ventilation holes.</li> <li>Do not let foreign objects into the unit.</li> <li>Do not let insecticides, benzene, and thinner come in contact with the unit.</li> <li>Never disassemble or modify the unit in any way.</li> <li>Ventilation should not be impeded by covering the ventilation openings with items, such as newspapers, tablecloths or curtains.</li> <li>Naked flame sources such as lighted candles should not be placed on the unit.</li> <li>Do not expose the unit to dripping or splashing fluids.</li> <li>Do not place objects filled with liquids, such as vases, on the unit.</li> <li>Do not handle the mains cord with wet hands.</li> <li>When the switch is in the OFF position, the equipment is not completely switched off from MAINS.</li> <li>The equipment shall be installed near the power supply so that the power supply is easily accessible.</li> </ul>	<ul style="list-style-type: none"> <li>Gehen Sie vorsichtig mit dem Netzkabel um. Halten Sie das Kabel am Stecker, wenn Sie den Stecker herausziehen.</li> <li>Halten Sie das Gerät von Feuchtigkeit, Wasser und Staub fern.</li> <li>Decken Sie den Lüftungsbereich nicht ab.</li> <li>Wenn das Gerät längere Zeit nicht verwendet werden soll, trennen Sie das Netzkabel vom Netzstecker.</li> <li>Lassen Sie keine fremden Gegenstände in das Gerät kommen.</li> <li>Lassen Sie das Gerät nicht mit Insektiziden, Benzin oder Verdünnungsmitteln in Berührung kommen.</li> <li>Versuchen Sie niemals das Gerät auseinander zu nehmen oder zu verändern.</li> <li>Die Belüftung sollte auf keinen Fall durch das Abdecken der Belüftungsöffnungen durch Gegenstände wie beispielsweise Zeitungen, Tischtücher, Vorhänge o. Ä. behindert werden.</li> <li>Auf dem Gerät sollten keinerlei direkte Feuerquellen wie beispielsweise angezündete Kerzen aufgestellt werden.</li> <li>Das Gerät sollte keiner tropfenden oder spritzenden Flüssigkeit ausgesetzt werden.</li> <li>Auf dem Gerät sollten keine mit Flüssigkeit gefüllten Behälter wie beispielsweise Vasen aufgestellt werden.</li> <li>Das Netzkabel nicht mit feuchten oder nassen Händen anfassen.</li> <li>Wenn der Schalter ausgeschaltet ist (OFF-Position), ist das Gerät nicht vollständig vom Stromnetz (MAINS) abgetrennt.</li> <li>Das Gerät sollte in der Nähe einer Netzsteckdose aufgestellt werden, damit es leicht an das Stromnetz angeschlossen werden kann.</li> </ul>	<ul style="list-style-type: none"> <li>Manipuler le cordon d'alimentation avec précaution. Tenir la prise lors du débranchement du cordon.</li> <li>Protéger l'appareil contre l'humidité, l'eau et la poussière.</li> <li>Débrancher le cordon d'alimentation lorsque l'appareil n'est pas utilisé pendant de longues périodes.</li> <li>Ne pas obstruer les trous d'aération.</li> <li>Ne pas laisser des objets étrangers dans l'appareil.</li> <li>Ne pas mettre en contact des insecticides, du benzène et un diluant avec l'appareil.</li> <li>Ne jamais démonter ou modifier l'appareil d'une manière ou d'une autre.</li> <li>Ne pas recouvrir les orifices de ventilation avec des objets tels que des journaux, nappes ou rideaux. Cela entraverait la ventilation.</li> <li>Ne jamais placer de flamme nue sur l'appareil, notamment des bougies allumées.</li> <li>L'appareil ne doit pas être exposé à l'eau ou à l'humidité.</li> <li>Ne pas poser d'objet contenant du liquide, par exemple un vase, sur l'appareil.</li> <li>Ne pas manipuler le cordon d'alimentation avec les mains mouillées.</li> <li>Lorsque l'interrupteur est sur la position OFF, l'appareil n'est pas complètement déconnecté du SECTEUR (MAINS).</li> <li>L'appareil sera installé près de la source d'alimentation, de sorte que cette dernière soit facilement accessible.</li> </ul>	<ul style="list-style-type: none"> <li>Manneggiare il cavo di alimentazione con attenzione. Tenete ferma la spina quando scollegate il cavo dalla presa.</li> <li>Tenete l'unità lontana dall'umidità, dall'acqua e dalla polvere.</li> <li>Scollegate il cavo di alimentazione quando prevedete di non utilizzare l'unità per un lungo periodo di tempo.</li> <li>Non coprite i fori di ventilazione.</li> <li>Non inserite corpi estranei all'interno dell'unità.</li> <li>Assicuratevi che l'unità non entri in contatto con insetticidi, benzolo o solventi.</li> <li>Non smontate né modificate l'unità in alcun modo.</li> <li>Le aperture di ventilazione non devono essere ostruite coprendole con oggetti, quali giornali, tovaglie, tende e così via.</li> <li>Non posizionate sull'unità fiamme libere, come ad esempio candele accese.</li> <li>L'apparecchiatura non deve essere esposta a gocciolii o spruzzi.</li> <li>Non posizionate sull'unità alcun oggetto contenente liquidi, come ad esempio i vasi.</li> <li>Non toccare il cavo di alimentazione con le mani bagnate.</li> <li>Quando l'interruttore è nella posizione OFF, l'apparecchiatura non è completamente scollegata da MAINS.</li> <li>L'apparecchio va installato in prossimità della fonte di alimentazione, in modo che quest'ultima sia facilmente accessibile.</li> </ul>	<ul style="list-style-type: none"> <li>Maneje el cordón de energía con cuidado. Sostenga el enchufe cuando desconecte el cordón de energía.</li> <li>Mantenga el equipo libre de humedad, agua y polvo.</li> <li>Desconecte el cordón de energía cuando no utilice el equipo por mucho tiempo.</li> <li>No obstruya los orificios de ventilación.</li> <li>No deje objetos extraños dentro del equipo.</li> <li>No permita el contacto de insecticidas, gasolina y diluyentes con el equipo.</li> <li>Nunca desarme o modifique el equipo de ninguna manera.</li> <li>La ventilación no debe quedar obstruida por haberse cubierto las aperturas con objetos como periódicos, manteles o cortinas.</li> <li>No deberán colocarse sobre el aparato fuentes inflamables sin protección, como velas encendidas.</li> <li>No exponer el aparato al goteo o salpicaduras cuando se utilice.</li> <li>No colocar sobre el aparato objetos llenos de líquido, como jarros.</li> <li>No maneje el cable de alimentación con las manos mojadas.</li> <li>Cuando el interruptor está en la posición OFF, el equipo no está completamente desconectado de la alimentación MAINS.</li> <li>El equipo se instalará cerca de la fuente de alimentación de manera que resulte fácil acceder a ella.</li> </ul>	<ul style="list-style-type: none"> <li>Hanteer het netsnoer voorzichtig. Houd het snoer bij de stekker vast wanneer deze moet worden aan- of losgekoppeld.</li> <li>Laat geen vochtigheid, water of stof in het apparaat binnendringen.</li> <li>Neem altijd het netsnoer uit het stopcontact wanneer het apparaat gedurende een lange periode niet wordt gebruikt.</li> <li>De ventilatieopeningen mogen niet worden geblokkeerd.</li> <li>Laat geen vreemde voorwerpen in dit apparaat vallen.</li> <li>Voorkom dat insecticiden, benzene of verfverdunner met dit toestel in contact komen.</li> <li>Dit toestel mag niet gedemonteerd of aangepast worden.</li> <li>De ventilatie mag niet worden belemmerd door de ventilatieopeningen af te dekken met bijvoorbeeld kranten, een tafelkleed of gordijnen.</li> <li>Plaats geen open vlammen, bijvoorbeeld een brandende kaars, op het apparaat.</li> <li>Stel het apparaat niet bloot aan druppels of spatten.</li> <li>Plaats geen voorwerpen gevuld met water, bijvoorbeeld een vaas, op het apparaat.</li> <li>Raak het netsnoer niet met natte handen aan.</li> <li>Als de schakelaar op OFF staat, is het apparaat niet volledig losgekoppeld van de netspanning (MAINS).</li> <li>De apparatuur wordt in de buurt van het stopcontact geïnstalleerd, zodat dit altijd gemakkelijk toegankelijk is.</li> </ul>	<ul style="list-style-type: none"> <li>Hantera nätkabeln varsamt. Håll i kabeln när den kopplas från el-uttaget.</li> <li>Utsätt inte apparaten för fukt, vatten och damm.</li> <li>Koppla loss nätkabeln om apparaten inte kommer att användas i lång tid.</li> <li>Täpp inte till ventilationsöppningarna.</li> <li>Se till att främmande föremål inte tränger in i apparaten.</li> <li>Se till att inte insektsmedel på spraybruk, bensen och thinner kommer i kontakt med apparatens hölje.</li> <li>Ta inte isär apparaten och försök inte bygga om den.</li> <li>Ventilationen bör inte förhindras genom att täcka för ventilationsöppningarna med föremål såsom tidingar, bordsdukar eller gardiner.</li> <li>Placera inte öppen eld, t.ex. tända ljus, på apparaten.</li> <li>Apparaten får inte utsättas för vätska.</li> <li>Placera inte föremål fyllda med vätska, t.ex. vaser, på apparaten.</li> <li>Hantera inte nätsladden med våta händer.</li> <li>Även om strömbrytaren står i det avstängda läget OFF, så är utrustningen inte helt bortkopplad från det elektriska nätet (MAINS).</li> <li>Utrustningen ska vara installerad nära strömuttaget så att strömförsörjningen är lätt att tillgå.</li> </ul>

**•DECLARATION OF CONFORMITY****(English)**

We declare under our sole responsibility that this product, to which this declaration relates, is in conformity with the following standards:

EN60065, EN55013, EN55020, EN61000-3-2 and EN61000-3-3.

Following the provisions of Low Voltage Directive 2006/95/EC and EMC Directive 2004/108/EC, the EC regulation 1275/2008 and its frame work Directive 2009/125/EC for Energy-related Products (ErP).

**•ÜBEREINSTIMMUNGSERKLÄRUNG****(Deutsch)**

Wir erklären unter unserer Verantwortung, daß dieses Produkt, auf das sich diese Erklärung bezieht, den folgenden Standards entspricht:

EN60065, EN55013, EN55020, EN61000-3-2 und EN61000-3-3.

Gemäß den Bestimmungen der Niederspannungsrichtlinie 2006/95/EG und EMV Richtlinie 2004/108/EG, der Verordnung (EG) Nr. 1275/2008 der Kommission und deren Rahmenrichtlinie 2009/125/EG zu energieverbrauchsrelevanten Produkten (ErP).

**•DECLARATION DE CONFORMITE****(Français)**

Nous déclarons sous notre seule responsabilité que l'appareil, auquel se réfère cette déclaration, est conforme aux standards suivants:

EN60065, EN55013, EN55020, EN61000-3-2 et EN61000-3-3.

Selon la directive 2006/95/EC concernant la basse tension et la directive CEM 2004/108/EC, la réglementation européenne 1275/2008 et la directive 2009/125/EC établissant un cadre de travail applicable aux produits liés à l'énergie (ErP).

**•DICHIAZIONE DI CONFORMITÀ****(Italiano)**

Dichiariamo con piena responsabilità che questo prodotto, al quale la nostra dichiarazione si riferisce, è conforme alle seguenti normative:

EN60065, EN55013, EN55020, EN61000-3-2 e EN61000-3-3.

Facendo seguito alle disposizioni della direttiva sul basso voltaggio 2006/95/EC alla direttiva EMC 2004/108/EC, alla norma EC 1275/2008 e alla relativa legge quadro 2009/125/EC in materia di prodotti alimentati ad energia (ErP).

QUESTO PRODOTTO E' CONFORME

AL D.M. 28/08/95 N. 548

**•DECLARACIÓN DE CONFORMIDAD****(Español)**

Declaramos bajo nuestra exclusiva responsabilidad que este producto al que hace referencia esta declaración, está conforme con los siguientes estándares:

EN60065, EN55013, EN55020, EN61000-3-2 y EN61000-3-3.

De acuerdo con la directiva sobre baja tensión 2006/95/CE y la directiva sobre CEM 2004/108/CE, la normativa CE 1275/2008 y su directiva marco 2009/125/EC para productos relacionados con la energía (ErP).

**•EENVORMIGHEIDSVERKLARING****(Nederlands)**

Wij verklaren uitsluitend op onze verantwoordelijkheid dat dit product, waarop deze verklaring betrekking heeft, in overeenstemming is met de volgende normen:

EN60065, EN55013, EN55020, EN61000-3-2 en EN61000-3-3.

Volgens de voorzieningen van lage spanningsrichtlijn 2006/95/EC en EMC-richtlijn 2004/108/EC, de EU-richtlijn 1275/2008 en de kaderrichtlijn 2009/125/EC voor energieverbruikende producten (ErP).

**•ÖVERENSSTÄMMELSESINTYG****(Svenska)**

Härmed intygas helt på eget ansvar att denna produkt, vilken detta intyg avser, uppfyller följande standarder:

EN60065, EN55013, EN55020, EN61000-3-2 och EN61000-3-3.

Uppfyller reglerna i lågspänningsdirektivet 2006/95/EC och EMC-direktivet 2004/108/EC, EU-förordningen 1275/2008 och ramverksdirektivet 2009/125/EC för energirelaterade produkter (ErP).

**CAUTION:****(English)**

To completely disconnect this product from the mains, disconnect the plug from the wall socket outlet.

The mains plug is used to completely interrupt the power supply to the unit and must be within easy access by the user.

**VORSICHT:****(Deutsch)**

Um dieses Gerät vollständig von der Stromversorgung abzutrennen, trennen Sie bitte den Netzstecker von der Wandsteckdose ab.

Die Hauptstecker werden verwendet, um die Stromversorgung zum Gerät völlig zu unterbrechen; er muss für den Benutzer gut und einfach zu erreichen sein.

**PRECAUTION:****(Français)**

Pour déconnecter complètement ce produit du courant secteur, débranchez la prise de la prise murale.

La prise secteur est utilisée pour couper complètement l'alimentation de l'appareil et l'utilisateur doit pouvoir y accéder facilement.

**ATTENZIONE:****(Italiano)**

Per scollegare definitivamente questo prodotto dalla rete di alimentazione elettrica, togliere la spina dalla relativa presa.

La spina di rete viene utilizzata per interrompere completamente l'alimentazione all'unità e deve essere facilmente accessibile all'utente.

**PRECAUCIÓN:****(Español)**

Para desconectar completamente este producto de la alimentación eléctrica, desconecte el enchufe del enchufe de la pared.

El enchufe de la alimentación se utiliza para interrumpir por completo el suministro de alimentación a la unidad y debe de encontrarse en un lugar al que el usuario tenga fácil acceso.

**VOORZICHTIGHEID:****(Nederlands)**

Om de voeding van dit product volledig te onderbreken moet de stekker uit het stopcontact worden getrokken.

De netstekker wordt gebruikt om de stroomtoevoer naar het toestel volledig te onderbreken en moet voor de gebruiker gemakkelijk bereikbaar zijn.

**FÖRSIKTIGHETSÅTT:****(Svenska)**

Koppla loss stickproppen från eluttaget för att helt skilja produkten från nätet.

Stickproppen används för att helt bryta strömförsörjningen till apparaten, och den måste vara lättillgänglig för användaren.

**D&M Professional Europe**  
**A division of D&M Europe B.V.**  
**Beemdstraat 11**  
**5653 MA Eindhoven**  
**The Netherlands**

#### A NOTE ABOUT RECYCLING:

This product's packaging materials are recyclable and can be reused. Please dispose of any materials in accordance with the local recycling regulations. When discarding the unit, comply with local rules or regulations. Batteries should never be thrown away or incinerated but disposed of in accordance with the local regulations concerning battery disposal. This product and the supplied accessories, excluding the batteries, constitute the applicable product according to the WEEE directive.

#### HINWEIS ZUM RECYCLING:

Das Verpackungsmaterial dieses Produktes ist zum Recyceln geeignet und kann wieder verwendet werden. Bitte entsorgen Sie alle Materialien entsprechend der örtlichen Recycling-Vorschriften. Beachten Sie bei der Entsorgung des Gerätes die örtlichen Vorschriften und Bestimmungen. Die Batterien dürfen nicht in den Hausmüll geworfen oder verbrannt werden; bitte entsorgen Sie die Batterien gemäß der örtlichen Vorschriften. Dieses Produkt und das im Lieferumfang enthaltene Zubehör (mit Ausnahme der Batterien!) entsprechen der WEEE-Direktive.

#### UNE REMARQUE CONCERNANT LE RECYCLAGE:

Les matériaux d'emballage de ce produit sont recyclables et peuvent être réutilisés. Veuillez disposer des matériaux conformément aux lois sur le recyclage en vigueur. Lorsque vous mettez cet appareil au rebut, respectez les lois ou réglementations en vigueur. Les piles ne doivent jamais être jetées ou incinérées, mais mises au rebut conformément aux lois en vigueur sur la mise au rebut des piles. Ce produit et les accessoires inclus, à l'exception des piles, sont des produits conformes à la directive DEEE.

#### NOTA RELATIVA AL RICICLAGGIO:

I materiali di imballaggio di questo prodotto sono riutilizzabili e riciclabili. Smaltire i materiali conformemente alle normative locali sul riciclaggio. Per lo smaltimento dell'unità, osservare le normative o le leggi locali in vigore. Non gettare le batterie, né incenerirle, ma smaltirle conformemente alla normativa locale sui rifiuti chimici. Questo prodotto e gli accessori inclusi nell'imballaggio sono applicabili alla direttiva RAEE, ad eccezione delle batterie.

#### ACERCA DEL RECICLAJE:

Los materiales de embalaje de este producto son reciclables y se pueden volver a utilizar. Disponga de estos materiales siguiendo los reglamentos de reciclaje de su localidad. Cuando se deshaga de la unidad, cumpla con las reglas o reglamentos locales. Las pilas nunca deberán tirarse ni incinerarse. Deberá disponer de ellas siguiendo los reglamentos de su localidad relacionados con los desperdicios químicos. Este producto junto con los accesorios empaquetados es el producto aplicable a la directiva RAEE excepto pilas.

#### EEN AANTEKENING MET BETREKKING TOT DE RECYCLING:

Het inpakmateriaal van dit product is recycleerbaar en kan opnieuw gebruikt worden. Er wordt verzocht om zich van elk afvalmateriaal te ontdoen volgens de plaatselijke voorschriften. Volg voor het wegdoen van de speler de voorschriften voor de verwijdering van wit- en bruingoed op. Batterijen mogen nooit worden weggegooid of verbrand, maar moeten volgens de plaatselijke voorschriften betreffende chemisch afval worden verwijderd. Op dit product en de meegeleverde accessoires, m.u.v. de batterijen is de richtlijn voor afgedankte elektrische en elektronische apparaten (WEEE) van toepassing.

#### OBSERVERA ANGÅENDE ÅTERVINNING:

Produktens emballage är återvinningsbart och kan återanvändas. Kassera det enligt lokala återvinningsbestämmelser. När du kasserar enheten ska du göra det i överensstämmelse med lokala regler och bestämmelser. Batterier får absolut inte kastas i soporna eller brännas. Kassera dem enligt lokala bestämmelser för kemiskt avfall. Denna apparat och de tillbehör som levereras med den uppfyller gällande WEEE-direktiv, med undantag av batterierna.



Pb

#### Rating label LOCATION: BOTTOM

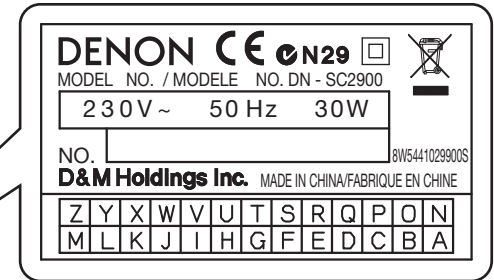
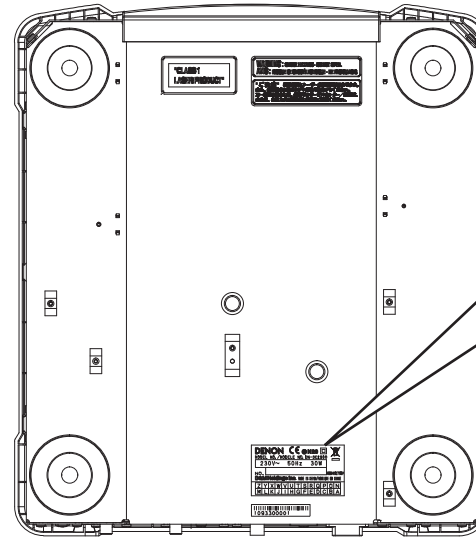

European, U.K. and Asia/Pacific models:

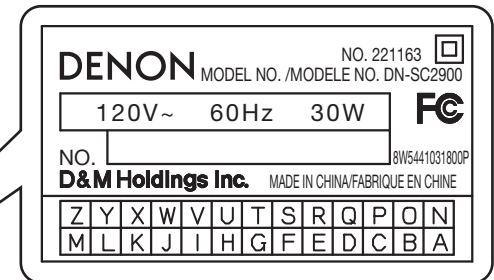
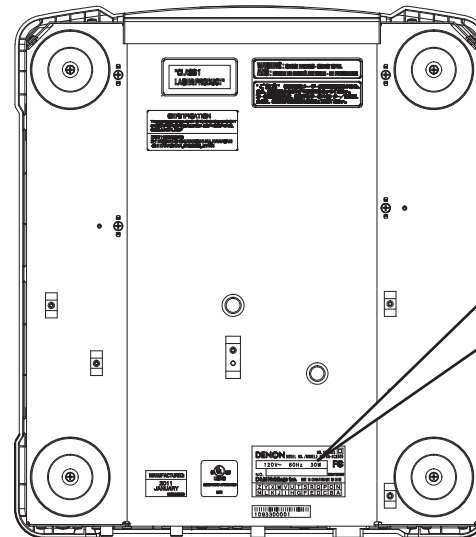

U.S.A. and Canada models:

# Getting started

## Contents

<b>Getting started</b> .....	1
<b>Accessories</b> .....	2
<b>About this manual</b> .....	2
<b>Main features</b> .....	3
<b>Cautions on handling</b> .....	3
<b>Discs</b> .....	4
Discs playable on this unit.....	4
Holding discs.....	4
Loading discs.....	4
Cautions on loading discs.....	4
Cautions on storing discs.....	4
Cleaning discs.....	4
<b>Supported media and files</b> .....	4
Supported media.....	4
Playable files.....	4
<b>Part names and functions</b> .....	5
<b>Top panel</b> .....	5
① Audio input/output part.....	5
② TRAKTOR LE 2/PRO 2.....	7
<b>Display</b> .....	9
① Audio input/output part.....	9
② TRAKTOR LE 2/PRO 2.....	10
<b>Front panel</b> .....	11
<b>Rear panel</b> .....	11
<b>Preparations</b> .....	12
<b>About the supplied software</b> .....	12
Installing the ASIO driver (Windows only).....	12
Starting up the ASIO driver.....	14
Installing TRAKTOR LE 2.....	15
Automatic driver installation.....	16
Installing music management software “engine”.....	16
Obtaining the “engine for iPad” music management application.....	16
<b>Connection</b> .....	17
<b>Cables used for connection</b> .....	17
<b>Basic connections</b> .....	17
<b>Network connecting</b> .....	18
<b>MIDI control connections</b> .....	19
<b>Connecting the power cord</b> .....	19
<b>Playback</b> .....	20
<b>Turning the power on</b> .....	20
<b>Turning the power off</b> .....	20
<b>Preparation for playback</b> .....	20
Preparing for CD playback.....	20
Preparing for CD-ROM/CD-R/CD-RW playback.....	21
Preparing for USB memory device or HDD playback.....	22
Preparing for playback from a network connected device.....	23
<b>Searching tracks</b> .....	24
Searching tracks by category.....	24
Searching tracks by crate.....	25
Searching tracks by playlist.....	25
<b>Operations during playback</b> .....	26
Setting playback mode.....	26
Playback.....	26
Pause.....	26
Fast forward/Rewind.....	26
Setting the cue point.....	27
Adjusting the playback speed.....	28
Adjusting the playback speed without changing the pitch.....	28
Changing the playback speed temporarily (pitch bend function).....	28
Power on playback.....	28
Manual loop playback.....	29
Auto loop playback.....	30
Hot cue playback.....	30
Hot list.....	31
Auto BPM counter.....	31
Scratch playback.....	31
Adjusting the rotation torque of the jog wheel.....	32
Adjusting the touch sensor sensitivity of the Jog wheel (Touch Adjust).....	32
Reverse playback.....	32
SLIP function.....	32
Adjusting the track startup/end time.....	33
<b>Network playback operations</b> .....	33
Sharing tracks on the network.....	33
Relay playback.....	34
Automatically adjusting BPM.....	34
Sharing hot list information.....	35
Sharing memo data.....	35
<b>MIDI control operation</b> .....	35
<b>Basic operations</b> .....	35
<b>Switching between MIDI layers 1/2</b> .....	35
<b>Switching MIDI channels</b> .....	35
<b>MIDI command list</b> .....	36
Send command.....	36
Reception commands.....	37
<b>Others</b> .....	40
<b>Memo function</b> .....	40
Media that can be used with the memo function.....	40
Memo settings.....	41
<b>Preset recall function</b> .....	42
<b>How to make detailed settings</b> .....	43
<b>Utility menu map</b> .....	43
<b>Utility settings</b> .....	44
Save As Def.....	44
Preset Setting.....	44
Preset I/O.....	46
Memo Area.....	46
Initialize.....	46
Information.....	46
<b>Troubleshooting</b> .....	47
<b>Specifications</b> .....	48
<b>Index</b> .....	49

## Accessories

Check that the following parts are supplied with the product.

- ① Owner's Manual ..... 1
- ② Quick setup guide ..... 1
- ③ DN-SC2900 Resource disc ..... 1  
(Contents)
  - Owner's manual (This manual)
  - Quick setup guide
  - "engine" Instruction manual
  - Music management software "engine"
  - ASIO driver
  - AUDIO/MIDI setup guide for MAC OS X
- ④ DJ software (TRAKTOR LE 2) disc ..... 1
- ⑤ Power cord (For use with this unit only) ..... 1
- ⑥ RCA cable ..... 1
- ⑦ USB cable ..... 1
- ⑧ Warranty (for North America model only) ..... 1

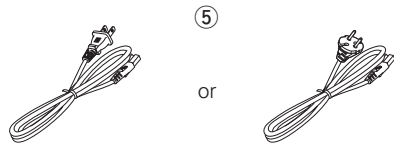

U.S.A and Canada models

European, U.K and Asia/  
Pacific models

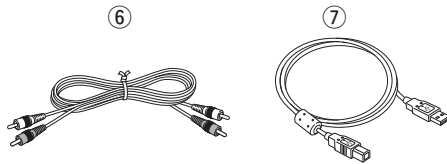

## About this manual

### □ Symbols



This symbol indicates a reference page on which related information is described.



This symbol indicates items described in the "engine Instruction manual" on the provided disc.



This symbol indicates a supplementary information and tips for operations.

**NOTE**

This symbol indicates points to remember operations or function limitations.

### □ Illustrations

Note that the illustrations in these instructions are for explanation purposes and may differ from the actual unit.



## Main features

### 1. Supplied with “engine”, new music management software presented by DENON DJ (📖🔍engine Instruction manual)

- Creates a database, and enables high-speed multifunctional searching and efficient music file list management.
- Equipped with an automatic generation function that generates BPM, beat points and waveform information, and editing function for editing cue and loop points.
- Equipped with the PC-Link function that enables playback of tracks managed by “engine” on a computer and searching of tracks stored on a USB memory device or HDD connected to this unit using “engine”.

### 2. Network Media Player equipped with advanced functions

- Tracks can be shared when two or more DN-SC2900 are connected on the same network. (Maximum four DN-SC2900)
- By connecting an iPad to this unit using Wi-Fi and using the “engine for iPad” music management application, you can use the iPad touch screen to search tracks and display the status (📖page 16).
- CD, USB memory device or HDD tracks can be played, even when using MIDI DJ software. This enables continued performance without audio cutout even when restarting the computer or changing DJs.

### 3. Built-in USB MIDI Control Function

- Equipped with a physical controller function that enables control of the DJ software from this unit as well as the computer.

### 4. Supports CD-DA playback, CD-ROM (AAC, AIFF, MP3, WAV) playback, and audio playback from USB memory device and external HDDs (mass-storage class)

### 5. Built-in USB audio interface

- High sound quality design that supports sampling frequency of 44.1 kHz.
- Supplied with ASIO driver for low latency (📖page 12).

### 6. Equipped with a large, high-resolution jog wheel with a touch sensor function

### 7. Equipped with FL display and waveform display function

- Highly informative display provides three lines of character information.
- Track waveform data\* is displayed.
- The 32-position marker point indicator follows your hand movements quickly and accurately.

\* To display waveform data, use the provided “engine” music management software (📖🔍engine Instruction manual).

### 8. Equipped with Burr Brown 24 bit DAC processing for faithful playback and superior audio fidelity.

## Cautions on handling

### • Before turning the power switch on

Check once again that all connections are correct and that there are no problems with the connection cables.

- Power is supplied to some of the circuitry even when the unit is set to the standby mode. When going on vacation or leaving home for long periods of time, be sure to unplug the power cord from the power outlet.

### • Proper ventilation

- If the unit is left in a room full of the smoke from cigarettes, etc., for long periods of time, the surface of the optical pickup may get dirty, preventing it from receiving the signals properly.
- Place in a stable, flat location.

### • About condensation

If there is a major difference in temperature between the inside of the unit and the surroundings, condensation (dew) may form on the operating parts inside the unit, causing the unit not to operate properly.

If this happens, let the unit sit for an hour or two with the power turned off and wait until there is little difference in temperature before using the unit.

### • Cautions on using mobile phones

Using a mobile phone near this unit may result in noise. If that occurs, move the mobile phone away from this unit when it is in use.

### • Moving the unit

- Turn off the power and unplug the power cord from the power outlet. Next, disconnect the connection cables to other system units before moving the unit.
- When carrying this unit with a platter installed, make sure that the platter does not fall.
- When transporting this unit, remove the jog wheel and platter, and package them separately for transportation.

### • About care

- Wipe the cabinet and control panel clean with a soft cloth.
- Follow the instructions when using a chemical cleaner.
- Benzene, paint thinner or other organic solvents as well as insecticide may cause material changes and discoloration if brought into contact with the unit, and should therefore not be used.

## Discs

### Discs playable on this unit

#### 1 Music CDs

Discs marked with the logo at right can be played in this unit.



#### 2 CD-R/CD-RW

##### NOTE

- Discs in special shapes (heartshaped discs, octagonal discs, etc.) cannot be played. Do not attempt to play them, as doing so can damage the unit.
- Some discs and some recording formats cannot be played.
- Non-finalized discs cannot be played.



#### \* What is finalization?

Finalization is the process that makes recorded CD-R/CD-RW discs playable on compatible players.

### Holding discs



Do not touch the signal surface.

### Loading discs

- Only load one disc at a time. Loading two or more discs can damage the unit or scratch the discs.
- When the disc is drawn into the unit, be careful not to trap your fingers.
- Do not insert anything other than discs into the disc loading slot.
- Do not use cracked or warped discs or discs that have been repaired with adhesive, etc.
- Do not use discs on which the sticky part of cellophane tape or labels is exposed or on which there are traces of where labels have been removed. Such discs can get caught inside the player and damage it.
- If the label side of the disc is dirty, wipe it clean before use. If the disc loading/ejection roller becomes dirty, discs may not load or eject correctly.

### Cautions on loading discs

- Do not get fingerprints, oil or dirt on discs.
- Take special care not to scratch discs when removing them from their cases.
- Do not bend or heat discs.
- Do not enlarge the hole in the center.
- Do not write on the labeled (printed) surface with ball-point pens, pencils, etc., or stick new labels on discs.
- Water droplets may form on discs if they are moved suddenly from a cold place (outdoors for example) to a warm place, but do not try to dry them off using a hair-dryer, etc.

### Cautions on storing discs

- Be sure to remove discs after using them.
- Be sure to store discs in their cases to protect them from dust, scratches, warping, etc.
- Do not store discs in the following places:
  - Places exposed to direct sunlight for long periods of time
  - Dusty or humid places
  - Places exposed to heat from heaters, etc.

### Cleaning discs

- If there are fingerprints or dirt on a disc, wipe them off before using the disc. Fingerprints and dirt can impair sound quality and cause interruptions in playback.
- Use a commercially available disc cleaning set or a soft cloth to clean discs.

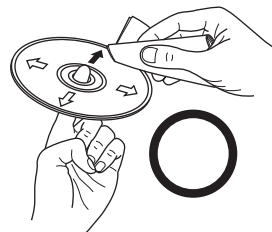

Gently wipe the disc from the inside towards the outside.

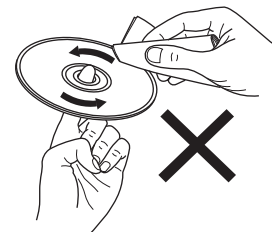

Do not wipe in a circular motion.

##### NOTE

Do not use record spray, antistatic agents, benzene, thinner or other solvents.

## Supported media and files

The following media and files can be played back on this unit.

### Supported media

#### Disc

Disc type : CD, CD-R, CD-RW, CD-ROM  
Format : CD-DA (CD-TEXT compatible),  
CD-ROM (ISO9660/Joliet format)

#### USB memory device

Media type : FLASH, HDD  
Format : FAT16/FAT32, HFS+ (Read only)

##### NOTE

- When a multisession disc is used, the more sessions there are, the more time will be required to read the disc.
- When HFS+ is used, this unit may not be able to recognize the file name if characters other than ISO8859-1 registered characters or character codes other than Japanese are used.

### Playable files

File formats	Extension	Details
MP3	.mp3	CBR/VBR 44.1kHz Stereo
AAC	.m4a .aac	CBR/VBR 44.1kHz Stereo
WAV	.wav	44.1kHz 16/24bit Stereo
AIFF	.aif .aiff	44.1kHz 16/24bit Stereo

##### NOTE

DRM protected files cannot be played back.

# Part names and functions

## Top panel

### ① Audio input/output part

This section describes the top panel in the following sections: ① Audio input/output part and ② TRAKTOR LE 2/PRO 2. Read descriptions for your DJ software. For buttons not explained here, see the page indicated in parentheses ( ).

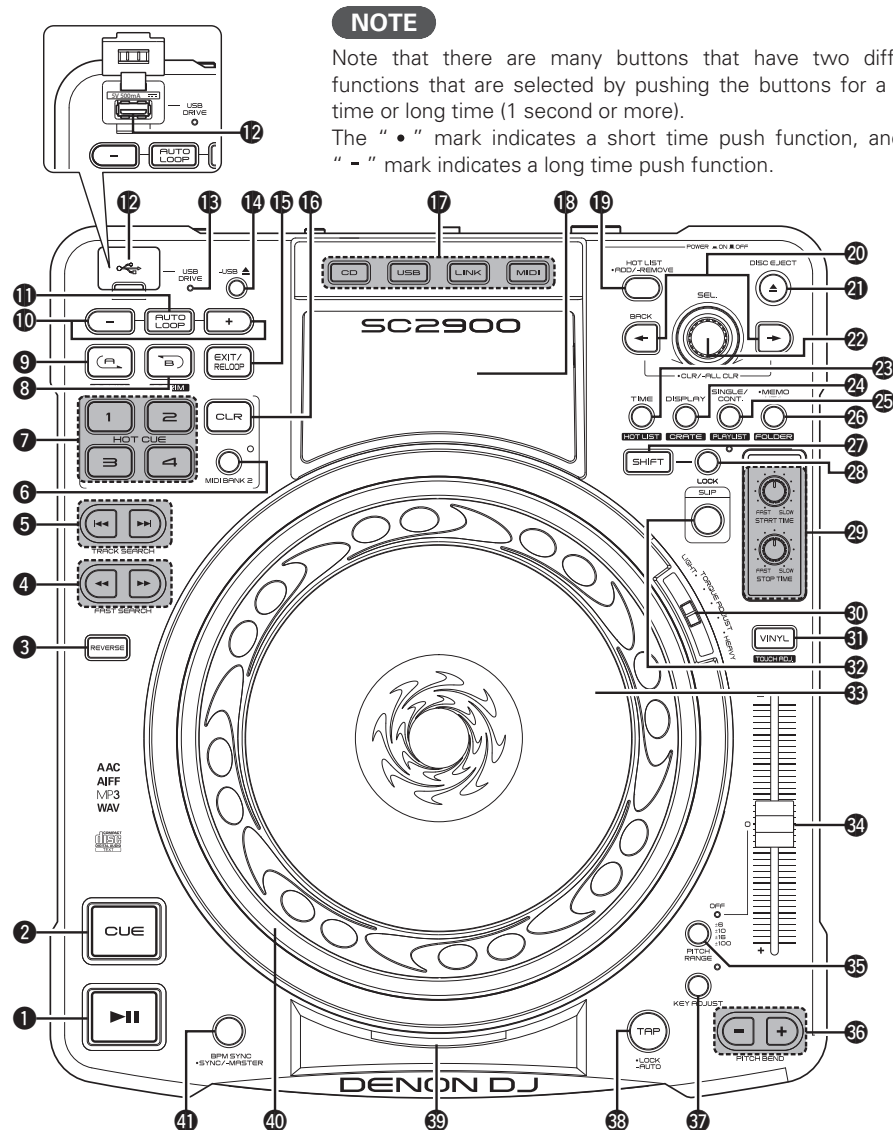

- ① **Play/Pause button (▶||)** ..... (26)
- ② **CUE button** ..... (27)
- ③ **REVERSE button** ..... (32)
- ④ **FAST SEARCH buttons (◀◀, ▶▶)** ..... (26)
- ⑤ **TRACK SEARCH buttons (|◀◀, ▶▶|)**
  - |◀◀ : When this button is pressed, playback is paused at the start of the previous track.
  - ▶▶| : When this button is pressed, playback is paused at the start of the next track.
- ⑥ **MIDI BANK 2 button** ..... (35)
- ⑦ **HOT CUE buttons (1/2/3/4)** ..... (30)
- ⑧ **B button (B TRIM)** ..... (29)
- ⑨ **A button (A TRIM)** ..... (29)
- ⑩ **AUTO LOOP +/- buttons** ..... (30)
- ⑪ **AUTO LOOP button** ..... (30)
- ⑫ **USB port**  
Insert a USB memory device or connect a HDD.
- ⑬ **USB DRIVE indicator** ..... (22)
- ⑭ **USB eject button (- USB ▲)** ..... (23)
- ⑮ **EXIT/RELOOP button** ..... (29)
- ⑯ **Clear button (CLR)** ..... (30)
- ⑰ **Source select buttons (CD/USB/LINK/MIDI)** ..... (20 - 23, 35)
- ⑱ **Display** ..... (9)
- ⑲ **Hot List Add/Remove button (HOT LIST • ADD/ - REMOVE)** ..... (31)
- ⑳ **BACK button (←)** ..... (21, 24, 25, 44)
- Forward button (→)** ..... (24)
- **CLR/ - ALL CLR button** ..... (25, 30)
- **BACK** : Returns to the previous layer or previous setting of the selected mode.
- ← → : Switches the active panel within “engine”. When the remaining track time is below the set time, left and right selector knob indicators flash alternately.
- ㉑ **DISC EJECT button (DISC EJECT▲)** ..... (21)
- ㉒ **Selector knob (SEL.)**
  - Turn this knob to select modes or setting values.
  - Press this knob to choose the selected item.
  - When searching for tracks on a music CD, turn this knob while pressing it to select tracks in 10-track units.
  - When searching for tracks from the database, turn this knob while pressing it to jump to the items that start with the specified first letter.
- ㉓ **TIME button** ..... (9)
- HOT LIST button** ..... (31)
- ㉔ **DISPLAY/CRATE button**
  - **DISPLAY** : When this button is pressed, the display switches between the performance screen and search screen, and the tag information of the currently playing song is displayed.
  - **CRATE** : When this button is pressed while ㉔ **SHIFT** is held down, the “engine” crate is displayed.

**NOTE**

Note that there are many buttons that have two different functions that are selected by pushing the buttons for a short time or long time (1 second or more). The “•” mark indicates a short time push function, and the “-” mark indicates a long time push function.

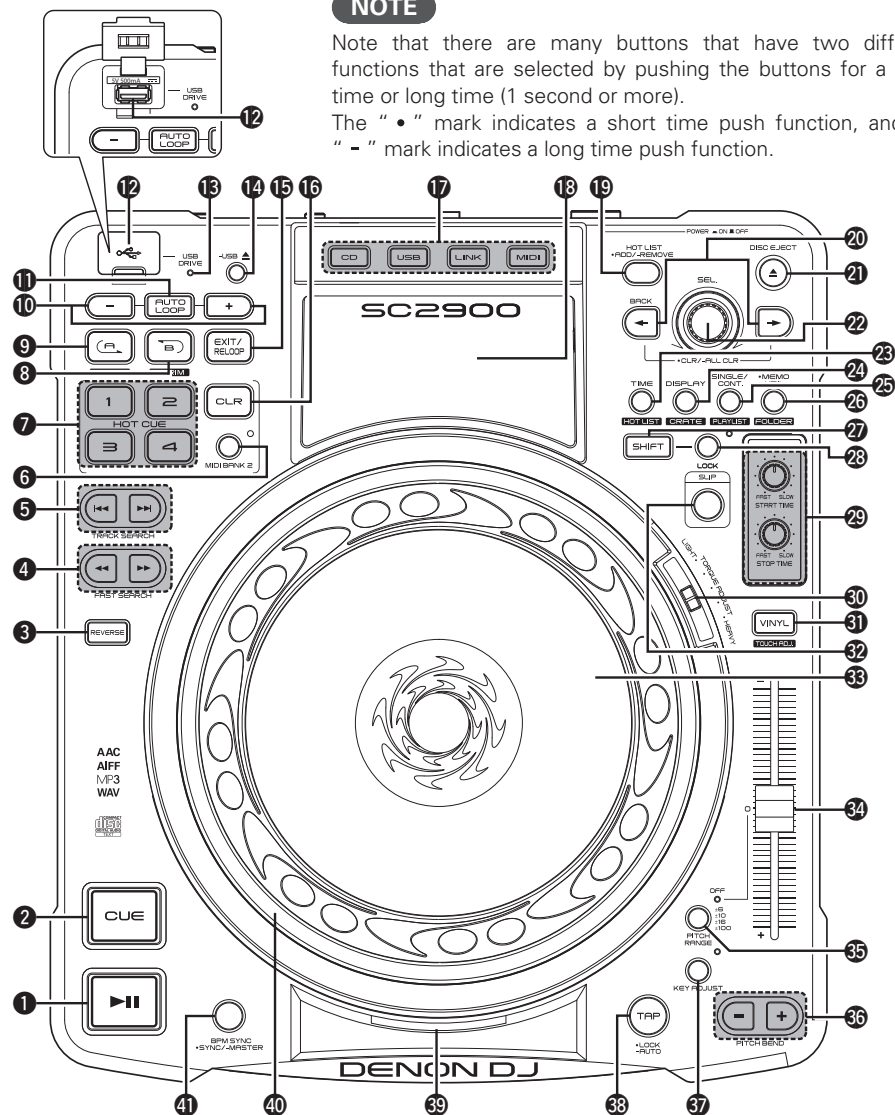

- 25 **SINGLE/CONT. button** ..... (26)  
**PLAYLIST button**  
  - **PLAYLIST** : When this button is pressed while 27 SHIFT is held down, the “engine” playlist is displayed.
- 26 **Memo/Utility button**  
 ( • MEMO/ - UTIL.) ..... (41, 44)  
**FOLDER button**  
  - **FOLDER** : When this button is pressed while 27 SHIFT is held down, the folders in the USB memory device, HDD or “engine” are displayed.
- 27 **SHIFT button**  
 When 3 B TRIM, 9 A TRIM, 23 HOT LIST, 24 CRATE, 25 PLAYLIST, 26 FOLDER or 31 TOUCH ADJ. are pressed while holding down this button, the mode switches to the assigned button mode.
- 28 **Shift lock button (LOCK)**  
 When this button is pressed, the shift function locks, and the shift function can be used without pressing 27 SHIFT. Press the button again to release the lock.
- 29 **START TIME knob,**  
**STOP TIME knob** ..... (33)
- 30 **TORQUE ADJUST switch**  
**(LIGHT/HEAVY)** ..... (32)  
 The rotation torque of the jog wheel can be adjusted to one of 5 levels by sliding this switch. Slide toward the “LIGHT” direction to reduce rotation torque and the “HEAVY” direction to increase rotation torque.
- 31 **VINYL button, Touch adjust button**  
**(TOUCH ADJ.)** ..... (27, 28, 31, 32)
- 32 **SLIP button** ..... (32)
- 33 **Jog wheel** ..... (27)
- 34 **Pitch slider** ..... (28)
- 35 **PITCH RANGE button** ..... (28)
- 36 **PITCH BEND button (+/-)** ..... (28)
- 37 **KEY ADJUST button** ..... (28)
- 38 **TAP • LOCK/ - AUTO button** ..... (31)
- 39 **Touch sensor indicator**  
 Lights red when the unit detects that the top of the jog wheel has been touched.
- 40 **Jog wheel indicator** ..... (27, 45)  
 The playback point lights red, and the cue point lights purple.  
 However, you can change the color settings. For details, see “Utility” – “Preset Setting” – “Jog Ind. Color”.
- 41 **BPM • SYNC/ - MASTER button**  
 ..... (34)

## 2 TRAKTOR LE 2/PRO 2

### NOTE

Note that there are many buttons that have two different functions that are selected by pushing the buttons for a short time or long time (1 second or more). The "•" mark indicates a short time push function, and the "-" mark indicates a long time push function.

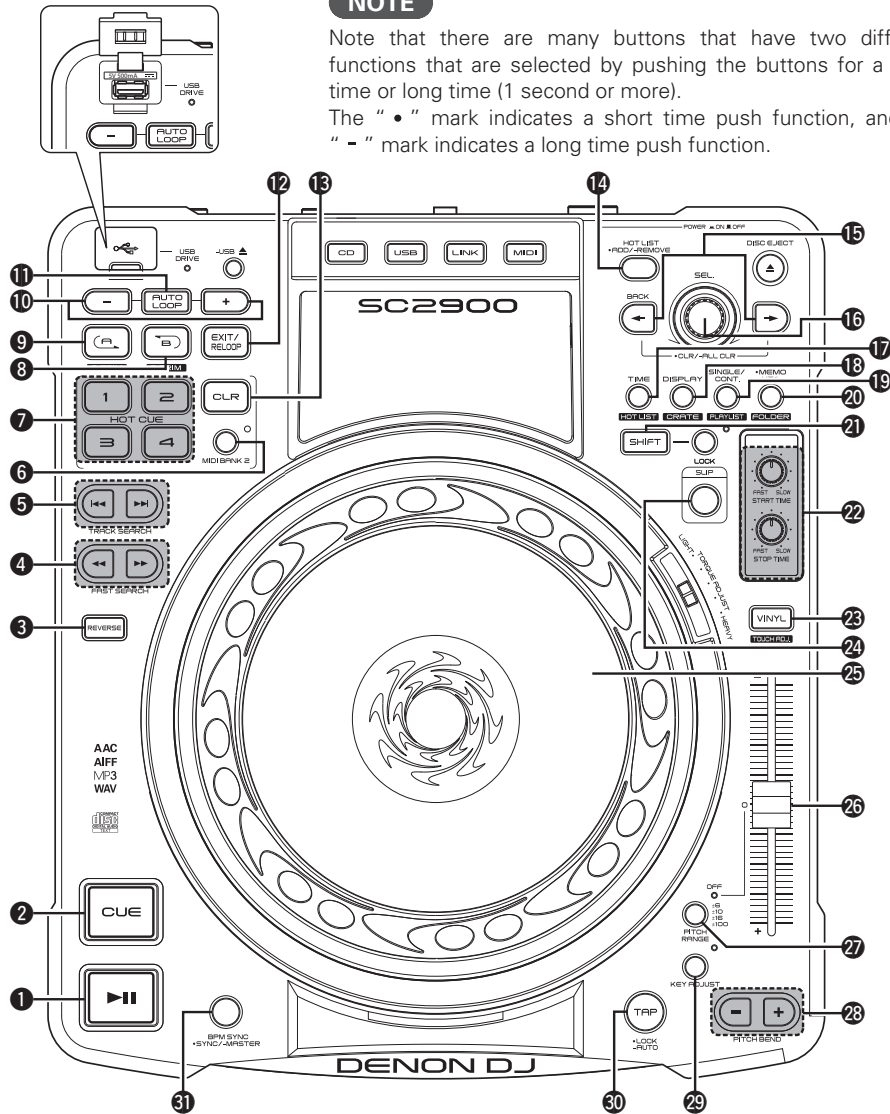

### 1 Play/Pause button (▶||)

Plays back when pressed while playback is stopped. Pauses playback when pressed during playback.

### 2 CUE button

Sets the cue point and stutters the cue point when pushed repeatedly.

- Hold down **21 SHIFT** and press this button to jump to the start of the deck.

### 3 REVERSE button

Shift modifier for sample slots.

### 4 FAST SEARCH buttons (◀◀, ▶▶)

Fast forward/rewind.

### 5 TRACK SEARCH buttons (|◀◀, ▶▶|)

Loads the file selected using **16 SEL.** to either DECK A or DECK B.

### 6 MIDI BANK 2 button

The button switches CUE1-4/SAMPLE SLOT1-4.

- When SAMPLE SLOT1-4 is selected, the display lights up.

### 7 HOT CUE buttons (1/2/3/4)

**6 MIDI BANK 2** turn ON/OFF to select CUE1-4/SAMPLE SLOT1-4. (This function is enabled when the upgraded version TRAKTOR PRO 2 (sold separately) is used.)

- ON:
- Press this button to playback the sample.
  - Hold down **21 SHIFT** and press this button to playback the sample slot trigger.
  - Hold down **13 CLR** and press this button to switch mute for the sample slot ON or OFF.
  - Press and hold **21 SHIFT** and **13 CLR** together and press this button to clear the sample slot.
  - Hold down **3 REVERSE** and press this button to load the file selected in the browser to the sample slot.
- OFF: Up to 4 cue points can be set.

### 8 B button (B TRIM)

Sets the loop out point.

### 9 A button (A TRIM)

Sets the loop in point.

### 10 AUTO LOOP +/- buttons

Adjust the loop size.

- Hold down **21 SHIFT** and press this button to move the loop position left or right.

### 11 AUTO LOOP button

Switches auto loop ON/OFF.

### 12 EXIT/RELOOP button

Shift modifier for loading track deck to sample slots.

### 13 CLR button

### 14 Hot List Add/Remove button (HOT LIST • ADD/ - REMOVE)

Expands or Shrinks the browser window.

- Hold down **21 SHIFT** and press this button to append title to preparation.

### 15 BACK button (←)

Forward button (→)

### • CLR/ - ALL CLR button

Switch the displayed FAVORITES windows.

### 16 Selector knob (SEL.)

Turn the knob to scroll through the browser list, and press the knob to select a file. Turn the track selection knob: Scrolls through the browser list.

- Hold down **21 SHIFT** and turn to scroll through the browser tree.

Press the track selection knob:

- Hold down **21 SHIFT** and press this button to open or close the directories/folders in the browser tree.

### 17 TIME/HOT LIST button

Shift modifier for sample slot 1.

### 18 DISPLAY/CRATE button

Shift modifier for sample slot 2.

**NOTE**

Note that there are many buttons that have two different functions that are selected by pushing the buttons for a short time or long time (1 second or more). The “•” mark indicates a short time push function, and the “-” mark indicates a long time push function.

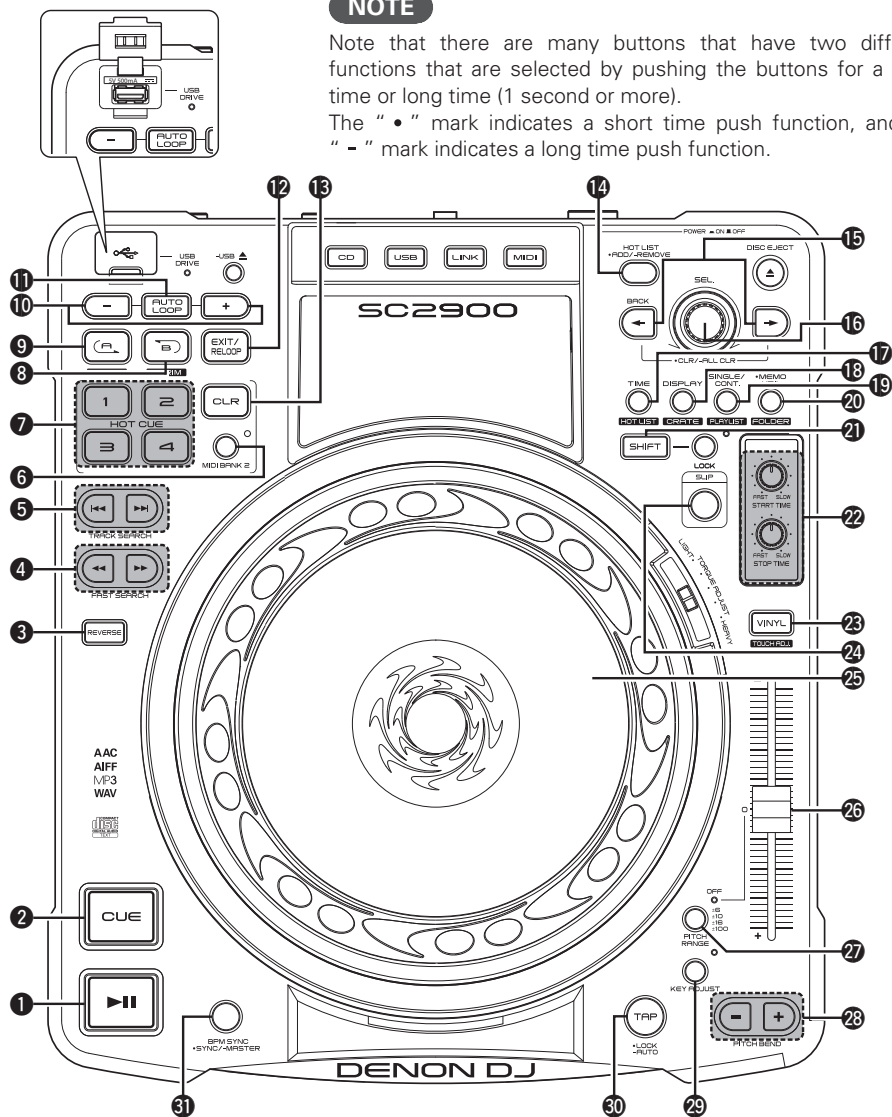

**19 SINGLE/CONT. /PLAYLIST button**

Shift modifier for sample slot 3.

**20 Memo/Utility ( • MEMO/ - UTIL.)/ FOLDER button**

Shift modifier for sample slot 4.

**21 SHIFT button**

**22 START TIME knob:**

Adjust the cut off frequency of the sample slot.

**STOP TIME knob:**

Adjust the volume of the sample slot.

**23 VINYL button**

ON: Switches to VINYL mode.

- The touch sensor is enabled when in VINYL mode.

OFF: Switches to BEND mode.

- The touch sensor is disabled when in BEND mode.

**24 SLIP button**

Switches the sample filter ON/OFF.

- Hold down **17 TIME** and press this button to switch the sample slot 1 filter ON/OFF.

- Hold down **18 DISPLAY** and press this button to switch the sample slot 2 filter ON/OFF.

- Hold down **19 SINGLE/CONT.** and press this button to switch the sample slot 3 filter ON/OFF.

- Hold down **20 MEMO-UTIL.** and press this button to switch the sample slot4 filter ON/OFF.

**25 Jog wheel**

Performs the search operation or bend operation.

- Hold down **21 SHIFT** and turn to scroll through the list.

**26 Pitch slider**

Adjusts the playback pitch.

- Move the knob toward the “-” direction to slow down the pitch and the “+” direction to speed up the pitch.

**27 PITCH RANGE button**

Switches pitch range.

**28 PITCH BEND button (+/-)**

Adjust the pitch temporarily.

**29 KEY ADJUST button**

With this ON, the key does not change even if you adjust the tempo during playback.

**30 TAP • LOCK/ - AUTO button**

**31 BPM • SYNC/ - MASTER button**

Performs auto beat matching.

- Hold **21 SHIFT** and press this button to set the currently selected deck to the beat sync master deck.

# Display

## ① Audio input/output part

This section describes the display in the following sections: ① Audio input/output part and ② TRAKTOR LE 2/PRO 2. Read descriptions for your DJ software.

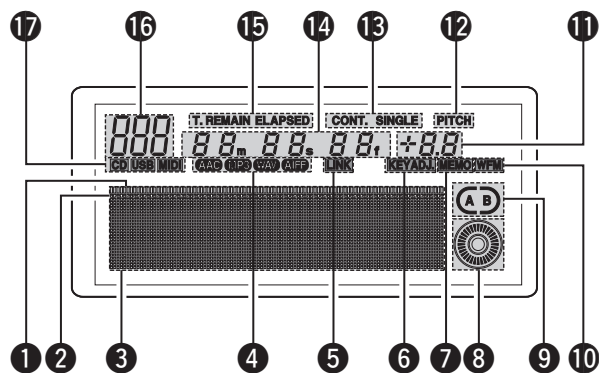

### ① Play position indicator

The track playback time is displayed. The normal playback time is displayed in blue, and the reverse playback time is highlighted. When the remaining playback time is below the set time, the playback position indicator flashes.

### ② Point indicators

Indicates the where the cue point, hot cue or auto loop point is in the playback position.

### ③ Character and Waveform display section

Displays characters in the lower section of the waveform display. In the character display, information such as the operation, mode name and data is displayed. The item name selected in the setting operation is highlighted.

### ④ File data indicators

Format of the file being played back is displayed.

### ⑤ LINK Connection confirmation indicator

Lights when a track on the device connected to LINK is being played back.

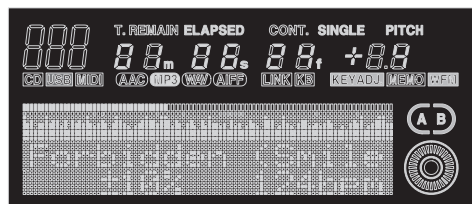

Waveforms are not displayed when there is no waveform data.

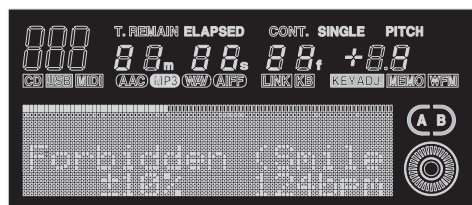

### ⑥ KEY ADJ. indicator

Lights when key adjustment mode is used.

### ⑦ MEMO indicator

This indicates whether or not there is memo data.

- Lights when memo data is stored in the file or track that is playing back or in standby.
- When connected by LINK in CD mode, this lights when memo data is stored in the USB memory device of the connected device.

### ⑧ Scratch marker

Playback position is displayed.

### ⑨ Loop mode indicators

This unit has two types of loop mode indicators, A and B.

The respective A and B indicators are displayed when A or B are set.

The two arrows indicate the loop mode as shown below.

- When both of flash: Manual loop playback
- When the right side of flashes: Manual loop paused (during exit)

### ⑩ WFM indicator

This lights when waveform data exists in the track being played back or CD track.

### ⑪ PITCH display

This indicator displays the playback speed (pitch).

### ⑫ PITCH mode indicator

This indicates the pitch in the PITCH display.

### ⑬ Play mode indicators

- **CONT.** : Lights when in continuous playback mode.
- **SINGLE** : Lights when in single playback mode or single playback (play lock) mode.

### ⑭ Minute, second and frame displays

This displays times such as the elapsed time or remaining time for files or tracks.

### ⑮ Time mode indicators

Each time **TIME** is pressed, the indicator switches as shown below.

- **ELAPSED** : Elapsed time of the track or file is displayed.
- **REMAIN** : Remaining time of the track or file is displayed.
- **T.ELAPSED** : When in CD mode, the elapsed time from the first file of the CD is displayed.
- **T.REMAIN** : When in CD mode, the remaining time of all tracks in the CD is displayed.

### ⑯ Track indicator

When in playlist mode playback or CD mode playback, the number of the track currently being played is displayed. When in the USB mode or LINK mode, "Network ID" is displayed.

### ⑰ SOURCE displays

The source currently being played back is displayed.

## ② TRAKTOR LE 2/PRO 2

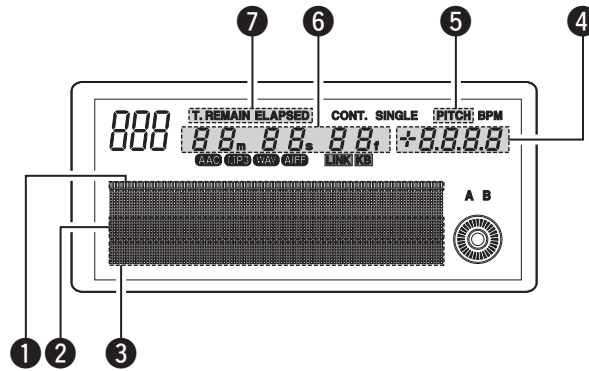

### ① Play position indicator

The track playback time is displayed. The normal playback time is displayed in blue, and the reverse playback time is highlighted. When the remaining playback time is below the set time, the playback position indicator flashes.

### ② Track name (Scrolled)

### ③ Artist name (Scrolled)

### ④ PITCH display

This indicator displays the playback speed (pitch).

### ⑤ PITCH mode indicator

This indicates the pitch in the PITCH display.

### ⑥ Minute, second and frame displays

This displays times such as the elapsed time or remaining time for files or tracks.

### ⑦ Time mode indicators

Each time **TIME** is pressed, the indicator switches as shown below.

- **ELAPSED** : Elapsed time of the track or file is displayed.
- **REMAIN** : Remaining time of the track or file is displayed.
- **T.ELAPSED** : When in CD mode, the elapsed time from the first file of the CD is displayed.
- **T.REMAIN** : When in CD mode, the remaining time of all tracks in the CD is displayed.



## Front panel

For buttons not explained here, see the page indicated in parentheses ( ).

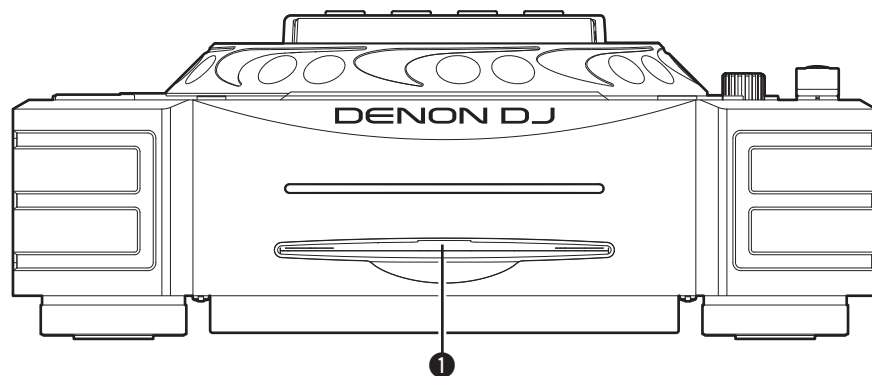

- 1 Disc loading slot** ..... (20)  
 Insert discs here. Insert the disc slowly with the label side facing upwards. Release the disc as soon as you feel the unit pull in the disc.

## Rear panel

For buttons not explained here, see the page indicated in parentheses ( ).

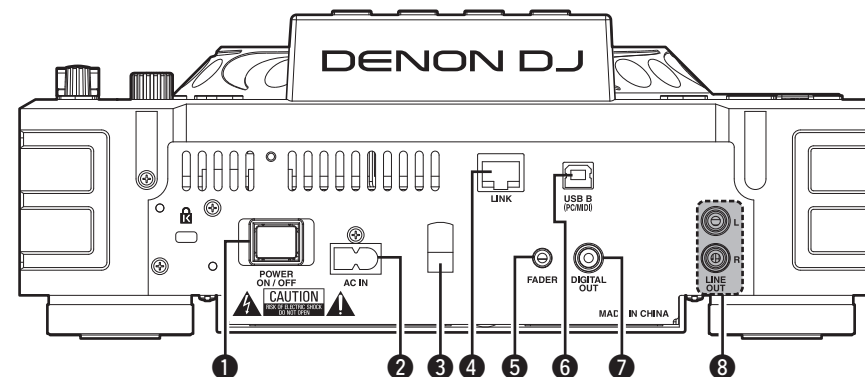

- 1 Power switch (POWER ON/OFF)** ..... (20)  
**2 AC inlet (AC IN)** ..... (19)  
**3 AC cord holder** ..... (19)  
 This holder prevents the AC cord plug from being pulled out. Use a screwdriver to fix the AC cord to the holder.  
**4 Network terminal (LINK)** ..... (17, 18)  
 Terminal for connecting to other devices via the network. Connect this unit and the computer to the same network in order to use "engine". A maximum of 4 DN-SC2900 units can be connected via the network to 1 computer.  
**5 FADER jack** ..... (17, 18)  
 Terminal for connecting to a DJ mixer, and receiving various control signals (playback, pause, cue etc) for controlling this device from the mixer.  
**6 USB B port (USB B (PC/MIDI))** ..... (19)  
 Terminal for USB connections. Use to connect this device to a computer for controlling DJ software.  
**7 Digital output terminal (DIGITAL OUT)** ..... (17 – 19)  
 Outputs digital audio signals.  
**8 Analog output terminals (LINE OUT)** ..... (17 – 19)  
 Outputs analog audio signals. They are unbalanced RCA output terminals.

# Preparations

## About the supplied software

Before connecting this unit to a computer, install the software on the supplied CD-ROM onto the computer.

- ASIO Driver
- Music management software “engine”

### □ About this unit and computer

- Computers running the following computer OS versions can be connected to this unit.
  - Mac OS X 10.6 or later
  - Windows XP SP3 or later (32 bit only)
  - Windows Vista SP2 or later (32 or 64 bit)
  - Windows 7 SP1 or later (32 or 64 bit)

Computers running other OS versions may not be compatible with the USB MIDI. For this reason, the computer may not operate correctly after connecting this unit to the computer via USB.

- \* Mac, Mac OS, iPad, iTunes and Quicktime is a registered trademark or trademark of Apple Inc. in the United States and/or other countries.
- \* Windows is a registered trademark or trademark of Microsoft Corporation in the United States and/or other countries.

### □ Software Upgrade

Please be sure to update with the latest firmware. From time to time, we will make improvements to current features or add new features.

We will try to include ideas from customers’ feedback where possible. The updates are made available via our [www.denondj.com](http://www.denondj.com) website.

## Installing the ASIO driver (Windows only)

- Use the following steps to install the ASIO driver.
- When using a Mac, no installation is required.

**1 Insert the supplied “DN-SC2900 Resource disc” into the computer.**  
The browse screen for the disc drive is displayed.

- If the browse screen is not displayed, click the disc drive on My Computer.

**2 Click “Asio Driver Installation”.**  
The ASIO Driver Setup Wizard is launched.

**3 Click “Next >”.**  
The license agreement screen (License Agreement) appears.

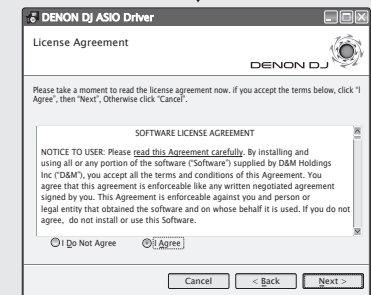
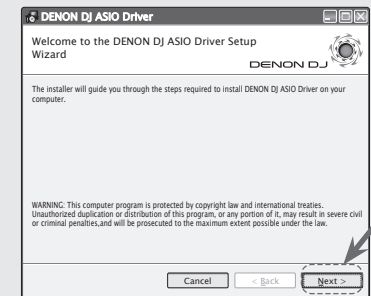

#### 4 If you agree, select “I Agree” and click “Next >”.

A screen for selecting the folder in which the ASIO driver is to be installed appears (Select Installation Folder).

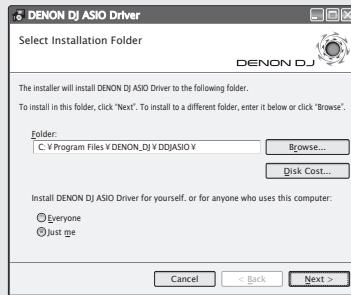
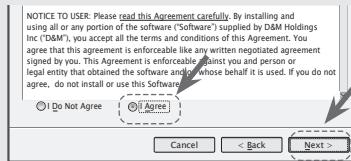

#### NOTE

If “I Do Not Agree” is selected, “Next >” cannot be clicked.

#### 5 Click “Next >”.

A screen for verifying whether or not to create a desktop shortcut appears (Create Icons).

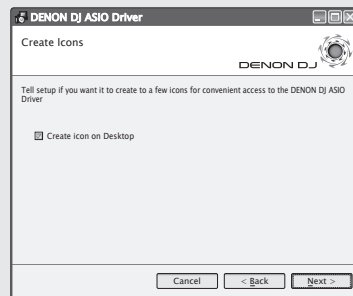
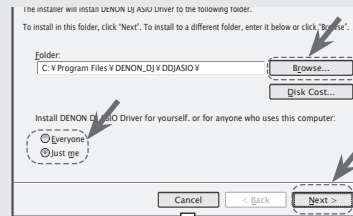

- The default installation folder for the ASIO driver is “C:/Program Files/DENON\_DJ/DDJASIO”.
- To change this location, click “Browse” and select a different folder.
- Select “Everyone” to share use of this software on the computer, or select “Just me” to use yourself without sharing.

#### 6 To create an icon, check “✓” into the checkbox, and click “Next >”.

The installation start screen (Confirm Installation) is displayed.

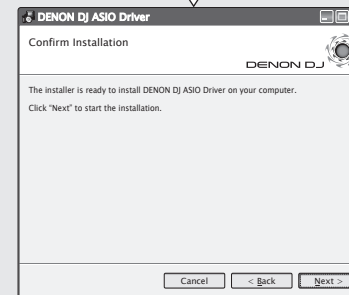
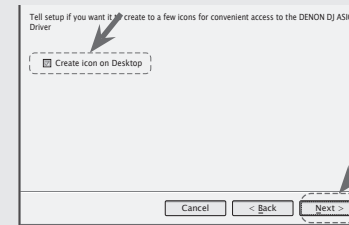

#### 7 Click “Next >”.

Installation begins.

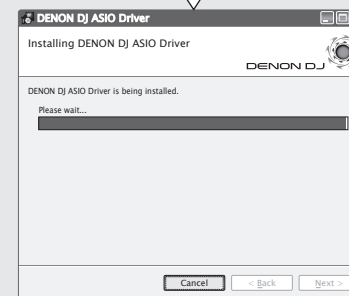
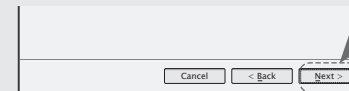

#### 8 When the following installation completion screen (Installation Complete) is displayed, click “Close”.

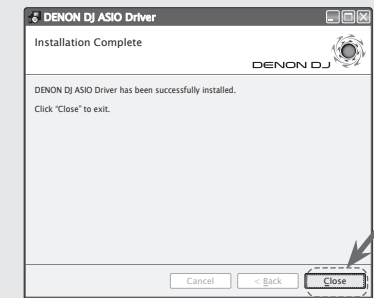

#### Uninstalling the ASIO driver

The software can be uninstalled from the control panel on the computer.

## Starting up the ASIO driver

Start the ASIO driver from the DJ software or desktop icon.  
"ASIO Control Panel" appears on the computer display.

### Control panel screen (ASIO Control Panel)

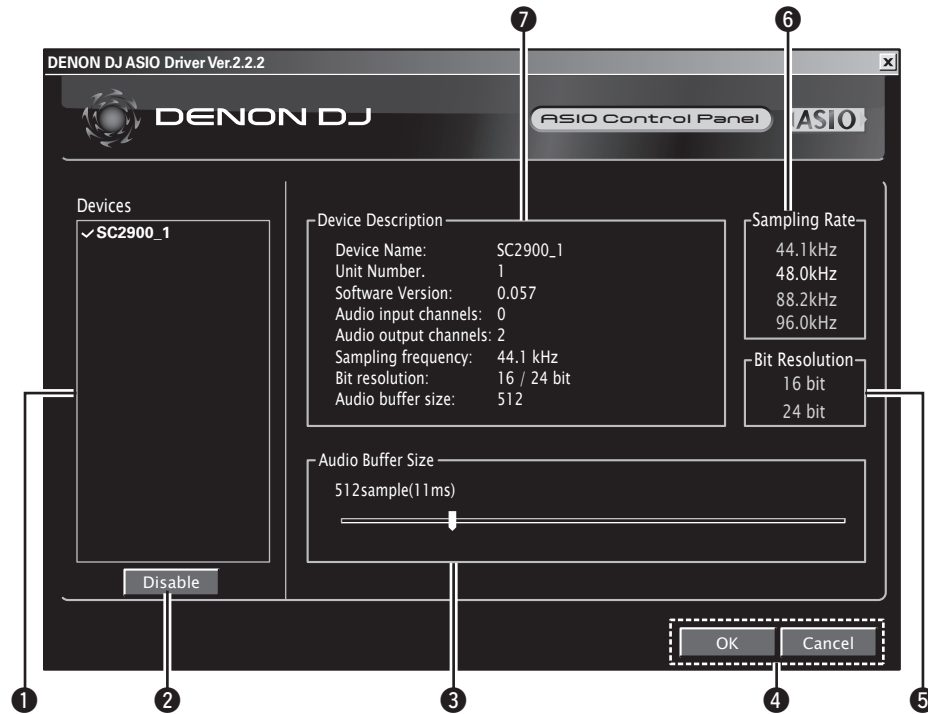

#### 1 Device list (Devices)

All connected DENON DJ devices are displayed in a list.

(Example: SC2900\_1)

- When the device that you want to check is selected from the list, the current settings of the selected device are displayed in 7.

#### NOTE

Select one device at a time. Multiple devices cannot be selected at the same time.

#### 2 ASIO Device switching button (Enable/Disable)

This button is used for switching a device selected in 1 (Devices) to enable or disable as an ASIO device.

#### [ASIO device status]

**Enable** : The device name is displayed in bold, and a check mark appears on the left.

**Disable** : The device name is displayed in light face, and the check mark on the left side is removed.



The ASIO device status can also be switched by double clicking the device name.

The ASIO device status switches as shown below each time the device name is double clicked 1.

Enable ← → Disable

#### 3 Audio Buffer Size

Use this slider to adjust the buffer size.

If sound skipping occurs during playback, increase the numerical value. However, if delay occurs, reduce the numerical value.



- The adjustable range is 88 – 2048 samples. It can be adjusted in 1 ms units.
- When you set multiple devices to enable as ASIO devices, the same setting values apply to all ASIO devices.

#### 4 OK/Cancel buttons

**OK** : Enters the setting changes.

**Cancel** : Cancels the setting changes.

#### 5 Bit Resolution

Displays the selection status of the bit resolution.

#### 6 Sampling Rate

The sampling rate selection is displayed here. The DENON DJ ASIO driver supports 44.1 kHz, 48 kHz, 88.2 kHz and 96 kHz frequencies. 44.1 kHz is selected when this unit is connected.

#### 7 Device Description

This is the area in which information for the device selected in the device information list is displayed.

The following are displayed:

- Device Name
- Unit Number
- Software Version
- Audio input channels
- Audio output channels
- Sampling frequency
- Max bit resolution
- Audio buffer size

#### NOTE

If the device's information cannot be acquired, "-" (hyphens) are displayed for all items.

## Installing TRAKTOR LE 2

Use the following steps to install the DJ software “TRAKTOR LE 2” in the supplied disc.

### ❑ Installation onto a Mac computer

- 1 Insert disc “TRAKTOR LE 2” into your computer.**  
The TRAKTOR LE 2 disc icon is displayed on the desktop.
- 2 Double-click the TRAKTOR LE 2 disc icon.**  
Files contained in the TRAKTOR LE 2 disc are displayed for browsing.
- 3 Double-click “Traktor Installer” .**  
A window opens and the TRAKTOR LE 2 installation starts.
  - Select Complete installation or Custom installation to start installation. If you are unsure about the Custom installation, select the Complete installation option.
- 4 Follow each step in the installation screen for installation.**
- 5 When the installation completes, close the installation screen.**



- After the installation, activate the software. For information about how to activate the software, see Service Center Manual, which is located in the Documentation folder under the Service Center folder that is created during the installation.
- It is recommended that you use the latest version of the TRAKTOR LE 2 software.
- For information about how to use the DJ software, see the instruction manual for the DJ software or the help menu.
- The serial number is printed on the back of the disc case.
- TRAKTOR LE 2 is an NI software. To install and use the software, you have to accept the software license agreement. D&M shall not be responsible for any problems with your computer and other software that may arise from the installation and use of TRAKTOR LE 2.

### ❑ Installation onto a Windows computer

- 1 Insert disc “TRAKTOR LE 2” into your computer.**  
The browse screen for the disc drive is displayed.
  - If the browse screen is not displayed, click the disc drive on My Computer.
- 2 Double-click “Traktor Setup.exe” .**  
A window opens and the TRAKTOR LE 2 installation starts.
  - Select Complete installation or Custom installation to start installation. If you are unsure about the Custom installation, select the Complete installation option.
- 3 Follow each step in the installation screen for installation.**
- 4 When the installation completes, close the installation screen.**



- If the ASIO Control Panel is open, close it before starting TRAKTOR LE 2.
- After the installation, activate the software. For information about how to activate the software, see Service Center Manual, which is located in the Documentation folder under the Service Center folder that is created during the installation.
- It is recommended that you use the latest version of the TRAKTOR LE 2 software.
- For information about how to use the DJ software, see the instruction manual for the DJ software or the help menu.
- The serial number is printed on the back of the disc case.
- TRAKTOR LE 2 is an NI software. To install and use the software, you have to accept the software license agreement. D&M shall not be responsible for any problems with your computer and other software that may arise from the installation and use of TRAKTOR LE 2.

### NOTE

- When using multiple DENON DJ devices such as DN-SC2900, change “Unit No.” (☞ page 44) in the Utility settings so that there are no duplicate numbers.
- When using DN-SC2900 with a DENON DJ mixer (DN-X1700/DN-X1600/DN-X600), set the sampling frequency (FS) on the DENON DJ mixer (DN-X1700/DN-X1600/DN-X600) to 44.1 kHz. For how to set this, see the owner’s manual of the DENON DJ mixer (DN-X1700/DN-X1600/DN-X600).
- It has been verified that this unit works properly with the TRAKTOR LE 2/PRO 2 software.
- Use the latest version of the TRAKTOR mapping file (tsi file). The latest version can be downloaded at [www.denondj.com](http://www.denondj.com).

## Automatic driver installation

When this unit is connected to the computer, drivers for the unit are automatically installed on the computer. When this device is connected to a Windows computer, the following message is displayed at the bottom right of the screen.



When the installation is completed, the following message is displayed at the bottom right of the screen.

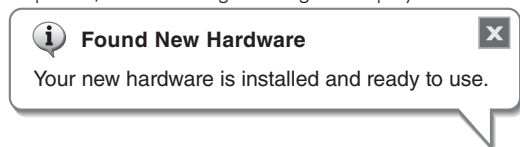

**If your computer's OS is Windows, on the DN-SC2900 select "Utility" – "Preset Setting" – "PC/MAC" (page 45) – "PC". The factory setting is "MAC".**

## Installing music management software "engine"

Install the "engine" software in the supplied disc onto your computer. For details on the installation method and operations, see the @engine Instruction manual.

## Obtaining the "engine for iPad" music management application

You can download "engine for iPad" from the App Store (within the iTunes Store).

# Connection

## Cables used for connection

Select the cables according to the equipment being connected.

### For LINE OUT terminals

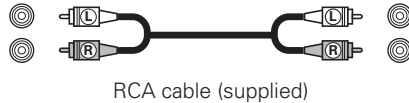

### For DIGITAL OUT terminals



### For FADER jack

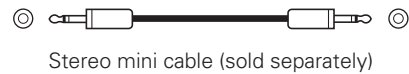

### For LINK terminal

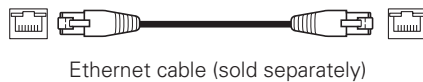

### For USB B (MIDI) port

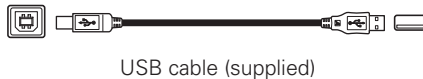

### NOTE

- Do not plug in the power cord until all connections have been completed.
- When making connections, also refer to the operating instructions of the other components.
- Be sure to connect the left and right channels properly (left with left, right with right).
- Connect the cables to the correct input and output terminals.
- Insert the plugs securely. Loose connections will result in the generation of noise.
- Do not bundle power cords together with connection cables. Doing so can result in humming or noise.

## Basic connections

- This is an example of the basic connections when connecting this unit to a DJ mixer.

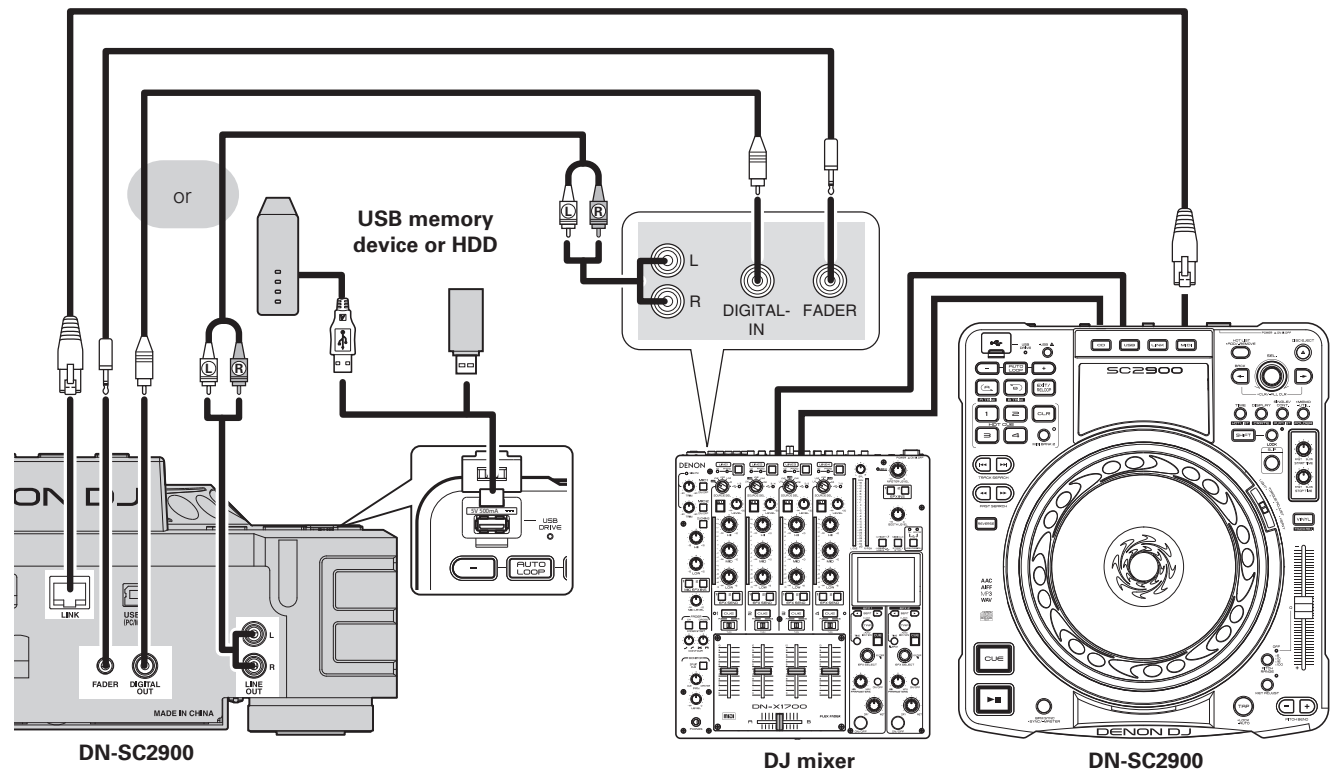

### NOTE

- USB hubs cannot be used.
- In order to prevent playback output clipping due to differences in playback level when an effector is used, set the playback level to  $-6$  dB from the normal playback level after converting digital output to analog.
- DENON does not guarantee that all USB memory devices will operate or receive power. When using a portable USB connection type HDD of the kind to which an AC adapter can be connected to supply power, use the AC adapter.

## Network connecting

- This is an example of connecting multiple DN-SC2900 units to a computer via a network and router. A maximum of four DN-SC2900 units can be connected.
- Use the following type of network cable.
  - RJ45 category 5 (CAT5) or higher
  - STP or ScTP cable
  - Either cross cables or straight cables can be used

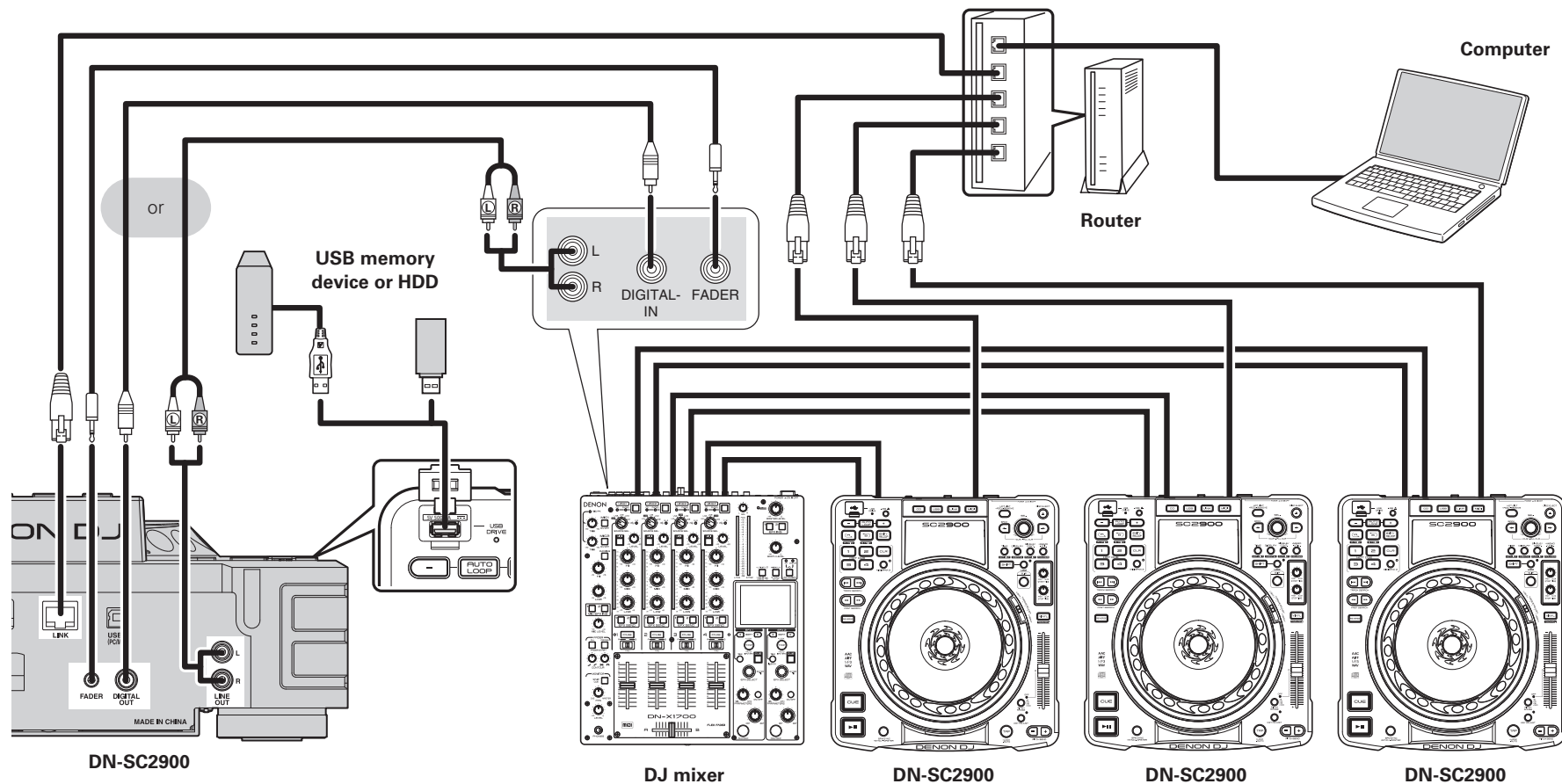

- Install the “engine” music management software on the computer that will be connected to this unit.
- In order for “engine” to recognize multiple connected units, use “Utility” – “Preset Setting” – “Network ID” (page 44) to set the different network ID for each unit.
- We recommend you use a router that has a DHCP server function for network connections. When a switching hub is used, it may take a few minutes to determine the network address after connection.

### NOTE

- Always connect DN-SC2900 to a computer using a wired LAN.
- After the router is started, connect the router to DN-SC2900 and your computer and power them on.
- If the computer has multiple LAN ports, we recommend disabling all LAN ports other than the one being used. If the other ports are not disabled, the link with this unit may not be established.
- Do not connect the router to the internet or WAN. Doing so may cause playback sound to cut out, or devices may not be able to connect correctly.
- This unit can be connected directly to a computer without using a router. In this case, set the computer’s network address settings to a fixed IP address, and use the following settings:  
IP address: 169.254.0.1 Subnet Mask: 255.255.0.0
- When connecting 4 units to a computer, use a router or LAN hub that has 5 or more LAN ports.
- When connecting using a router, this unit and the computer should be connected to LAN ports.
- The normal shielded-type Ethernet cable is recommended. If a flat-type cable or unshielded-type cable is used, other devices could be affected by noise.



## MIDI control connections

- This is an example of connecting this unit to a computer with DJ MIDI software installed, and operating this unit using MIDI control operations.
- Be sure to use the supplied USB cable for connection.
- If your computer OS is Windows, select "Utility" – "Preset Setting" – "PC/MAC" (page 45) – "PC".  
If your computer OS is Mac, select "Utility" – "Preset Setting" – "PC/MAC" (page 45) – "MAC".  
The default setting is "MAC".

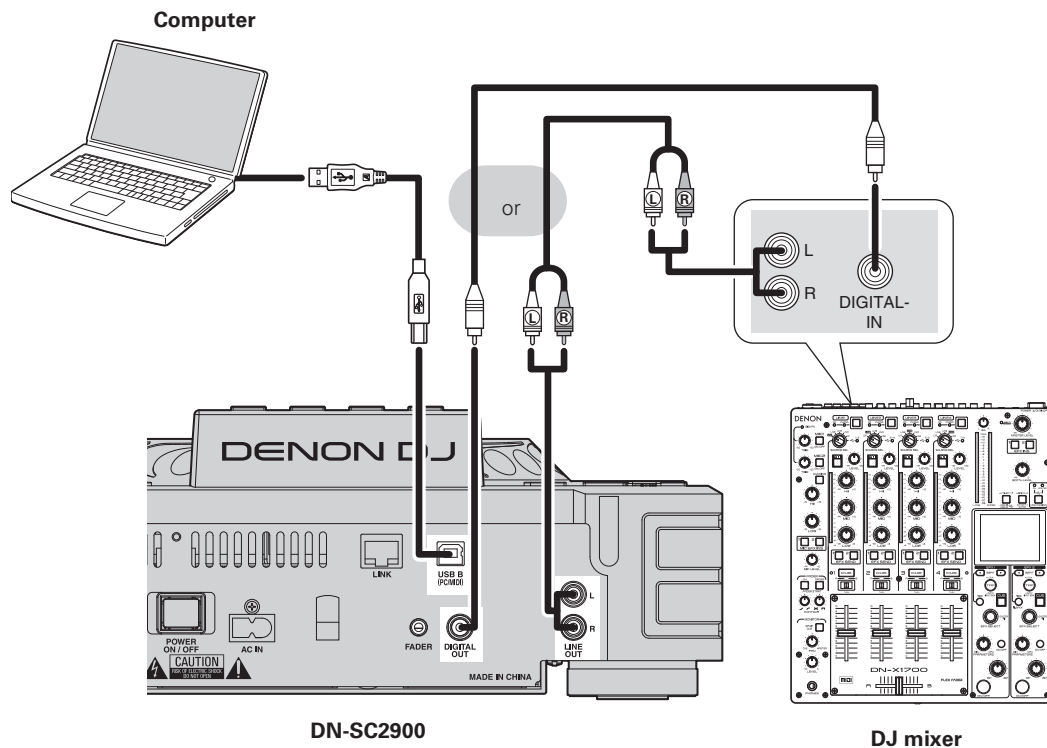

DN-SC2900

DJ mixer

### NOTE

DJ MIDI Software is not supplied with this unit.  
When using a MIDI control connection, install separate DJ software on the computer. For details on the installation method, see the instruction manual included with the DJ software.

## Connecting the power cord

Connect the supplied power cord to this unit, and insert the plug into the wall socket.

### NOTE

- Do not plug in the power cord until all connections have been completed.
- Insert the plug fully and securely into the socket. Incomplete connection to the power supply may cause damage to the unit, or noise.

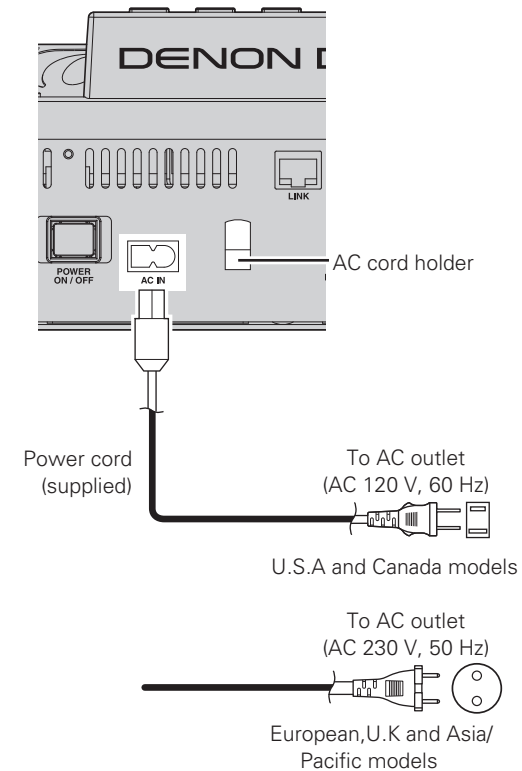

To prevent the power plug from falling out, we recommend fixing the power cord to the AC cord holder. Use a Phillips screwdriver to fix the power cord to the AC cord holder.

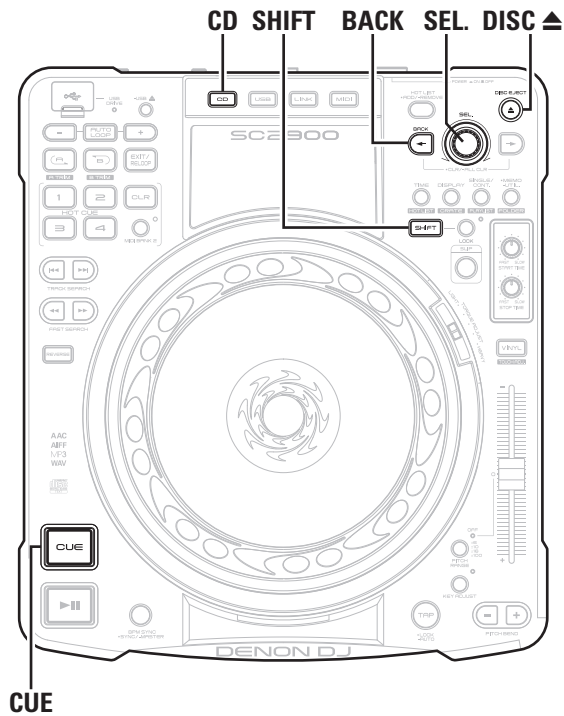

CUE

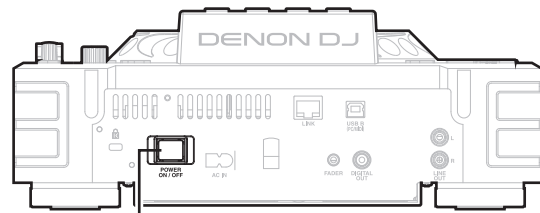

POWER ON/OFF

## Turning the power on

Press **POWER ON/OFF**.

"DENON DJ" appears on the display, and the power switches on.

## Turning the power off

Press **POWER ON/OFF**.

The power switches off.

### NOTE

Do not switch off the power while inserting or ejecting a disc. Doing so may damage the operating part of the CD, and may cause the unit to malfunction.

## Preparation for playback

This section explains how to operate each type of media.

### Preparing for CD playback

**1** Press **CD** to switch the source to CD.

**2** Insert a CD into the disc loading slot.

The first track on the CD is cued in standby mode, and **CUE** lights.

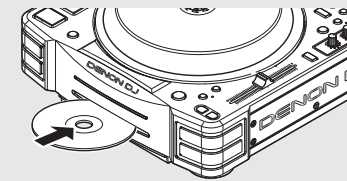

**3** Turn **SEL.** to select the track you want to play.

- Press and turn **SEL.** to select 10 tracks at a time.

**4** Press **SEL.**

The cue standby mode is set at the start of the selected tracks.

## Preparing for CD-ROM/CD-R/CD-RW playback

- Prepare to play tracks from a CD-ROM/CD-R/CD-RW.
- For details on the files that can be played on this unit, see page 4.

### NOTE

This section explains the operating procedures for CD-ROM/CD-R/CD-RW discs that have been finalized as data CDs. For CDs that have been finalized as music CDs, see “Preparing for CD playback” (page 20).

### 1 Press **CD** to switch the source to CD.

### 2 Insert a CD into the disc loading slot.

- The folder names and track names on the disc are shown in the display.
- Files are in the selected state.

### 3 Turn **SEL.** to select the folder that contains the track you want to play.

### 4 Press **SEL.**

The folder names or track names within the folder are shown in the display.

### 5 Turn **SEL.** to select the track you want to play.

- Press **BACK** to return to the previous folder.

### 6 Press **SEL.**

The cue standby mode is set at the start of the selected tracks.

### ❑ Ejecting CDs

#### Press **DISC ▲**.

The CD is ejected from the disc loading slot.

### NOTE

Be sure the CD is paused before ejecting. If **DISC ▲** is pressed during CD playback, the CD will not be ejected.

### ❑ If the CD cannot be ejected

If the CD is not ejected due to a malfunction in the unit even when **DISC ▲** is pressed, it can be ejected using other buttons.

#### Hold down **SHIFT**, and press **CD**.

The CD is ejected from the disc loading slot.

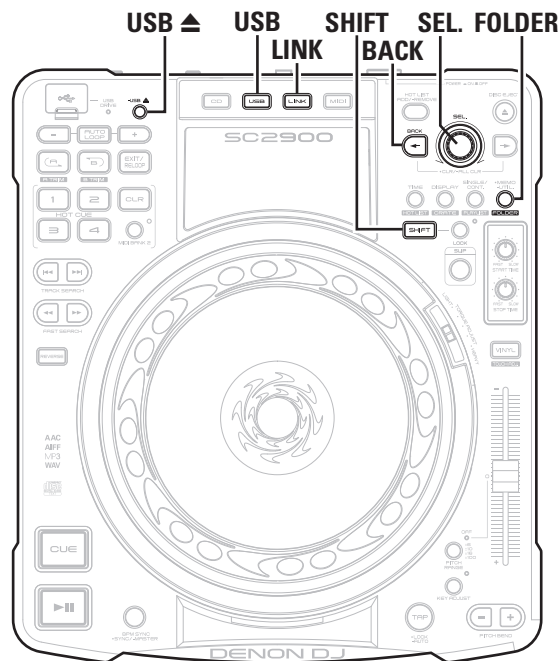

## Preparing for USB memory device or HDD playback

- Connect USB memory device or HDD to the USB port on the top panel, and prepare to playback a track.
- For details on the file formats that can be played on this unit, see page 4.

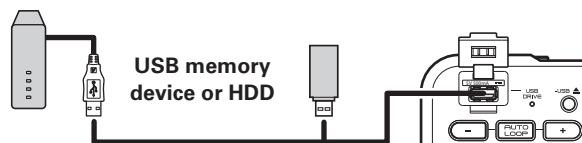

### Using a database

Creating a music search database using the “engine” music management software enables high-speed multifunctional music searching.

This section explains how to use a database to prepare for playback.

#### 1 Create a music search database.

- Use the “engine” music management software to create a music search database (📖 engine Instruction manual).

#### 2 Connect a USB memory device or HDD to the USB port.

The USB DRIVE indicator flashes red, and then remains lit. When the indicator is lit, the USB memory device or HDD can be used.

#### 3 Press USB to switch the source to USB.

#### 4 Turn SEL. to select “TITLE”.

#### 5 Press SEL.

Titles of the tracks that are registered to the database are shown in the display.

#### 6 Turn SEL. to select the track you want to play.

- You can also search for tracks by category (📖 page 24).

#### 7 Press SEL.

The cue standby mode is set at the start of the selected tracks.

### When not using a database

#### 1 Connect a USB memory device or HDD to the USB port.

The USB DRIVE indicator flashes red, and then remains lit. When the indicator is lit, the USB memory device or HDD can be used.

#### 2 Press USB to switch the source to USB.

#### 3 Hold down SHIFT, and press FOLDER.

The mode switches to folder search mode, and the folder names or track names within the root folder are shown in the display.

- If a database does not exist on the USB memory device or HDD, the mode automatically switches to folder search mode.

#### 4 Turn SEL. to select the folder.

#### 5 Press SEL.

The folder names or track names within the selected folder are shown in the display.

- Press BACK to go back 1 folder level.

#### 6 Turn SEL. to select the track you want to play.

#### 7 Press SEL.

The cue standby mode is set at the start of the selected tracks.



- FAT16/FAT32 and HFS+ (read only) formats are supported for the USB memory device and HDD.
- When using a USB HDD of the kind to which an AC adapter can be connected to supply power, use the AC adapter.
- If the USB memory device is not recognized, disconnect the USB memory device and then reconnect it.
- When there are 2,048 or more subfolders in a folder or when there are 1,024 or more music files saved in a folder, the exceeded subfolders or files cannot be displayed. (Not including folders and files under the displayed folder)

**NOTE**

- Depending on the type of mass-storage USB memory device or portable music player, it may take some time for this unit to recognize the device.
- Do not connect devices or cables that do not conform to USB standards.
- USB memory devices will not work via a USB hub.
- When HFS+ is used, this unit may not be able to recognize the file name if characters other than ISO8859-1 registered characters or character codes other than Japanese are used.
- HDDs up to 2 TB in size can be formatted using this unit. Larger HDDs are not supported.
- NTFS format USB memory devices and HDDs are not supported. If used, this unit may malfunction.
- When using a HDD that has an automatic power ON/OFF function that switches the HDD power on and off in sync with the computer, disable this function in the settings.

**❑ Removing the USB memory device or HDD**

**1** Press and hold **USB ▲**.

**2** When the **USB DRIVE** indicator turns off, disconnect the **USB memory device or HDD from the USB port**.

**NOTE**

- Be sure the USB memory device or HDD is paused before removing.
- When removing USB memory device or HDD, use the above procedure to turn off the **USB DRIVE** indicator before removing. Incorrectly removing the USB memory device or HDD may damage the data stored on the device.
- DENON cannot accept any responsibility whatsoever for the damage or loss of data from USB memory devices or HDDs that are used in conjunction with this device.
- There is no guarantee that this unit is compatible with all types of USB memory devices or HDDs.

**Preparing for playback from a network connected device**

- When this unit is connected via a network, tracks can be shared between multiple DN-SC2900 units, and tracks stored on the computer can also be shared. This section explains how to prepare for playback of tracks from devices connected via the network.
- For details on the file formats that can be played on this unit, see page 4.

**❑ Sharing tracks between multiple DN-SC2900 units**

**1** Connect **2 or more DN-SC2900 units to the network** (🔗 page 18).

- A maximum of four DN-SC2900 units can be connected to the network.
- Before starting, use “Utility” – “Preset Setting” – “Network ID” (🔗 page 44) to set the different network ID for each unit.

**2** Press **LINK**.  
The “Network ID” list of all units connected to USB memory devices and HDDs are shown in the display.

**3** Select the **“Network ID” of the unit connected to the USB memory device or HDD that contains the track you want to play back**.

**4** Turn **SEL.** to select **“TITLE”**.

**5** Press **SEL**.  
Titles of the tracks that are registered to the database are shown in the display.

**6** Turn **SEL.** to select the track you want to play.

- You can also search for tracks by category (🔗 page 24).

**7** Press **SEL**.  
The cue standby mode is set at the start of the selected tracks.

**❑ Sharing tracks between this unit and a computer**

- When this unit is connected to a computer, check that the following application is installed on the computer.
- Music management software “engine” (🔗 page 16)

**1** Connect this unit to the computer (🔗 page 18).

- Only one computer can be connected to this unit.

**2** Start **“engine” on the computer**.  
An icon representing the unit connected to the network is shown in the “engine” screen.

**3** Press **LINK**.  
The “Network ID” list of all units connected to USB memory devices and “engine” is shown in the display.

**4** Select **“engine” from the “Network ID” list**.

**5** Turn **SEL.** to select the track you want to play.

**6** Press **SEL**.  
The cue standby mode is set at the start of the selected tracks.

- For details of how to operate “engine”, see 📖 engine Instruction manual.

## Searching tracks

This section explains how to search for tracks using a database created using music management software “engine”.

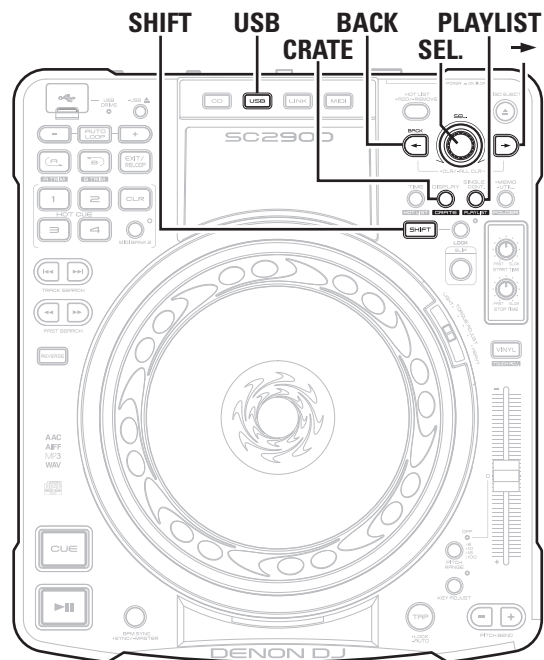

### Searching tracks by category

Tracks can be searched from the following categories.

- TITLE
- GENRE
- BPM
- ARTIST
- ALBUM

#### □ Searching tracks from 1 category

[Example] Searching for tracks by artist name

- 1 Press USB to switch the source to USB.**  
The search top menu is shown in the display.
  - To display the search top menu from the playback screen, press **BACK**.
- 2 Turn SEL. to select “ARTIST”.**
- 3 Press SEL.**  
Artist names that are registered to the database are shown as a list in the display.
- 4 Turn SEL. to select the artist name from the list.**
- 5 Press SEL.**  
A list of tracks by the selected artist is shown in the display.
- 6 Turn SEL. to select the track you want to play from the list.**
- 7 Press SEL.**
  - The title of the selected track is shown in the display.
  - The cue standby mode is set at the start of the selected tracks.

#### □ Searching tracks by multiple categories

[Example] Searching for tracks by genre and album name

- 1 Press USB to switch the source to USB.**  
The search top menu is shown in the display.
- 2 Turn SEL. to select “GENRE”.**
- 3 Press SEL.**  
Genres that are registered to the database are shown as a list in the display.
- 4 Turn SEL. to select the genre from the list.**
- 5 Press →.**  
Enter the search conditions, and the search top menu is shown in the display.
- 6 Turn SEL. to select “ALBUM”.**
- 7 Press SEL.**  
Album names that are registered to the database are shown as a list in the display.
- 8 Turn SEL. to select the album name from the list.**
- 9 Press SEL.**  
A list of track names that are refined by the categories selected in the display (genre, album name) is shown.
- 10 Turn SEL. to select the track you want to play from the list.**
- 11 Press SEL.**
  - The title of the selected track is shown in the display.
  - The cue standby mode is set at the start of the selected tracks.

## Canceling search conditions

- 1 Press BACK.**  
The search top menu is shown in the display.
- 2 Turn SEL. to select the category that you want to cancel from the categories set as search conditions.**
- 3 Press SEL.**  
Artist names that are registered to the database are shown as a list in the display.
- 4 Turn SEL. to select "ALL".**
- 5 Press SEL.**  
Cancels the search conditions.

## Canceling all search conditions

**Hold down BACK, and press →.**  
All of the set category search conditions are cancelled.

## Searching tracks by crate

Use the crate created by "engine" to search tracks.

- 1 Hold down SHIFT, and press CRATE.**  
The crate list is shown in the display.
- 2 Turn SEL. to select a crate.**
- 3 Press SEL.**  
A list of sub-crates within the selected crate is shown in the display.
  - Press **BACK** to go back 1 crate level.
- 4 Press →.**
  - Tracks within the selected crate are searched.
  - The search top menu is shown in the display.
- 5 Turn SEL. to select the track you want to play from the list.**
- 6 Press SEL.**
  - The title of the selected track is shown in the display.
  - The cue standby mode is set at the start of the selected tracks.

## Searching tracks by playlist

Use the playlist created by "engine" to search tracks.

- 1 Hold down SHIFT, and press PLAYLIST.**  
The playlist list is shown in the display.
- 2 Turn SEL. to select the playlist you want to search.**
- 3 Press SEL.**  
The titles of the tracks within the selected playlist are shown in the display.
- 4 Turn SEL. to select the track you want to play from the list.**
- 5 Press SEL.**
  - The title of the selected track is shown in the display.
  - The cue standby mode is set at the start of the selected tracks.

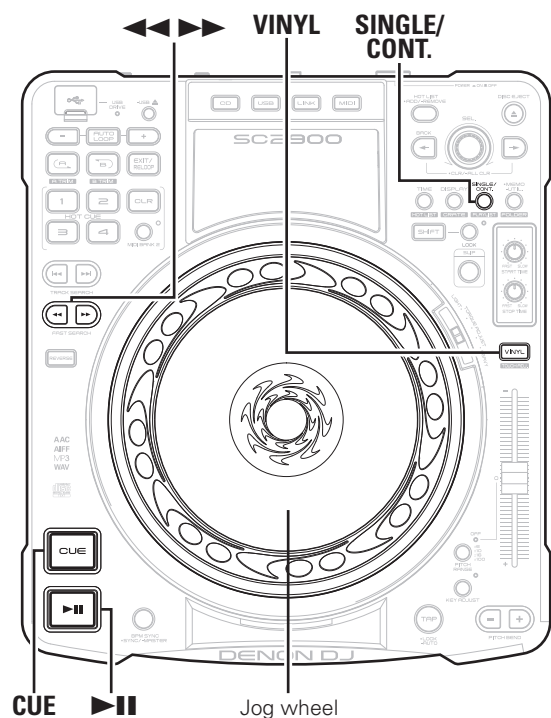

## Setting playback mode

This sets how tracks are played back.

### Press **SINGLE/CONT.**

- The playback mode is switched in the following order each time the button is pressed.

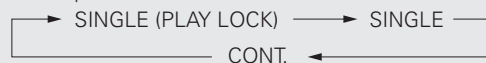

**SINGLE (PLAY LOCK)** The SINGLE indicator lights in the display, and "Play Lock" is shown. In this mode, when playback of the track is completed, the track returns to the cue point and is paused.

**SINGLE** The SINGLE indicator lights in the display, and "Lock Off" is shown. In this mode, when playback of the track is completed, the track returns to the cue point and is paused.

**CONT.** The CONT. indicator in the display lights. In this mode, when playback of the track has finished, the next track is played back.

### NOTE

"CONT." mode cannot be used when this unit is linked to "engine". The mode is forcibly changed to "SINGLE" mode.

## Playback

### Press **▶||**.

▶|| lights green, and playback starts.

## Pause

### Press **▶||** during playback.

▶|| flashes, and the track is paused.

- Press ▶|| again to resume playback from the point at which the track was paused.
- The track that is playing is paused when the jog wheel is touched while **VINYL** is lit.

## Fast forward/Rewind

There are two methods for fast forward/rewinding.

### Fast forward/Rewind using **◀◀ ▶▶** buttons

#### Fast forward/Rewind during playback

### Press **◀◀ ▶▶** during playback.

The playback point is moved approximately 3 seconds from the current point, and playback is resumed from the new playback point.

### Press and hold **◀◀ ▶▶** during playback.

The playback point moves at high speed, and playback starts at the point where the button is released.

#### Fast forward/Rewind during pause

### Press **◀◀ ▶▶** when the track is paused.

The playback point moves 1 frame at a time, and pause is resumed at the new point.

### Press and hold **◀◀ ▶▶** while the track is paused.

The playback point moves at high speed, and pause is resumed at the new point.



## ❑ Using the jog wheel for fast forward/rewind

- 1 Press VINYL.**  
VINYL mode switches off, and VINYL goes out.
- 2 Press ►|| during playback.**  
►|| flashes, and the track is paused.
- 3 Turn the jog wheel to find the playback point.**  
The playback point moves 1 frame at a time.
- 4 Press ►||.**  
Playback resumes from the next playback point.

## Setting the cue point

By setting a cue point, the track can be played back from the set position.

### ❑ Setting the cue point mode

The operating procedures for setting the cue point differs depending on the mode. Select the desired operating procedure along with the mode.

#### Switch the cue point setting mode in “UTILITY” – “Preset Setting” – “Cue Mode” (🔧 page 45).

**Standard** Sets the cue point by the standard method used in general DJ products.

**DENON** Sets the cue point in the same way as conventional DENON DJ products.

- The default setting is “Standard”.

## ❑ Setting the cue point

- ❑ **When using “Standard” mode**  
**Pause the track in the position where you want to set the cue point, and press CUE.**  
The cue point is set at the paused position.
- ❑ **When using “DENON” mode**  
**Pause the track in the position where you want to set the cue point, and start playback.**  
The cue point is set at the paused position.
- Irrespective of the mode, the cue point is set at the start of the track when the track is loaded.



The cue point lights purple on the jog wheel indicator. However, you can change the color settings. For details, see “Utility” – “Preset Setting” – “Jog Ind. Color” (🔧 page 45).

### ❑ Returning to the cue point

- Playback stops, returns to the position where you want to playback again (cue point), and is paused (back cue function).
- When this function is used, playback can always be started from the same position.

#### During playback, press CUE.

Playback stops, cues to the playback start position (cue point), and pauses.

## ❑ Moving the cue point

There are two methods for moving the cue point, using ◀◀ ▶▶ buttons, or using the jog wheel.

### Setting with ◀◀ ▶▶ buttons

- 1 When playback is paused, press ◀◀ ▶▶ and move the cue point to the position where you want to set it.**  
The cue point moves 1 frame each time the button is pressed.
- 2**
  - ❑ **When using “Standard” mode**  
**Press CUE.**  
The cue point is set at the moved position.
  - ❑ **When using “DENON” mode**  
**Press ►||.**  
The cue point is set at the moved position, and playback starts.

### Setting with the jog wheel

- 1 Press VINYL.**  
VINYL lights blue.
- 2 Turn the jog wheel while playback is paused to move the cue point to the position where you want to set it.**
  - You can search for the cue point by listening to the playback sound in 1 frame units.
- 3**
  - ❑ **When using “Standard” mode**  
**Press CUE.**  
The cue point is set at the moved position.
  - ❑ **When using “DENON” mode**  
**Press ►||.**  
The cue point is set at the moved position, and playback starts.

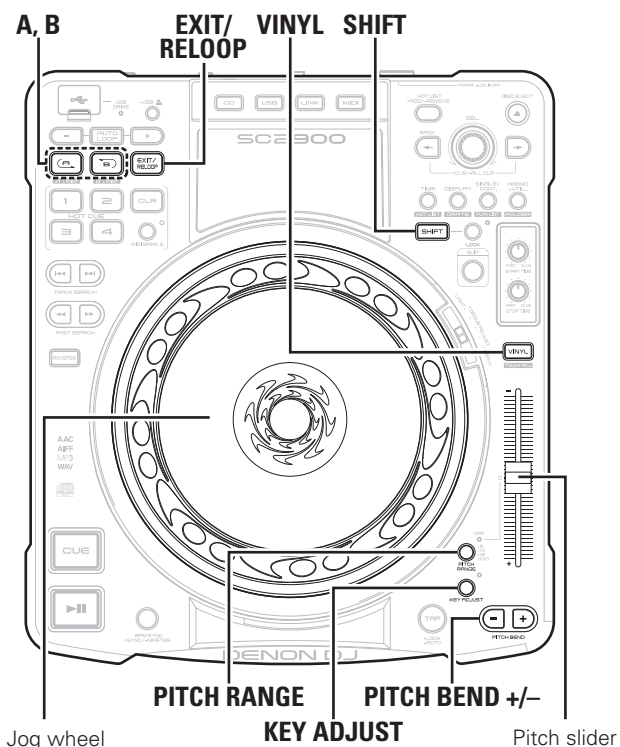

## Adjusting the playback speed

Use the pitch slider to adjust the playback speed (pitch).

### 1 Press PITCH RANGE.

The PITCH RANGE indicator lights on the display.

Each time the button is pressed, the range in which the playback speed can be adjusted switches as shown below.

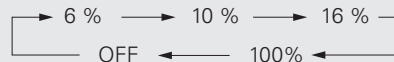

### 2 Move the pitch slider, and adjust to the desired playback speed.

## Adjusting the playback speed without changing the pitch

When the playback speed is adjusted, the pitch is not changed.

### Press KEY ADJUST.

The KEY ADJ. indicator lights on the display.

## Changing the playback speed temporarily (pitch bend function)

This function temporarily changes the playback speed.

There are 2 methods for changing the playback speed.

### Using the PITCH BEND buttons

#### Press PITCH BEND +/-.

**PITCH BEND +** Playback speed is increased while the button is being pressed.

**PITCH BEND -** Playback speed is decreased while the button is being pressed.

### Using the jog wheel

#### When VINYL mode is off

**1 Press VINYL, and VINYL illumination goes out.**  
The mode switches to BEND/SCRATCH mode.

**2 Turn the jog wheel during playback.**  
Turn the jog wheel to the right to increase the pitch, and left to decrease the pitch.

#### When VINYL mode is on

**1 Press VINYL, and VINYL illumination lights blue.**

**2 Turn the jog wheel during playback.**  
The playback speed changes according to the rotation speed of the jog wheel.

## Power on playback

If the power is turned on when a disc is loaded in the disc loading slot, playback starts from the first track on the disc.

Set “Utility” – “Preset Setting” – “Power on Play” (page 45) to “ON”.



When using a finalized CD-ROM/CD-R/CD-RW as a data CD, only save music files directly root of the disc.

## Manual loop playback

Set the starting point (A point) and end point (B point), and playback is repeated seamlessly between the two points.

### 1 During playback or pause, press **A** at the position where you want to start playback.

The A indicator lights in the display, and playback starts from the set A point.

### 2 Press **B** at the position where you want to end playback.

The B indicator lights in the display, and manual loop playback repeats between A and B.



When the file or track is changed, the set loop points are erased.

### ❑ Changing the end point of manual loop playback

During manual loop playback or pause, press **B** at the position where you want to end playback.

- The B point (end point) is moved to the position where B was pressed.

### ❑ Exiting manual loop playback

During manual loop playback, press **EXIT/RELOOP**.

“Exit Loop” is shown in the display, and normal playback resumes.

### ❑ Returning to manual loop playback

## When using “Standard” (👉 page 27) mode

In normal playback, press **EXIT/RELOOP**.

The playback position moves to the A point (start point) and manual loop playback starts.

## When using “DENON” (👉 page 27) mode

In normal playback or pause, press **EXIT/RELOOP**.

### ❑ If the current playback position is before the A-B positions,

- “Exit Off” is shown in the display.
- When the playback position passes the A point (start point) manual loop playback starts automatically.

### ❑ If the current playback position is after the A-B positions,

- Moves the playback point to the A point (start point) and manual loop playback starts.



If the **EXIT/RELOOP** button is pressed before the playback point passes the A point (start point), “Exit Loop” is shown in the display, and normal playback resumes.

### ❑ Adjusting loop points

## Adjusting the A point (start point)

### 1 During manual loop playback, press and hold **SHIFT**, and press **A**.

### 2 Turn the jog wheel while listening to the playback sound, and move to the position where you want to start playback.

- It can be adjusted in 1 frame units.

**[Adjustable range]**

- Range up to  $\pm 30$  frames from A point (start point).
- Range up to 1 frame before the B point (end point).

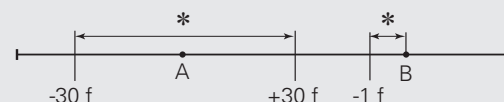

\* Adjustment range for A point

### 3 Press **A** at the position where you want to end playback.

A point (start point) adjustment is complete.

## Adjusting the B point (end point)

### 1 During manual loop playback, press and hold **SHIFT**, and press **B**.

### 2 Turn the jog wheel while listening to the playback sound, and move to the position where you want to end playback.

- It can be adjusted in 1 frame units.

**[Adjustable range]**

It can be adjusted from 1 frame after the A point (start point) to the end of the track.

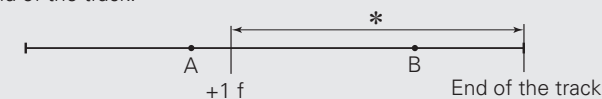

\* Adjustment range for B point

### 3 Press **B** at the position where you want to end playback.

B point (end point) adjustment is complete.

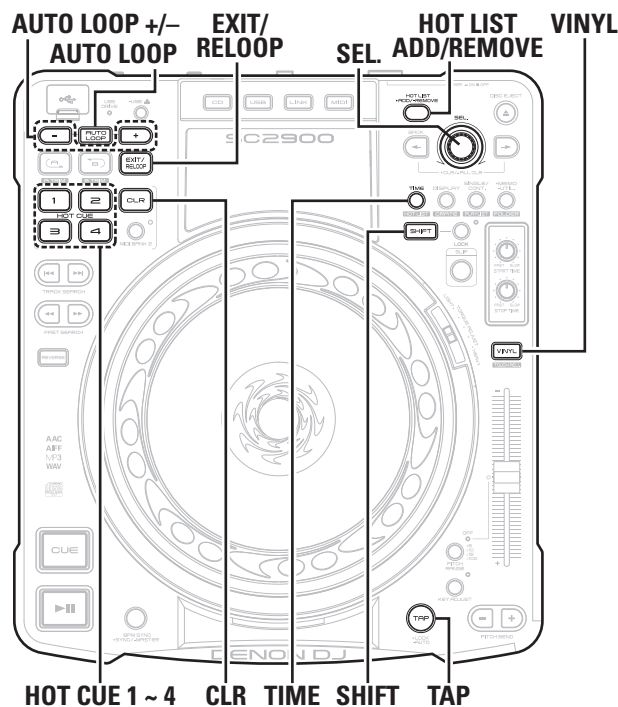

## Auto loop playback

This function automatically repeats playback in time with the beat.

### Setting auto loop playback

#### Press **AUTO LOOP**.

- **AUTO LOOP** lights, and the A and B indicators in the display flash.
- The playback position when the button is pressed is set as the A point (start point). From there, the beat source set in “Auto Loop Cnt.” (page 45) is automatically set as the B point (end point), and auto loop playback starts between A – B.

#### NOTE

If the BPM of the track being played is not set, auto loop playback may not operate correctly.

### Adjusting the auto loop playback range

#### Expanding the loop range

#### Press **AUTO LOOP +**.

- Each time the button is pressed, the loop range expands as shown below.

X2 → X4 → X8 → X16

- The B point (end point) moves to match the expanded loop range.
- The B point (end point) maximum range limit is the end of the track.

#### Reducing the A-B loop range

#### Press **AUTO LOOP -**.

- Each time the button is pressed, the loop range reduces as shown below.

X1/2 → X1/4 → X1/8 → X1/16

- The B point (end point) moves to match the reduced loop range.
- The minimum range for the B point (end point) is 1 frame after the A point.

### Exiting auto loop playback

#### During auto loop playback, press **EXIT/RELOOP**.

Auto loop playback exits, and normal playback resumes.

## Hot cue playback

The positions (hot cue points) where you want to start playback can be registered in **HOT CUE 1 – 4**.

### Registering hot cue points

#### At the position where you want to start playback, press one of **HOT CUE 1 – 4** that are lit dim blue.

The pressed button lights a bright blue, and the hot cue point is registered.

#### NOTE

Buttons that are lit bright blue already have hot cue points registered, and cannot be overwritten. Cancel the current hot cue point registration in order to re-register a hot cue point.

### Hot cue playback

#### Press one of **HOT CUE 1 – 4** that are lit bright blue.

Playback starts from the hot cue point set to the pressed button.

### Clearing hot cue points

#### Press and hold **CLR** and press one of **HOT CUE 1 – 4** whose registration you want to cancel.

The hot cue point is cleared from the pressed button.

## Hot list

When the track list (search screen) is being displayed, a selected track can be temporarily registered to the music file list (hot list).

### NOTE

When the unit power is switched off, all of the contents registered to the created hot list are cleared.

### ☐ Registering to the hot list

**1** Turn **SEL.** to display the track you want to register.

**2** Press **HOT LIST ADD/REMOVE.**  
“Add” is displayed, and the selected track is registered to the hot list.

### ☐ Playing tracks registered to the hot list

**1** Hold down **SHIFT,** and press **TIME.**  
The hot list is shown in the display.

**2** Turn **SEL.** to select the track you want to play.

**3** Press **SEL.**  
The cue standby mode is set at the start of the selected tracks.

### ☐ Clearing tracks from the hot list

**1** Hold down **SHIFT,** and press **TIME.**  
The hot list is shown in the display.

**2** Turn **SEL.** to select the track you want to clear.

**3** Press and hold **HOT LIST ADD/REMOVE.**  
The selected track is cleared.

### ☐ Sharing hot lists

When multiple DN-SC2900 units, are connected via a network, hot lists can be shared between units.  
For details, “Sharing hot list information” (📖 page 35).

## Auto BPM counter

During playback or cue standby, the tempo (BPM) of the track is automatically measured and displayed.

### ☐ Auto BPM counter

#### Press and hold **TAP.**

- The auto BPM counter switches on, and the tempo (BPM) is shown in the display.
- If the track changes when the BPM is locked, the lock is removed, and the auto BPM counter switches on.

### NOTE

Depending on the track, the automatic BPM measurement may not be performed correctly. In this case, perform “TAP Input” or “Manual BPM input”, and measure manually.

### ☐ BPM lock

This function locks data measured by the auto BPM counter.

#### When the auto BPM counter is on, press **TAP.**

“BPM LOCK” is shown in the display, and the data measured by the auto BPM counter is locked.

### ☐ Measuring BPM manually

#### TAP Input

The tempo (BPM) is measured according to the interval between repeated pressings of the **TAP.**

#### When BPM is locked, repeatedly press **TAP** in time with the beat.

The measured tempo (BPM) is shown in the display.

### Manual BPM Input

Enter the tempo (BPM) as a number.

**1** Hold down **TAP,** and turn **SEL.**  
BPM value appears on the display.

**2** Turn **SEL.** to the tempo (BPM) you want to set, and release **TAP.**  
The set value is entered, and data is locked.

- Press and turn **SEL.** to enter numbers below the decimal point.

## Scratch playback

Turn the jog wheel during playback to use scratch playback.

**1** Press **VINYL,** and select “**VINYL MODE**”.  
**VINYL** lights blue.

**2** Turn the jog wheel.  
Scratch playback starts.

- When the jog wheel is released, scratch playback ends and normal playback resumes.

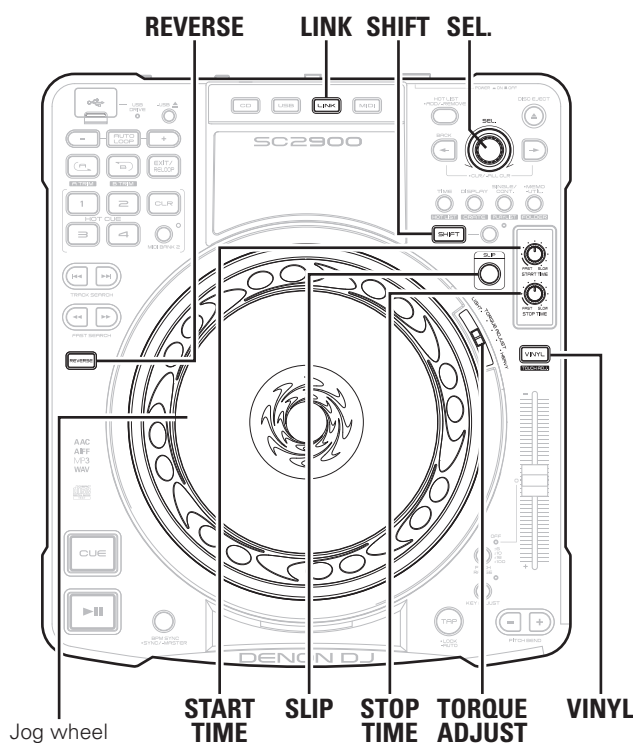

## Adjusting the rotation torque of the jog wheel

Adjusts the rotation torque of the jog wheel to the torque you want to set.

### Slide **TORQUE ADJUST**.

Slide toward the "LIGHT" direction to reduce rotation torque and the "HEAVY" direction to increase rotation torque.



The rotation torque can be adjusted during playback.

## Adjusting the touch sensor sensitivity of the Jog wheel (Touch Adjust)

Adjusts the sensitivity of the touch sensor when the top of the Jog wheel is touched.

### 1 Hold down **SHIFT**, and press **VINYL**. **VINYL** flashes.

### 2 Turn **SEL.** to select a touch sensor sensitivity.

- Touch sensor sensitivity is displayed in 5 levels. The factory setting is "2".

[Adjustable range] **Min, 1, 2, 3, Max**

### 3 Press **SEL**.

Touch sensor sensitivity is set.



You can adjust touch sensor sensitivity even while playing a track.

## Reverse playback

This function plays back the track in reverse.

### During playback, press **REVERSE**.

Reverse playback starts from the playback point where the button was pressed.

- Each time **REVERSE** is pressed, playback switches between normal and reverse playback.



- Reverse playback switches off when hot cue playback is used.
- When using reverse playback in **SINGLE** mode, when the playback position reaches the start of the track, playback switches to cue standby.

### Exiting reverse playback

#### During reverse playback, press **REVERSE**.

Reverse playback exits, and normal playback resumes.

## SLIP function

You can continue playback at the same beat even after reverse playback, loop playback, or scratch playback.

### During playback, press **SLIP**.

**SLIP** lights red, and the SLIP function is enabled.

- The playback point moves in the normal playback direction even during reverse playback, loop playback, or scratch playback.
- After a playback operation ends, normal playback resumes from the playback point reached.

### Disabling the SLIP function

#### When the SLIP function is enabled, press **SLIP**.

**SLIP** goes out, and the slip function is disabled.

## Adjusting the track startup/end time

This function adjusts the track startup and end times. By using this function, tracks can be started and stopped with similar characteristics to an analog player.

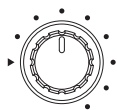

FAST SLOW  
START TIME

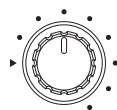

FAST SLOW  
STOP TIME

### Adjusting the track startup time

#### Turn START TIME.

- Turn to the left to make the track startup time faster.
- Turn to the right to make the track startup time slower.

### Adjusting the track end time

#### Turn STOP TIME.

- Turn to the left to make the track end time faster.
- Turn to the right to make the track end time slower.

## Network playback operations

This section explains the operations used when the unit is connected to the network.

### Sharing tracks on the network

Tracks on the USB memory device or computer are shared.

#### Sharing between DN-SC2900 units (Players Link)

- When more than one DN-SC2900 units are connected, tracks can be shared between units.
- In this example, a USB memory device connected to a DN-SC2900 unit set with "Network ID" "1" is searched by another DN-SC2900 unit with the "Network ID" "2", and tracks are played back from the USB memory device.
- In "Utility" – "Preset Setting" – "Network ID" (page 44), set the Network IDs for the DN-SC2900 units in advance.

#### 1 Press LINK on the unit set as "Network ID" "2", and select the unit whose "Network ID" is "1".

- The search status of the unit set as "Network ID" "2" becomes the same as the unit set as "Network ID" "1".
- When the unit set as "Network ID" "2" is operated, the unit set as "Network ID" "1" performs the same operations in sync.

#### 2 Search and enter the track on the unit set as "Network ID" "2".

The unit set as "Network ID" "2" switches to cue standby.

#### Sharing between this unit and a computer (PC Link)

- Tracks can be shared between this unit and a computer
- In this example, tracks on the computer are searched and played using the unit set as "Network ID" "1".

#### 1 Press LINK on the unit set as "Network ID" "1", and select "engine".

- The unit set as "Network ID" "1" is displayed on the "engine" control panel.
- The unit set as "Network ID" "1" can be used as the "engine" controller.

#### 2 Turn SEL. to search for a track, and press SEL. on the unit set as "Network ID" "1".

The track is loaded, and the unit set as "Network ID" "1" switches to cue standby.

- For details of how to operate "engine", see @engine Instruction manual.

#### NOTE

- If the same "Network ID" is used between different units, they cannot be connected on the network. If the same network IDs are duplicated, "SET ID >>>1 (duplicated "Network ID" number)" is displayed. Use SEL. to set another "Network ID".
- When sharing tracks between this unit and the computer, firewall settings on the computer need to be cancelled for "engine". For details on the setting method, see @engine Instruction manual.

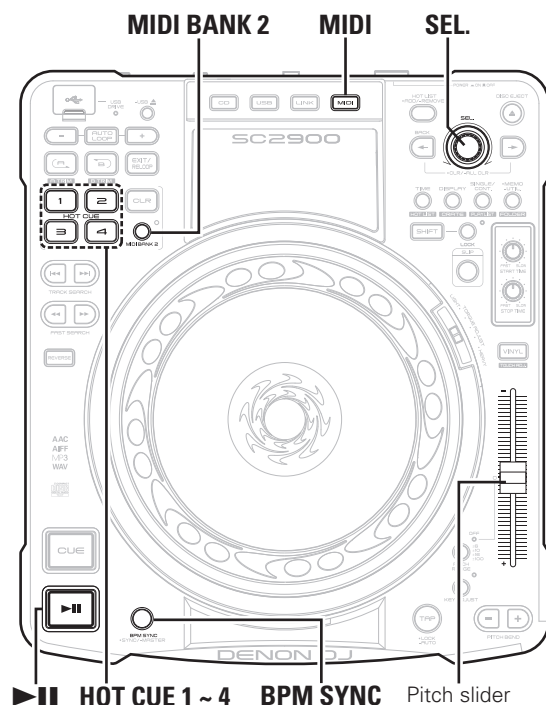

## Relay playback

- When multiple DN-SC2900 units are connected on the network, tracks are played back in the order of the registered “Network ID” number. A maximum of four DN-SC2900 units can be connected.
- Before starting, use “Utility” – “Preset Setting” – “Network ID” (☞ page 44) to set the Network IDs.

### Set “Utility” – “Preset Setting” – “Relay” (☞ page 45) to “ON”.

The mode switches to relay playback.

- In relay playback, tracks are played in the following order.
  - If relay playback mode is off for a unit, tracks are not played.
  - If a “Network ID” number is missing, the number is skipped for playback.



- When “OFF” is selected in “Utility” – “Preset Setting” – “Relay” (☞ page 45), normal playback is resumed.
- If relay playback mode is set to ON during playback, relay playback starts from the next track.

### ☐ About the track playback order

Depending on the playback mode, the track playback order differs. For details, see “Setting playback mode” (☞ page 26).

### In SINGLE playback mode

When playback of the track ends, playback of the next track starts on the player registered with the next “Network ID”.

### In CONTINUOUS playback mode

When playback of the last track ends, playback of the first track starts on the player registered with the next “Network ID”.

## Automatically adjusting BPM

When multiple DN-SC2900 units, are connected on the network, the BPM value from the desired player (MASTER) is set as the BPM on all other players (Slave) (BPM SYNC function).

### ☐ Set as “Master”

This sets the device that will be the standard when adjusting the BPM value.

### Press and hold BPM SYNC on the device that you want to be “MASTER”.

- “SYNC Master” appears on the display.
- **BPM SYNC** flashes, and the “Master” setting is complete.



- When the “Master” is set, all other connected players are set as “Slave”.
- If another player is already set as “Master”, set the other players to “Slave” before setting the desired unit to “Master”.

### ☐ Setting the “Master” BPM to the “Slave” BPM

#### Press BPM SYNC on the unit set as “Slave”.

- “BPM-SYNC” is shown in the display, and the BPM is set to the “Master” BPM.
- The PITCH indicator flashes, and the pitch value is shown in the display.
- Pitch adjustment is locked.



- When the pitch value at which the pitch slider is locked is matched, the pitch lock is released.
- Even if the connection between units in the BPM SYNC status is cancelled, pitch lock is maintained.
- When the track on the “Master” unit changes, the “Master” settings are transferred to the initially synced “Slave”. At this time, if the pitch is locked for the “Master” device, pitch lock is maintained.

### NOTE

This setting cannot be used unless one of the devices is set to “Master”.



## Automatically setting the “Slave” beat grid to the “Master” beat grid

- When the beat grid is cancelled using “engine” for the “Master” track and “Slave” track, the playback position can be adjusted to match the grid at the moment when the “Slave” matches the “Master” (beat grid SYNC function).
- This function can be set in “Utility” – “Preset Setting” – “Beat Point” (☞ page 45).
- For details of how to operate beat grid, see @engine Instruction manual.

### NOTE

Beat grid is only available for tracks registered in the database. It cannot be used with CDs.

## Sharing hot list information

- Hot lists can be shared between units that are connected via a network.
- When multiple DN-SC2900s are connected on the network, hot lists are displayed together as 1 list. At this time, the hot list is created in the order of registration.



For details on hot lists, see page 31.

## Sharing memo data

- Memo data saved on a USB memory device or HDD can be shared between devices connected to the network.
- When multiple DN-SC2900 units are connected on the network, memo data is created together as 1 list.



About the memo function see page 40.

# MIDI control operation

This unit is equipped with a USB MIDI command input/output function.

Using this function, the DJ MIDI software on the computer can be controlled using this device.

- For details on how to operate the DJ MIDI software, see the DJ MIDI software instruction manual or help menu.

## Basic operations

**1 Connect this unit using the provided USB cable to a computer that has DJ software installed** (☞ page 19 “MIDI control connections”).

**2 Press MIDI.**  
The MIDI indicator lights on the display.

**3 Turn SEL. to select either “Normal” mode or “Hybrid” mode.**

**Normal** This mode is used when general DJ software is used to control the unit. Select this mode for most normal conditions.

**Hybrid** Using this mode, the DN-SC3900 can control DJ software utilizing DVS without using time code recorded CDs. While the platter, ►|| and pitch slider are used to control the time code, the other buttons operate simultaneously as MIDI controllers.

- This function can be set in “Utility” – “Preset Setting” – “Hybrid MIDI Freq” and “Hybrid MIDI LED” (☞ page 45).

**4 Press SEL.**  
The MIDI indicator in the display lights, and the mode switches to MIDI control mode.

**5 Operate the buttons and knobs on this unit to output MIDI commands.**

The DJ software on the computer is controlled.

- Tracks played back by the DJ software can be output via this device.

## Switching between MIDI layers 1/2

The MIDI layer of the **HOT CUE 1 – 4** buttons can be switched. By switching the MIDI layer, the MIDI commands that can be output change.

### Press MIDI BANK 2.

- The MIDI layer is switched as shown below.

MIDI layer 1 (MIDI BANK 2 indicator goes out) ←→ MIDI layer 2 (MIDI BANK 2 indicator lights)

## Switching MIDI channels

- You can connect more than one DN-SC2900 to a computer to control DJ software. Switch MIDI channels as needed.
- Set a MIDI channel for each connected device. The default setting is “1”.

Select a MIDI channel to set by selecting “Utility” – “Preset Setting” – “MIDI CH” (☞ page 45).

### NOTE

- In the “Hybrid” mode, do not connect output terminals to devices such as amps. Doing so may damage your speakers.
- Before using the MIDI control mode, install the DJ software in the computer to which this unit is connected. After the installation, install the mapping file for operating data on the computer with this unit.

# MIDI command list

## Send command

\* n=MIDI CH = 0 – 15 ○ : Compatible

	Items	MIDI command			Notes	Normal	Hybrid MIDI	
		Command	Number	Value			Normal	Always lit
1	Disc EJECT		1	C#-1			○	○
2	VINYL		4	E-1			×	×
3	Pitch Range		5	F-1				
4	KEY ADJUST		6	F#-1			○	○
5	TAP		7	G-1				
6	Pitch Bend +		8	G#-1			×	×
7	Pitch Bend –		9	A-1				
8	Track Search +		12	C0				
9	Track Search –		13	C#0				
10	Fast search +		16	E0				
11	Fast search –		17	F0				
12	DISPLAY MODE		22	A#0				
13	HOT1		23	B0				
14	HOT2		24	C1				
15	HOT3		25	C#1				
16	CLR		26	D1				
17	AUTO LOOP		29	F1				
18	HOT4		32	G#1				
19	TIME		35	B1			○	○
20	MEMO/Util	NOTE ON : 0x9n	36	C2	NOTE ON : 64			
21	CONT./SINGLE	NOTE OFF : 0x8n	38	D2	NOTE OFF : 0	○		
22	SELECT SW		40	E2				
23	FWD		41	F2				
24	BACK		48	C3				
25	MIDI		51	D#3				
26	USB		53	F3				
27	A		55	G3				
28	B		57	A3				
29	EXIT/Reloop		64	E4				
30	Cue		66	F#4				
31	Play		67	G4			×	×
32	SLIP		69	A4			○	○
33	REVERSE		70	A#4			×	×
34	Utility mode		82	A#5	Press and hold <b>MEMO</b> . • The unit switches to utility mode. When the utility mode is OFF • all of the display data needs to be sent to the controller from the computer.		○	○

	Items	MIDI command			Notes	Normal	Hybrid MIDI	
		Command	Number	Value			Normal	Always lit
35	CD		86	D6				
36	SHIFT		96	C7				
37	ADD		104	G#7				
38	– *1 (Loop Length)		105	A7				
39	+ *2 (Loop Length)		106	A#7				
40	SYNC		107	B7				
41	LINK		112	E8				
42	SHIFT LOCK		113	F8				
43	USB EJECT	NOTE ON : 0x9n	114	F#8	NOTE ON : 64		○	○
44	HOT1 (MIDIBANK2)	NOTE OFF : 0x8n	115	G8	NOTE OFF : 0			
45	HOT2 (MIDIBANK2)		116	G#8				
46	HOT3 (MIDIBANK2)		117	A8				
47	HOT4 (MIDIBANK2)		118	A#8				
48	MIDI BANK2		119	B8				
49	Jogwheel touch (VINYL = ON)		81	A5				
50	Jogwheel touch (VINYL = OFF)		87	D#6		○	×	×
51	Jogwheel touch (JW LOCK is enabled)		88	E6				
52	Parameters KNOB Increment/ Decrement		84	Increment 0 Decrement 127			○	○
53	Start Time		120	0 – 127				
54	Stop Time		121	0 – 127				
55	Pitch Slider MSB		122	0 – 127(MSB)				
56	Pitch Slider LSB		123	0 – 127(LSB)	14bit data 0(min) • 8192(middle) • 16383(max)			
57	Jogwheel fwd/rev (VINYL = ON)	CC : 0xBn	81				×	×
58	Jogwheel fwd/rev (VINYL = OFF)		87	Reverse 63 – 1 Forward 65 – 127 slow->fast ※relative data	3600Pulse/cycle			
59	Jogwheel fwd/rev (JW LOCK is enabled)		80					

## Reception commands

\* n=MIDI CH = 0 – 15 ○ : Compatible × : Incompatible

	Items (Lit display (LED))	MIDI command			Notes	Normal	Hybrid MIDI	
		Command	Number	Value			Normal	Always lit
1	VINYL	CC : 0xBn	ON TRG : 74 OFF TRG : 75 Blink ON TRG : 76	6	with Vinyl Mode change	○	×	×
2	Pitch Range/OFF			7				
3	Key Adjust			8				
4	HOT1			17				
5	HOT1 Dimmer			18				
6	HOT2			19				
7	HOT2 Dimmer			20				
8	HOT3			21				
9	HOT3 Dimmer			22				
10	HOT4			23				
11	HOT4 Dimmer			24				
12	SELECT			30				
13	A			36				
14	Auto Loop			43				
15	A Dimmer			62				
16	B			64				
17	B Dimmer			42				
18	Cue			38				
19	Play			39				
20	SLIP			41				
21	REVERSE			58				
22	JOG wheel/TT			59				
23	CD IN			72				
24	SYNC			82				
25	SHIFT LOCK			89				
26	HOT1 (MIDIBANK2)			49				
27	HOT1 Dimmer (MIDIBANK2)			50				
28	HOT2 (MIDIBANK2)			51				
29	HOT2 Dimmer (MIDIBANK2)			52				
30	HOT3 (MIDIBANK2)			53				
31	HOT3 Dimmer (MIDIBANK2)			54				
32	HOT4 (MIDIBANK2)			55				
33	HOT4 Dimmer (MIDIBANK2)			56				

	Items (Others)	MIDI command			Notes	Normal	Hybrid MIDI	
		Command	Number	Value			Normal	Always lit
1	Pitch slider request	CC : 0xBn	74	60	Return pitch slider position	○	×	×
2	Vinyl mode request			73	Return Vinyl Mode			
3	Start Time request			120				
4	Stop Time request			121				
5	Vinyl mode		ON : 74 OFF : 75 JW LOCK is enabled : 76	6	-			

	Items (Jog wheel indicator)	MIDI command			Notes	Normal	Hybrid MIDI	
		Command	Number	Value			Normal	Always lit
1	LED (Blue) 0-5	0xAn	0-63	1	LED No : Clockwise from Top LED	○	○	○
2	LED (Blue) 6-11			2				
3	LED (Blue) 12-17			3				
4	LED (Blue) 18-23			4				
5	LED (Blue) 24-29			5				
6	LED (Blue) 30-35			6				
7	LED (Blue) 36-41			7				
8	LED (Blue) 42-47			8				
9	LED (Red) 0-5			9				
10	LED (Red) 6-11			10				
11	LED (Red) 12-17			11				
12	LED (Red) 18-23			12				
13	LED (Red) 24-29			13				
14	LED (Red) 30-35			14				
15	LED (Red) 36-41			15				
16	LED (Red) 42-47			16				
17	CUE position			17				
18	Scratch position		18	96-127 : OFF	Clockwise from Top position (0) 96points/cycle			

	Items (VFD Parameter)	MIDI command			Notes	Normal	Hybrid MIDI						
		Command	Number	Value			Normal	Always lit					
1	Tr number MSB	CC : 0xBn	64	0 – 99	-	○	○	○					
2	Tr number LSB		65	100 – 109 : "0" to "-9"									
3	Time mini		66										
4	Time sec		67	110 : "--"									
5	Time frame		68	111 : " "									
6	Pitch POL		69	'0 '+' 1 - 2									
7	Pitch MSB		70	0-99									
8	Pitch LSB		71	100 – 109 : "0" to "-9" 110 : "--" 111 : " "									
9	Track Position		72 normal 73 reverse	0 – 100 %									
10	Point indicator		58 ON 59 OFF	0 to 99 (=left edge to right end)									
11	Segment 1-1 MSB		1	0 – 15					ASCg+original MSB * Segment command must be sent to a pair in order of MSB, LSB.	○	○	○	
12	Segment 1-2 MSB		2										
13	Segment 1-3 MSB		3										
14	Segment 1-4 MSB		4										
15	Segment 1-5 MSB		5										
16	Segment 1-6 MSB		7										
17	Segment 1-7 MSB		8										
18	Segment 1-8 MSB		9										
19	Segment 1-9 MSB		10										
20	Segment 1-10 MSB		11										
21	Segment 1-11 MSB		12										
22	Segment 1-12 MSB		13										
23	Segment 1-13 MSB		88										
24	Segment 1-14 MSB		89										
25	Segment 1-15 MSB		90										
26	Segment 1-16 MSB		91										
27	Segment 1-1 LSB		33						ASCg+original LSB				
28	Segment 1-2 LSB		34										
29	Segment 1-3 LSB		35										
30	Segment 1-4 LSB		36										
31	Segment 1-5 LSB		37										
32	Segment 1-6 LSB		39										
33	Segment 1-7 LSB		40										
34	Segment 1-8 LSB		41										

	Items (VFD Parameter)	MIDI command			Notes	Normal	Hybrid MIDI	
		Command	Number	Value			Normal	Always lit
35	Segment 1-9 LSB	CC : 0xBn	42	0 – 15	ASCg+original LSB	○	○	○
36	Segment 1-10 LSB		43					
37	Segment 1-11 LSB		44					
38	Segment 1-12 LSB		45					
39	Segment 1-13 LSB		92					
40	Segment 1-14 LSB		93					
41	Segment 1-15 LSB		94					
42	Segment 1-16 LSB		95					
43	Segment 2-1 MSB		14					
44	Segment 2-2 MSB		15					
45	Segment 2-3 MSB		16					
46	Segment 2-4 MSB		17					
47	Segment 2-5 MSB		18					
48	Segment 2-6 MSB		19					
49	Segment 2-7 MSB		20					
50	Segment 2-8 MSB		21					
51	Segment 2-9 MSB		22					
52	Segment 2-10 MSB		23					
53	Segment 2-11 MSB		24					
54	Segment 2-12 MSB		25					
55	Segment 2-13 MSB		108					
56	Segment 2-14 MSB		109					
57	Segment 2-15 MSB		110					
58	Segment 2-16 MSB		111					
59	Segment 2-1 LSB		46					
60	Segment 2-2 LSB		47					
61	Segment 2-3 LSB		48					
62	Segment 2-4 LSB		49					
63	Segment 2-5 LSB		50					
64	Segment 2-6 LSB		51					
65	Segment 2-7 LSB		52					
66	Segment 2-8 LSB		53					
67	Segment 2-9 LSB		54					
68	Segment 2-10 LSB		55					
69	Segment 2-11 LSB	56						
70	Segment 2-12 LSB	57						
71	Segment 2-13 LSB	112						
72	Segment 2-14 LSB	117						
73	Segment 2-15 LSB	118						
74	Segment 2-16 LSB	119						

- Getting started
- Part names and functions
- Preparations
- Connection
- Playback
- MIDI control**
- Others
- Settings
- Troubleshooting
- Specifications
- Index

	Items (VFD Symbol)	MIDI command			Notes	Normal	Hybrid MIDI			
		Command	Number	Value			Normal	Always lit		
1	T.	CC : 0xBn	ON TRG : 77 OFF TRG : 78 Blink ON TRG : 79	1	-	○				
2	REMAIN			2						
3	ELAPSED			3			○	○		
4	CONT.			4						
5	SINGLE			5						
6	BPM			6			×	×		
7	m			7						
8	s			8			○	○		
9	f			9						
10	Pitch dot Right			10						
11	Pitch dot Center			11			×	×		
12	Pitch dot Left			12						
13	CD			13						
14	USB			14						
15	MIDI			15						
16	MP3			16						
17	WAV			17						
18	LINK			18						
19	KB			19			○	○		
20	KEY ADJ.			20						
21	MEMO			21						
22	(			22						
23	)			24						
24	A			26						
25	B			28						
26	PITCH			70			×	×		
27	AAC			71						
28	AIFF			72						
29	WFM			73						
30	Scratch Ring out side			30						
31	Scratch Ring in side			31						
32	Touch dot			32						
33	Track Position			only Use 78/79			33	Total blink ON/OFF		
34	Scratch Position 1 (Top right)	only Use 77/78	34	-	○					
35	Scratch Position 2		35							
36	Scratch Position 3		36						○	○
37	Scratch Position 4		37							
38	Scratch Position 5		38							
39	Scratch Position 6		39							
40	Scratch Position 7		40							
41	Scratch Position 8		41							
42	Scratch Position 9		42							
43	Scratch Position 10		43							
44	Scratch Position 11		44							
45	Scratch Position 12		45							

	Items (VFD Symbol)	MIDI command			Notes	Normal	Hybrid MIDI			
		Command	Number	Value			Normal	Always lit		
46	Scratch Position 13	CC : 0xBn	only Use 77/78	46	-	○	○	○		
47	Scratch Position 14			47						
48	Scratch Position 15			48						
49	Scratch Position 16 (Bottom)			49						
50	Scratch Position 17			50						
51	Scratch Position 18			51						
52	Scratch Position 19			52						
53	Scratch Position 20			53						
54	Scratch Position 21			54						
55	Scratch Position 22			55						
56	Scratch Position 23			56						
57	Scratch Position 24			57						
58	Scratch Position 25			58						
59	Scratch Position 26			59						
60	Scratch Position 27			60						
61	Scratch Position 28			61						
62	Scratch Position 29			62						
63	Scratch Position 30			63						
64	Scratch Position 31	64								
65	Scratch Position 32 (Top)	65								

- Getting started
- Part names and functions
- Preparations
- Connection
- Playback
- MIDI control**
- Others
- Settings
- Troubleshooting
- Specifications
- Index

## Memo function

- Details set in advance can be stored as memo data on a USB memory device or HDD. When you need to configure settings in a short space of time, settings can be configured automatically just by calling saved memo data.
- 1 memo is created for 1 track, and a maximum total of 100,000 memos can be saved.

## Media that can be used with the memo function

The method for saving memo data differs depending on the playback media used.

### CD/CD-ROM

The memo data is saved in the memo area created on the USB memory device or HDD. Before using the memo function, create the memo area.

For details on creating the memo area, see “Memo Area” (📖 page 46).

### Details that can be saved as memo data

- Cue point
- Manual loop point (A/B point)
- Hot cue point 1/2/3/4
- Playback speed
- Pitch range
- Key adjust ON/OFF
- BPM (Cue point, Manual loop point (A), Hot cue point 1 – 4 BPM value)

### USB memory device or HDD

- Memo data is created in the folder containing the track.
- When playing back tracks for which memo data is saved on a different player, the memo data can be called.

### Details that can be saved as memo data

- Cue point
- Manual loop point (A/B point)
- Hot cue point 1/2/3/4
- Playback speed
- Pitch range
- Key adjust ON/OFF
- BPM (Cue point, Manual loop point (A), Hot cue point 1 – 4 BPM value)

#### NOTE

Memo data cannot be saved on a USB memory device or HDD formatted in HFS+ format. Use FAT16 or FAT32 format.

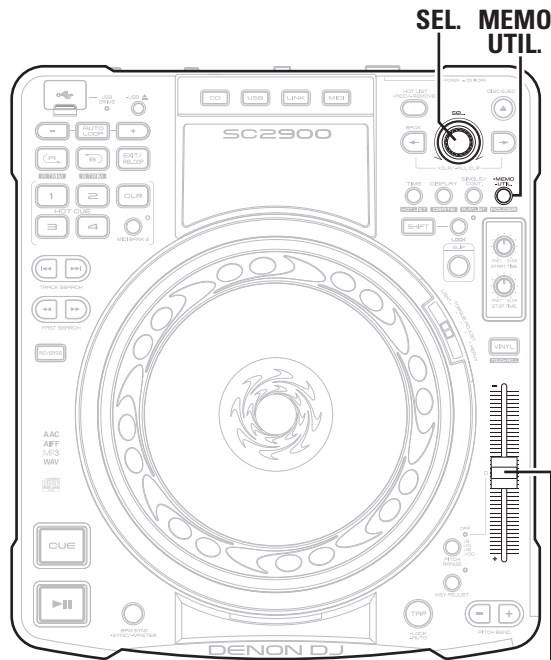

Pitch slider

## Memo settings

### Memo Set

Save the setting details to memo data.

#### 1 Set this unit with memo data.

#### 2 Press MEMO UTIL.

"Set" is shown in the display.

#### 3 Press SEL.

When saving is complete, the MEMO indicator lights, and "Complete!" is shown in the display.



- When "MEMO" is shown in the display, memo data has already been saved. To save new memo data, select "Overwrite".
- If memo data cannot be saved, check the remaining capacity of the USB memory device or HDD. It may not be possible to save memo data if there is not enough spare memory.
- If the USB memory device or HDD is equipped with a security function, check that the security is disabled.

### Memo Call

This function calls saved memo data.

#### 1 Select the track that is stored with the memo data that you want to call.

- When a track that has memo data stored is selected, the MEMO indicator lights in the display.

#### 2 Press MEMO UTIL.

"Call" is shown in the display.

#### 3 Press SEL.

The saved memo data is called. When memo data call is complete, the track switches to standby at the cue point saved in the memo data.



When the playback speed is called from the memo data, the PITCH indicator flashes, and the pitch may be locked.

This is because the actual playback speed and playback speed selected by the pitch slider differ. In order to cancel the pitch lock, adjust the pitch slider to the same pitch as the called memo data.

### Auto Memo Load

When a track that has memo data stored is selected, the memo data for that track is automatically called.

#### 1 Set "Utility" – "Preset Setting" – "Auto Memo Load" (page 45) to "ON".

- The default setting is "ON".

#### 2 Select the track that is stored with the memo data that you want to call.

When a track that has memo data stored is selected, the MEMO indicator lights in the display.

#### 3 Press SEL.

The memo data is called. When memo data call is complete, the track switches to standby at the cue point saved in the memo data.

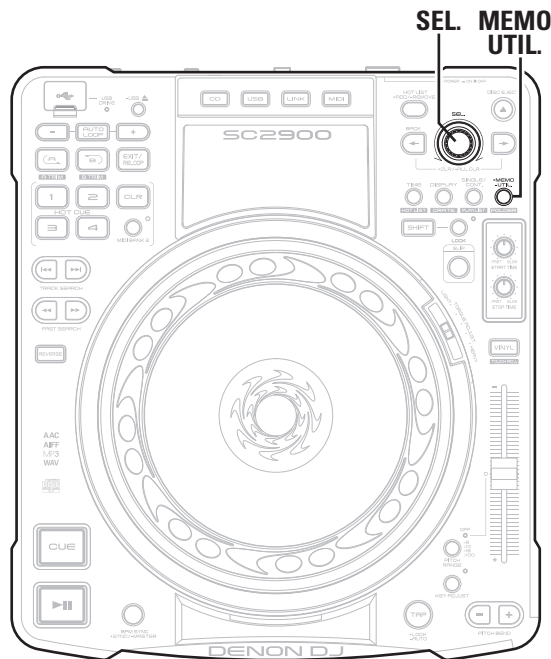

## ❑ Memo Clear

This function clears saved memo data.

### 1 Select the track that is stored with the memo data that you want to clear.

- When a track that has memo data stored is selected, the MEMO indicator lights in the display.

### 2 Press MEMO UTIL.

“Call” is shown in the display.

### 3 Turn SEL. to select “Clear”.

### 4 Press SEL.

The MEMO indicator in the display goes out, and the memo data is cleared.



Memo data can also be cleared in a batch using the utility mode. For details, see “Memo Area” – “Memo Delete” (page 46) in the utilities.

## ❑ Overwrite

Overwrites the memo data with the setting details.

### 1 In cue standby mode, press MEMO UTIL.

“Call” is shown in the display.

### 2 Turn SEL. to select “Overwrite”.

### 3 Press SEL.

The memo data is overwritten.

## Preset recall function

Using “Preset Export” (page 46), preset setting details saved on a USB memory device or HDD can be temporarily used without overwriting on this unit.

### 1 Connect the USB memory device or HDD that contains the preset to this unit.

“Preset Recall” is shown in the display.

### 2 Turn SEL. to select “OK”.

### 3 Press SEL.

The preset settings saved on the USB memory device or HDD connected to this unit are read.

- When the USB memory device or HDD is disconnected, this unit returns to the state before the preset settings were read.



# How to make detailed settings

## Utility menu map

For details on each setting item, see the pages in the table below.

Setting items	Detailed items	Description	Page
<b>Save As Def</b>		Saves the current pitch range settings, time display settings for the display, playback mode settings and key adjustment settings as the initial settings when the power is switched on.	44
<b>Preset Setting</b>	<b>Unit No.</b>	Sets the number of this unit that ASIO driver recognizes when connected to a computer.	44
	<b>Network ID</b>	Sets the number of this unit that "engine" recognizes when connected to the network.	44
	<b>Touch Adjust</b>	Adjusting the touch sensor sensitivity of the Jog wheel.	44
	<b>Fader Mode</b>	Switches the operation for fader start for the mixer connected to this unit.	44
	<b>Panel Contrast</b>	Sets the brightness of the display and buttons and touch sensor indicator.	44
	<b>Jog Contrast</b>	Sets the brightness of the jog wheel indicator.	44
	<b>Cue Mode</b>	Switches the cue point setting mode.	45
	<b>Auto Cue</b>	Sets the detection level of the sound start point when ignoring the soundless part at the head of a track at playback.	45
	<b>Power on Play</b>	Switches power on playback on or off.	45
	<b>Relay</b>	Switches relay playback on or off.	45
	<b>Auto Loop Cnt.</b>	Sets the space between point A (start point) and point B (end point) for auto loop playback.	45
	<b>Beat Point</b>	Selects whether to use the beat grid created by "engine".	45
	<b>Auto Memo Load</b>	Sets whether to automatically read memo data when memo data has been created for a playback track.	45
	<b>PC/MAC</b>	Sets the OS of the computer connected by USB to this unit.	45
	<b>MIDI CH</b>	Selects the MIDI channel to be used.	45
	<b>Hybrid MIDI Freq</b>	Sets the playback frequency mode for the time code information.	45
	<b>Hybrid MIDI LED</b>	Sets how the LED lights in Hybrid MIDI mode.	45
	<b>Jog Trans Int</b>	Sets the transmission interval for the JOG pulses from MIDI output.	45
	<b>Jog Ind. Color</b>	Sets the color of the jog wheel indicator light.	45
	<b>Eclipse Res.</b>	Sets the resolution for displaying the jog wheel indicator point (displaying the cue point/current playback location).	45
<b>BPM Range</b>	Sets the BOM width for BPM search.	45	
<b>EOM Time</b>	Sets the notification for the time remaining until the end of the track being played back.	46	
<b>iPad Connect</b>	Sets the iPad connection environment.	46	
<b>Preset I/O</b>	<b>Preset Import</b>	Imports the presets saved on a USB memory device or HDD onto this unit.	46
	<b>Preset Export</b>	Saves preset settings onto a USB memory device or HDD.	46
<b>Memo Area</b>	<b>Area Create</b>	Creates memo data on the USB memory device or HDD.	46
	<b>Area Delete</b>	Clears memo data created on the USB memory device or HDD.	46
<b>Initialize</b>	<b>USB Format</b>	Initializes the USB memory device or HDD connected to this unit.	46
	<b>Preset Init.</b>	Returns all of the preset settings to the default settings.	46
<b>Information</b>	<b>System Version</b>	Displays the firmware version for this unit.	46

# Utility settings

Select the utility setting items using the following operations.

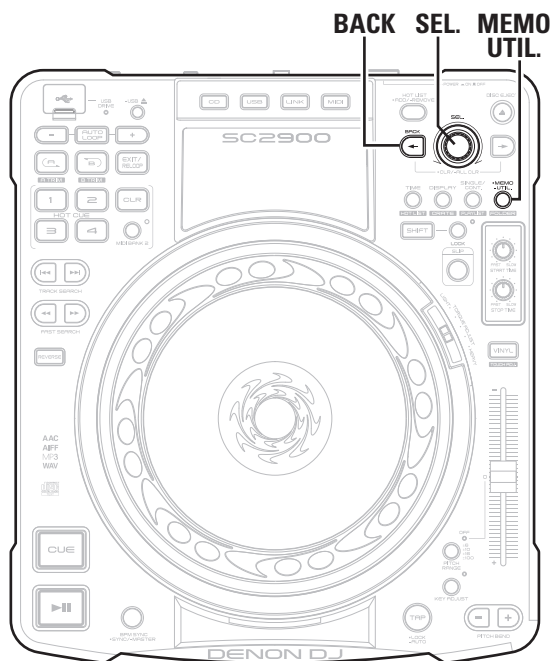

## Menu operation

**1** During standby, pause, or when a file is not selected, press and hold **MEMO UTIL.** **SEL.** flashes blue, "Utility" is shown in the 1st line, and "Save As Def." is shown in the 2nd line of the display.

**2** Turn **SEL.**, and select the items you want to set.  
Turn **SEL.**, and the item shown in the 2nd line of the display changes.

**3** Press **SEL.**  
The selected item is entered.

- To return to the previous item, press **BACK**.
- To exit Utility, when the utility is being displayed, press **MEMO UTIL.** The screen returns to the previous screen.

## Save As Def.

Saves the current pitch range settings (☞ page 28), time display settings for the display (☞ page 9), playback mode settings (☞ page 26) and key adjustment settings (☞ page 28) as the initial settings when the power is switched on.

### Setting details

**CANCEL** : The screen returns to the previous screen without saving the settings.

**OK** : The settings are saved and the screen returns to the previous screen.

## Preset Setting

Default settings are underlined



These settings are for unit operations or playback.

Setting items	Setting details
<b>Unit No.</b> Sets the number of this unit that ASIO driver recognizes when connected to a computer.	<u>1 - 14</u> <b>NOTE</b> When using multiple DENON DJ devices such as DN-SC2900, change this setting so that there are no duplicate numbers.
<b>Network ID</b> Sets the number of this unit that "engine" recognizes when connected to the network.	<u>1 - 4</u> <b>NOTE</b> If the same "Network ID" is used between different units, they cannot be connected on the network. If the same network IDs are duplicated, "SET ID >>>1 (duplicated "Network ID" number)" is displayed. Set a different "Network ID".
<b>Touch Adjust</b> Adjusting the touch sensor sensitivity of the Jog wheel (☞ page 32).	<u>Min/1/2/3/Max</u>
<b>Fader Mode</b> Switches the operation for fader start for the mixer connected to this unit.  Switch this setting to match the connected mixer.	<b>1L Play/Cue</b> : If the mixer is a 1-wire mixer, raise the fader to playback, or lower it for cue standby. <b>1L Play/Pause</b> : If the mixer is a 1-wire mixer, raise the fader to playback, or lower it to pause. <b>2L Play/Cue</b> : If the mixer is a 2-wire mixer, raise the fader to playback, or lower it for cue standby. <b>2L Play/Pause</b> : If the mixer is a 2-wire mixer, raise the fader to playback, or lower it to pause.
<b>Panel Contrast</b> Sets the brightness of the display and buttons and touch sensor indicator.	<u>0 - 4</u> : "0" is the brightest, and "4" is the darkest.
<b>Jog Contrast</b> Sets the brightness of the jog wheel indicator.	<u>0 - 4</u> : "0" is the brightest, and "4" is the darkest.

Setting items	Setting details
<b>Cue Mode</b> Switches the cue point setting mode (page 27).	<b>Standard</b> : Sets the cue point by the standard method used in general DJ products. <b>DENON</b> : Sets the cue point in the same way as conventional DENON DJ products.
<b>Auto Cue</b> Sets the detection level of the sound start point when ignoring the soundless part at the head of a track at playback.	<b>OFF/-60dB/-54dB/-48dB</b>  When set to "OFF", playback is started from the head of the track without skipping the soundless part.
<b>Power on Play</b> Switches power on playback (page 28) on or off.	<b>ON</b> : Power on playback is performed. <b>OFF</b> : Power on playback is not performed.
<b>Relay</b> Switches relay playback (page 34) on or off.	<b>ON</b> : When multiple DN-SC2900 units, are connected via a network, when a track or disc playback finishes, the next track is played back according to the "Network ID" number. <b>OFF</b> : Relay playback is not performed.  <b>NOTE</b> Tracks on units that are set to "OFF" cannot be played back.
<b>Auto Loop Cnt.</b> Sets the space between point A (start point) and point B (end point) for auto loop playback (page 30).	<b>1 Beat/2 Beat/4 Beat/8 Beat</b>
<b>Beat Point</b> Selects whether to use the beat grid created by "engine".	<b>ON</b> : Uses the beat grid created by "engine". <b>OFF</b> : Does not use the beat grid created by "engine".
<b>Auto Memo Load</b> Sets whether to automatically read memo data when memo data has been created for a playback track.	<b>ON</b> : Memo data is automatically read. <b>OFF</b> : Memo data is not automatically read.
<b>PC/MAC</b> Sets the OS of the computer connected by USB to this unit.	<b>PC</b> : Set when the computer connected by USB to this unit runs on Windows. <b>MAC</b> : Set when the computer connected by USB to this unit runs on Mac.

Setting items	Setting details
<b>MIDI CH</b> Selects the MIDI channel to be used.	<b>1 – 16</b>
<b>Hybrid MIDI Freq</b> Sets the playback frequency and LED mode for the time code information. Select the frequency according to the DJ software used.	<b>Scratch Live*/2kHz/2.5kHz/1.2kHz/3kHz</b>
<b>Hybrid MIDI LED</b> Sets how the LED lights in Hybrid MIDI mode. When using DJ software that cannot light the LED, button positions can be easily found even in dark places when the LED is left on continually.	<b>Normal/Always Lit</b>
<b>Jog Trans Int</b> Sets the transmission interval for the JOG pulses from MIDI output.	<b>1ms – 3ms – 10ms</b>
<b>Jog Ind. Color</b> Sets the color of the jog wheel indicator light (page 27).	<b>Positive BLUE</b> : On the jog wheel indicator, the playback point lights red, the cue point lights purple, and the back ground lights blue. <b>Positive RED</b> : On the jog wheel indicator, the playback point lights blue, the cue point lights purple, and the back ground lights red. <b>Positive PURPLE</b> : On the jog wheel indicator, the playback point lights blue, the cue point lights red, and the back ground lights purple. <b>Negative BLUE</b> : On the jog wheel indicator, the playback point lights blue, the cue point lights red, and the Back ground is dark. <b>Negative RED</b> : On the jog wheel indicator, the playback point lights red, the cue point lights blue, and the back ground is dark. <b>Negative PURPLE</b> : On the jog wheel indicator, the playback point lights purple, the cue point lights blue, and the back ground is dark.
<b>Eclipse Res.</b> Sets the resolution for displaying the jog wheel indicator point (displaying the jog wheel indicator point (displaying the cue point/current playback location).	<b>LED - 48</b> : Sets 48 for the resolution for displaying the jog wheel indicator point (displaying the cue point/current playback location). <b>LED - 96</b> : Sets 96 for the resolution for displaying the jog wheel indicator point (displaying the cue point/current playback location).
<b>BPM Range</b> Sets the BPM width for BPM search.	<b>0/3/5/10</b>

\* Scratch Live is a registered trademark of Serato Audio Research.

Setting items	Setting details
<b>EOM Time</b> Sets the notification for the time remaining until the end of the track being played back.	<b>OFF/10sec/20sec/30sec/40sec/50sec/60sec</b>  The playback position indicator flashes when the set remaining time is exceeded.
<b>iPad Connect</b> Sets the iPad connection environment.	<b>Disable</b> : Connection to the iPad is disabled. <b>Enable</b> : Connection to the iPad is enabled. Enter the Connect ID when connecting to the iPad. <b>Auto</b> : Connection to the iPad is enabled. Only enter the Connect ID the first time the iPad is connected. Login is performed automatically from subsequent connections.  Even if multiple DN-SC2900 units, are connected via the network, the iPad is connected just by entering the Connect ID once.

## Preset I/O

Presets are saved and read from a USB memory device or HDD connected to this unit.



Setting items	Setting details
<b>Preset Import</b> Imports the presets saved on a USB memory device or HDD onto this unit.	<b>CANCEL</b> : Presets are not read. <b>OK</b> : Imports the presets saved on a USB memory device or HDD onto this unit, and overwrites the settings.
<b>Preset Export</b> Saves preset settings onto a USB memory device or HDD.	<b>CANCEL</b> : Does not save presets. <b>OK</b> : Saves presets onto a USB memory device or HDD.



The setting contents of presets saved to a USB memory device or HDD using "Preset Export" can be temporarily read without being saved on this unit (☞ page 42 "Preset recall function").

## Memo Area

Create memory areas and clear memo data.

Setting items	Setting details
<b>Area Create</b> Creates a memo area for saving memo data.	<b>CANCEL</b> : Memo area is not created. <b>OK</b> : Memo area is created.  Connect a USB memory device or HDD to this unit in advance.
<b>Area Delete</b> All saved memo data is cleared.	<b>CANCEL</b> : Memo data is not cleared. <b>OK</b> : Memo data is cleared.  Just specific memos can be cleared. For details, see "Memo Clear" (☞ page 42).

## Initialize

Initializes the USB memory device or HDD connected to this unit and returns the preset settings of this unit to the default settings.

Setting items	Setting details
<b>USB Format</b> Initializes the USB memory device or HDD connected to this unit.	<b>CANCEL</b> : Initialization is not performed. <b>OK</b> : Initialization is performed. <div style="border: 1px solid black; border-radius: 10px; padding: 2px; display: inline-block; margin-top: 5px;"><b>NOTE</b></div> <ul style="list-style-type: none"> <li>When initialization is performed, all data on the USB memory device and HDD is deleted.</li> <li>HDDs up to 2 TB in size can be formatted using this unit. Larger HDDs are not supported.</li> </ul>
<b>Preset Init.</b> Preset settings on this unit are returned to the default settings.	<b>CANCEL</b> : Settings are not returned to the default settings. <b>OK</b> : Settings are returned to the default settings.

## Information

Shows information about this unit.

Setting items	Setting details
<b>System Version</b> Displays the firmware version for this unit.	 When the firmware version is being displayed, press <b>SEL.</b> to return to the previous screen.

# Troubleshooting

If a problem should arise, first check the following:

1. Are the connections correct?
2. Is the set being operated as described in this owner's manual?
3. Is the external device (DJ mixer, player or effects processor) operating correctly?

If this unit does not operate properly, check the items listed in the table below.

If the symptom is not covered on the check list, contact your dealer or service centers.

Service centers are listed at <http://www.d-mpro.com> or <http://www.denondj.com>.

Symptom	Cause/Solution	Page
Disc cannot be inserted into the loading slot.	<ul style="list-style-type: none"> <li>• Check that the power is on.</li> <li>• If a disc is already inserted, remove that disc before inserting a new one.</li> </ul>	21 –
Cannot eject disc.	<ul style="list-style-type: none"> <li>• Check that the power is on.</li> <li>• Discs cannot be ejected during playback. Stop playback before ejecting the disc.</li> </ul>	21 21
"Disc Error" is displayed.	<ul style="list-style-type: none"> <li>• The disc may be dirty or scratched. Either clean the dirt from the disc, or replace with another disc.</li> </ul>	–
Power does not turn on.	<ul style="list-style-type: none"> <li>• Check that the plug is inserted correctly into the wall socket, and that the power cord is inserted into this unit.</li> </ul>	19
This unit does not operate properly, or there is no sound.	<ul style="list-style-type: none"> <li>• Check the connections for all devices.</li> </ul>	17 – 19
	<ul style="list-style-type: none"> <li>• Check that the volume settings for the connected devices and DJ software on the computer are properly adjusted.</li> </ul>	–
	<ul style="list-style-type: none"> <li>• Match the settings on the unit to those on DJ software.</li> </ul>	–
	<ul style="list-style-type: none"> <li>• Check the file sampling frequency. Only files with a sampling frequency of 44.1 kHz can be played on this unit.</li> </ul>	–
There is no sound. Or the sound is distorted.	<ul style="list-style-type: none"> <li>• When other USB devices are connected to the computer, connect only the unit to the computer and check if this works.</li> </ul>	–
	<ul style="list-style-type: none"> <li>• Check the mixer connections.</li> <li>• The mixer adjustments or switching may be unsuitable. Adjust the knobs on the mixer.</li> </ul>	17 – 19 –
There is no sound. Or the sound is too quiet.	<ul style="list-style-type: none"> <li>• Check the connections for all devices.</li> <li>• Switch the input source switching button to the device that is currently playing.</li> </ul>	17 – 19 21

Symptom	Cause/Solution	Page
Sound cuts out. Or the sound is distorted.	<ul style="list-style-type: none"> <li>• Exit any other applications.</li> </ul>	–
	<ul style="list-style-type: none"> <li>• When multiple WAV files are played back simultaneously, the playback sound may cut out depending on the computer specifications. Try playing back 1 WAV file.</li> </ul>	–
Button or display illumination is too dark.	<ul style="list-style-type: none"> <li>• Check the settings in "Utility" – "Preset Setting" – "Contrast".</li> </ul>	44
"Fail" is displayed.	<ul style="list-style-type: none"> <li>• When saving memo data, connect a USB memory device or HDD to this unit.</li> </ul>	40
	<ul style="list-style-type: none"> <li>• If the USB memory device or HDD is equipped with a security function, check that the security is disabled.</li> </ul>	–
	<ul style="list-style-type: none"> <li>• Memo data cannot be saved on a USB memory device or HDD formatted in HFS+ format. Use FAT16 or FAT32 format.</li> </ul>	40

# Specifications

## □ Audio

	(0 dBu =0.775 Vrms, 0 dBV =1 Vrms)
<b>Quantization:</b>	32 bit (internal DSP process)
<b>Sampling frequency:</b>	44.1 kHz (at normal pitch)
<b>Total harmonic distortion:</b>	0.05 % or less
<b>Signal to noise ratio:</b>	106 dB or more
<b>Head room</b>	6 dB
<b>Channel separation:</b>	100 dB or more
<b>Frequency response:</b>	20 – 20 kHz, ±0.5 dB
• <b>Analog output</b>	
<b>Output level:</b>	2.0 Vrms
• <b>Digital output</b>	
<b>Output level:</b>	0.5 Vp-p 75Ω

## □ Functions

<b>Instant start:</b>	Within 20 msec.
<b>Variable pitch:</b>	±6 % (0.02 % pitch) ±10 % (0.05 % pitch) ±16% (0.05 % pitch) ±100 % (0.5 % pitch)
<b>Pitch bend:</b>	Pitch range ±6 % – ±16 % : ±32 % Pitch range ±100 % : –99 % – +100 %
<b>Search precision:</b>	1/75 sec.
<b>Folder search</b>	9 layers (including root folder)

## □ General

<b>USB MIDI input/output</b>	IN : 1 ch, OUT : 1 ch MIDI 1.0, USB B
<b>Power supply:</b>	
<b>U.S.A. and Canada models:</b>	AC 120 V, 60 Hz
<b>European,U.K. and Asia/Pacific models:</b>	AC 230 V, 50 Hz
<b>Power consumption:</b>	30 W
<b>Operational temperature:</b>	+5 °C – +35 °C
<b>Operational humidity:</b>	25 % – 85 %
<b>Storage temperature:</b>	–20 °C – +60 °C

For the purpose of improvement, the specifications and design are subject to change without notice.

# Index

<b>A</b>		<b>E</b>		<b>N</b>		<b>S</b>	
AC cord holder .....	19	Eclipse Res. ....	45	Network ID .....	44	Save As Def. ....	44
Area Create .....	46	EOM Time .....	45			Scratch playback .....	31
Area Delete .....	46			<b>P</b>		Searching .....	24
ASIO Driver .....	12, 14	<b>F</b>		Panel Contrast .....	44	SLIP function .....	32
Auto BPM counter .....	31	Fader Mode .....	44	Pause .....	26	System Version .....	46
Auto Cue .....	45	Fast forward/Rewind .....	26	PC/MAC .....	45		
Auto Loop Cnt. ....	45	Finalization .....	4	Pitch bend function .....	28	<b>T</b>	
Auto loop playback .....	30	Front panel .....	11	Playback .....	26	Top panel .....	5
Auto Memo Load .....	45			CD .....	20	Torque Adjust .....	32
		<b>H</b>		CD-R .....	21	Touch Adjust .....	32, 44
<b>B</b>		Hot cue playback .....	30	CD-ROM .....	21	TRAKTOR LE 2 .....	7, 10, 15
Beat Point .....	45	Hot list .....	31	CD-RW .....	21	Turning the power off .....	20
BPM .....	31			HDD .....	22	Turning the power on .....	20
BPM Range .....	45	<b>I</b>		Network .....	23, 33		
BPM SYNC function .....	34	Information .....	46	USB memory device .....	22	<b>U</b>	
		Initialize .....	46	Playback mode .....	26	Unit No. ....	44
<b>C</b>		iPad Connect .....	45	Playback speed .....	28	USB Format .....	46
Cable				Power on Play .....	45	Utility .....	44
Coaxial cable .....	17	<b>J</b>		Power on playback .....	28		
Ethernet cable .....	17	Jog Contrast .....	44	Preset Export .....	46		
RCA cable .....	17	Jog Ind. Color .....	27, 45	Preset Import .....	46		
Stereo mini cable .....	17	Jog Trans Int .....	45	Preset Init. ....	46		
USB cable .....	17			Preset I/O .....	46		
CD-R/CD-RW .....	4	<b>L</b>		Preset recall function .....	42		
Connection		Loop point .....	29	Preset Setting .....	44		
Computer .....	18, 19			<b>R</b>			
DJ mixer .....	17, 18, 19	<b>M</b>		Rear panel .....	11		
HDD .....	17, 18	Manual loop playback .....	29	Relay .....	45		
Power cord .....	19	Memo Area .....	46	Relay playback .....	34		
USB memory device .....	17, 18	Memo function .....	40	Reverse playback .....	32		
Cue Mode .....	45	MIDI CH .....	45				
Cue point .....	27	MIDI command .....	35, 36				
		MIDI layer .....	35				
<b>D</b>		Music CDs .....	4				
Display .....	9						

# Dimensions

Unit: in. (mm)

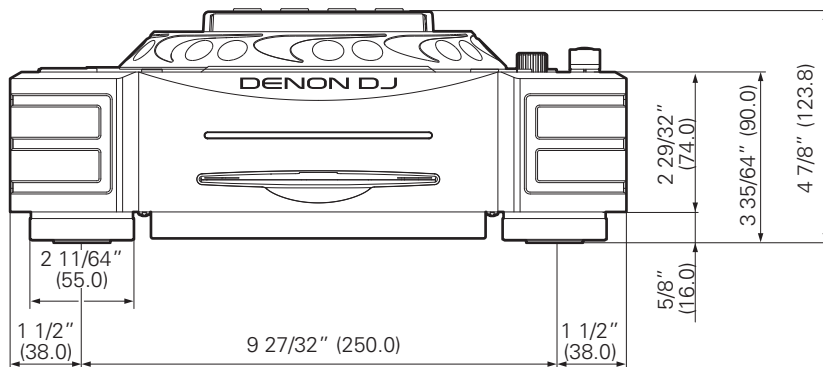
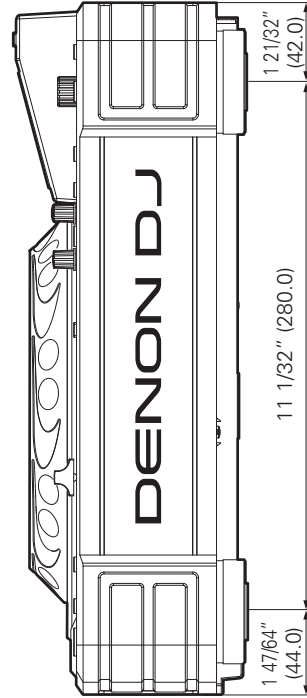
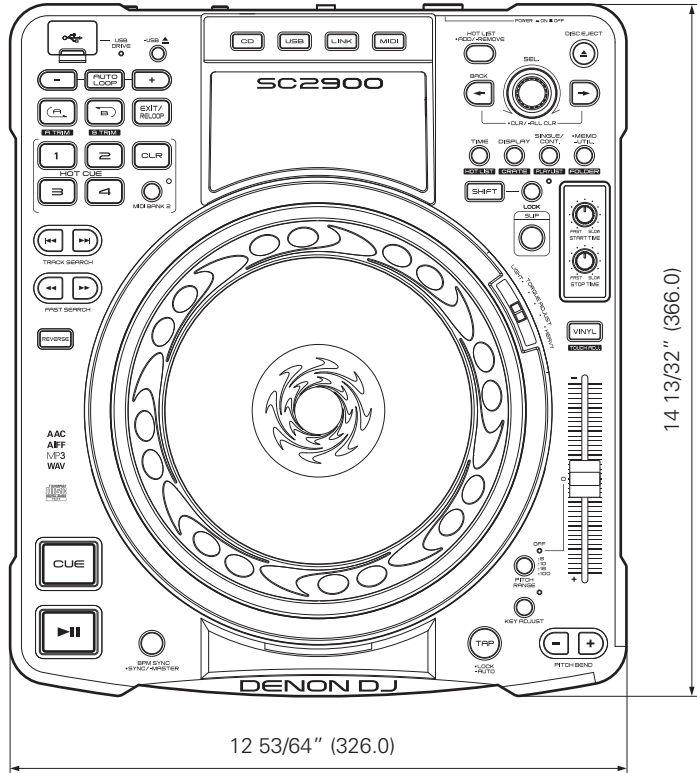

**Weight: 9 lbs 9.4 oz (4.35 kg)**

Getting started
Part names and functions
Preparations
Connection
Playback
MIDI Control
Others
Settings
Troubleshooting
Specifications
Index



D&M Holdings Inc.