

## IMPORTANT SAFETY INSTRUCTIONS



1. Read these instructions.
2. Keep these instructions.
3. Heed all warnings.
4. Follow all instructions.
5. Do not use this apparatus near water.
6. Clean only with dry cloth.
7. Do not block any ventilation openings.
8. Do not install near any heat sources (radiator, heat registers, stoves or other apparatus (including amplifiers)) that produce heat.
9. Only use attachments/accessories specified by the manufacturer.
10. Use only with the cart, stand, tripod, bracket or table specified by the manufacturer, or sold with the apparatus. When a cart is used, use caution when moving the cart/apparatus combination to avoid injury from tip-over.
11. Refer all servicing to qualified personnel. Servicing is required when the apparatus has been damaged in any way, such as power-supply cord or plug is damaged, liquid has been spilled or objects have fallen into the apparatus, the apparatus has been exposed to rain or moisture, does not operate normally, or has been dropped.
12. Do not cover the dissipation heat sink. Leave space around the amplifier to ensure a good ventilation.
13. The apparatus shall not be exposed to dripping or splashing and no objects filled with liquids, such as vases, shall be placed on the apparatus.
14. No naked flame sources, such as lighted candles, should be placed on the apparatus.
15. Remove the battery during transportation.



## ONEFORSTREET

*is a product entirely  
designed and produced in Italy  
by*

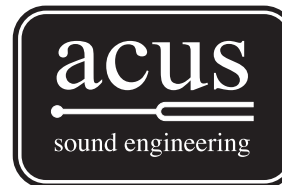

### ACUS SOUND ENGINEERING SRL

Via Cupa Madonna di Varano, 8 - 62019 Recanati (MC) - Italy  
Tel. +39 071 9793109  
[www.acus-sound.it](http://www.acus-sound.it) - [info@acus-sound.it](mailto:info@acus-sound.it)

Bluetooth name and logo are properties of their respective owners.  
Makita name is the property of the respective owner.  
All brand name and trademarks are properties of their respective owners.

## QUICKSTART GUIDE

# ONEFORSTREET 5

LIGHT

LIVE

LASTING

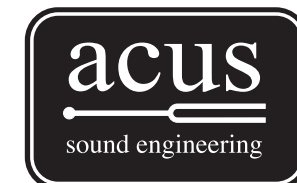
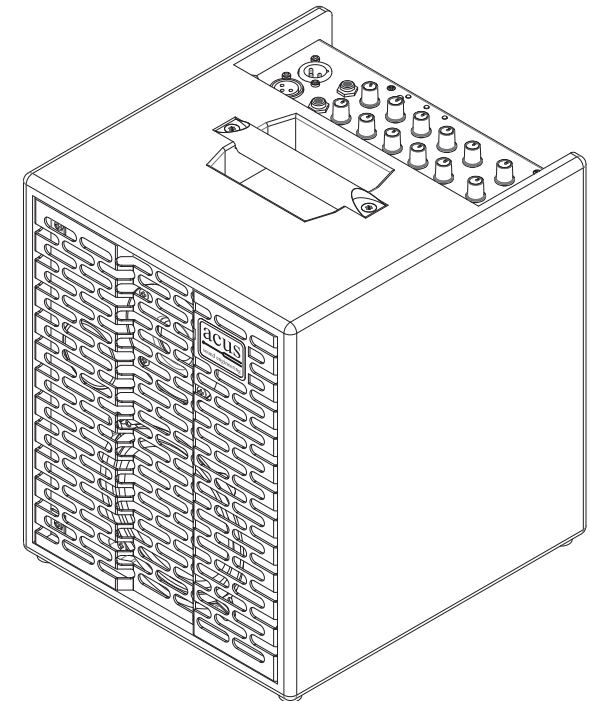

MADE IN ITALY

## TECHNICAL INFORMATION

Frequency Response:	50Hz - 20kHz
Max Power Out:	40W
System Format:	2 way Amp
Woofer Power:	30W
Tweeter Power:	10W
Construction:	Brich Plywood Cabinet
Weight:	7 kg
Dimensions (WxHxD)	253x305x280 mm



### N.B.

For more information you can download the complete ONEFORSTREET 5 manual from the company web site.

## POWER SUPPLY

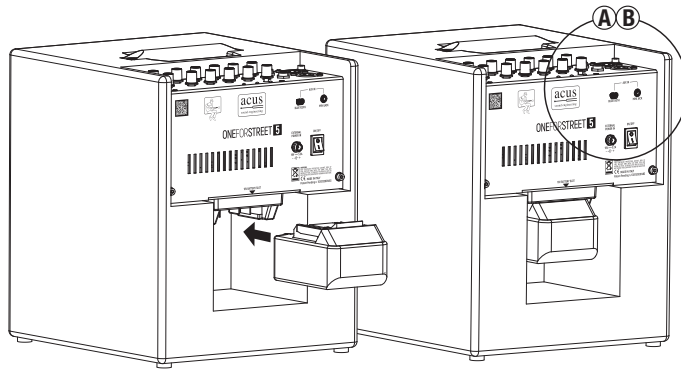

ONEFORSTREET 5 is not equipped with an inner power supply system. Is possible to power it with 2 types of source:

1. Battery (not included): insert the battery in the dedicated sled.
2. External Power Supply (included): connect the power supply to the relative connector.

### COMPATIBILITY:

ACUS Sound Engineering SRL suggest the use of MAKITA 18V- 3 or 5 Ah.

### BATTERY POWERING:

The system has 4 operative status:

1. Battery Full: Battery Status LED (9) is OFF
2. Slightly Discharged Battery Status: Battery Status LED (9) starts to flash. In this status the LED ON Time is about 1/3 of LED Time OFF.
3. Very Low Battery Status: Battery Status LED (9) ON Time is the same of Time ON.
4. Completely Discharged Battery Status: Battery Status LED (9) is always ON and the system stops to work. In this status is necessary to replace the battery with another one full.

### WARNING:

1. Is important to recharge the battery as soon as possible.
2. Avoiding to let the ON/OFF Switch (14) when the system is not used because the system continues to absorb energy.
3. Avoid to let a totally discharged battery inserted because the system absorbs a very little quantity of energy even with the ON/OFF Switch in the OFF position, and this fact (for a long time) will put the battery in a very low discharged status, reducing the battery life.

### EXTERNAL POWER SUPPLY POWERING.

The system works always in "Battery Full" status, so Battery Status LED (9) is always OFF.

### WARNING:

Is not possible to recharge a battery with the amplifier power supply.

## TOP SECTION

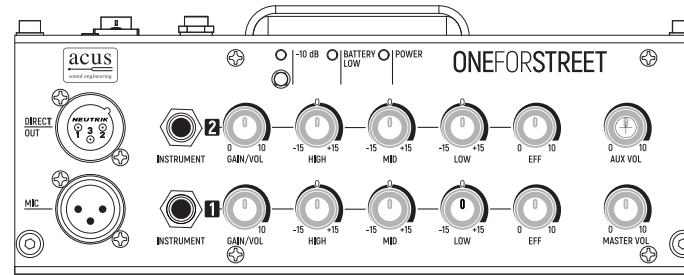

1. **MIC IN** with 1kΩ of Impedance. You can connect any type of microphone on it, even Condenser Microphone (this input is equipped with a Phantom power, always Active).
2. **INSTRUMENT IN** with 110kΩ of Impedance. You can connect any type of Instrument on it. This input doesn't exclude the MIC IN (1).
3. **GAIN / VOL**: this knob permits to regulate the gain and the volume of the system (its range is from -∞ to +20dB). Moving this knob to the minimum (0 position) puts the volume of the channel to 0. Moving it to the maximum (10 position) put the signal level to +20dB.
4. **HIGH - MID - LOW**: 3 band EQ with a dynamic from -15dB to +15dB.
5. **EFF**: channel Effect Level. The system is equipped with a fixed length Reverb. With this knob is possible to regulate this Reverb Level for the channel
6. **MASTER VOL**: Master Volume of the system.
7. **AUX VOL**: AUX IN (12) Inputs Volume.
8. **Power**: LED for indicating if the system is ON (Led ON) or OFF.
9. **Battery status**: LED for indicating the External Battery Status.
10. **-10dB**: pushing this switch will reduce the DIRECT OUT (11) signal level of 10dB. This attenuation condition is indicated with a LED.
11. **DIREC OUT**: balanced output for connecting the system with an External System.

## REAR SECTION

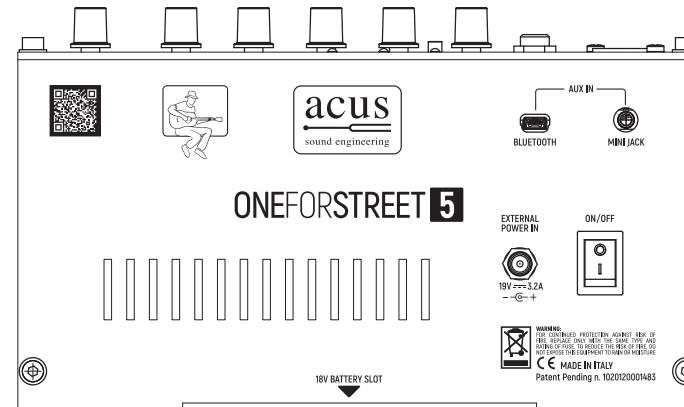

12. **AUX IN**: section with 2 Inputs: a 3.5mm Jack and a mini-USB for Acus Artesia BT-1 device. Both inputs are controlled with AUX VOL (7) knob.
13. **EXTERNAL POWER IN**: connector for the External Power Supply (Included).
14. **ON/OFF**: Power Switch for Turning-ON / OFF the system.
15. **18V BATTERY SLOT**: slot connection for powering the system with the external battery (not included).

## SMART ACCESSORIES



### ACUS Artesia BT-1

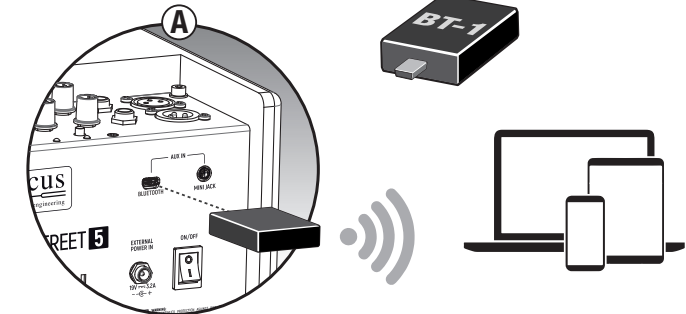

1. Make sure that the amplifier is powered off and connect the ACUS Artesia BT-1 Bluetooth Receiver to mini-USB AUX IN connector.
2. Turn the amplifier on. The ACUS Artesia BT-1 Bluetooth Receiver blue LED indicator lamp should flash quickly. This lasts for about 5 seconds. Then it will flash again every 7 seconds until it matches (or pair) successfully with another Bluetooth device.
3. After it has matched successfully, find ACUS Artesia BT-1 as an option on your Bluetooth Device's Settings and then select it to connect.
4. When the blue LED Indicator lamp on the ACUS Artesia BT-1 Bluetooth Receiver is ON steady with no flashing, then the two devices have been successfully connected.

### ACUS Artesia LS-1 - TRRS ADAPTER for your live streaming

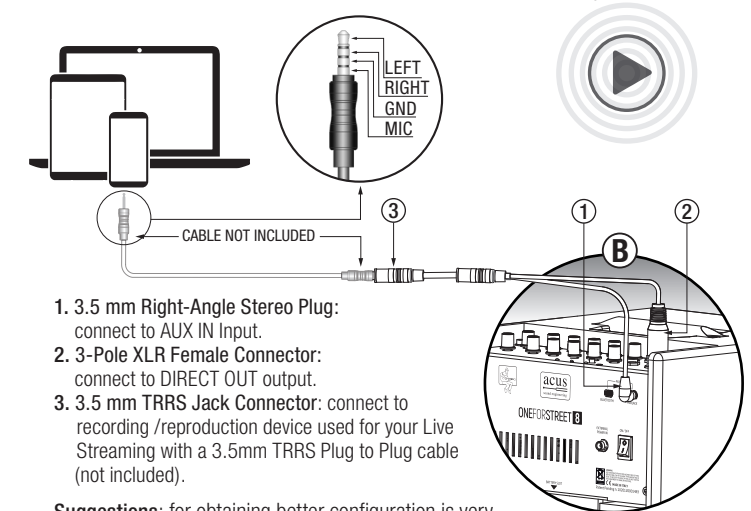

1. **3.5 mm Right-Angle Stereo Plug**: connect to AUX IN Input.
2. **3-Pole XLR Female Connector**: connect to DIRECT OUT output.
3. **3.5 mm TRRS Jack Connector**: connect to recording /reproduction device used for your Live Streaming with a 3.5mm TRRS Plug to Plug cable (not included).

**Suggestions:** for obtaining better configuration is very important to have a moderate volume to the amplifier DIRECT OUT output. If the amplifier is equipped with the attenuation switch (labeled with -10dB) push this switch for a very easy and fast signal level matching. If the amplifier is not equipped with this switch, for best configuration please reduce all channel volume more than half and then regulate the amplifier master volume for obtaining the right sound to the speaker.