

# FLOOR BOARD

Line 6 Part No. 40-00-0020 Rev. G

## Operations Guide

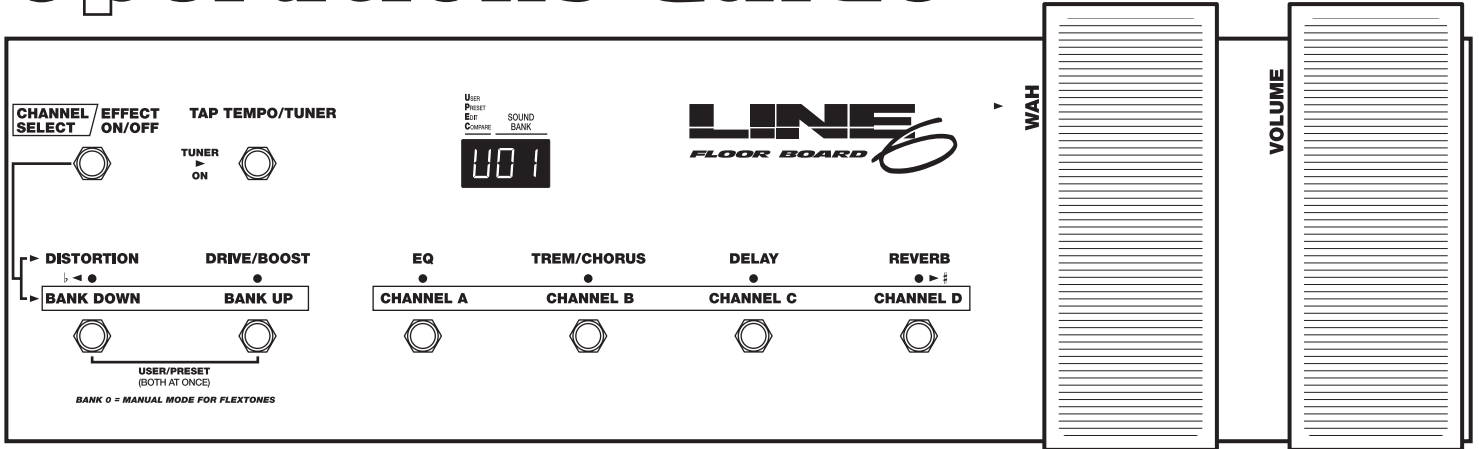

Congratulations on your purchase of the Floor Board—dedicated remote control pedal for Line 6 Digital Guitar Amplifier Systems.

### Care and Feeding

When moving your Floor Board around, always grab it by the edges of the main body's metal work; do not lift up the Floor Board by the pedals. You can clean the Floor Board with a damp (not wet) cloth. If you own an AX2 or AxSys, you will find that the Floor Board is sized to fit into the back of the amp, and if you put it in with the pedals and buttons facing toward the back of the amp, the speaker magnets will hold on to the Floor Board's flat steel bottom panel.

### Getting Connected

The Floor Board is designed exclusively for use with Line 6 Digital Guitar Amplifier Systems. Do not attempt to connect the Floor Board to any other product. Your Floor Board connects to the Digital Guitar System with the included locking cable. This cable allows the Floor Board and Digital Guitar Amplifier System to communicate, and also supplies the Floor Board with power; there is no separate power cord needed for the Floor Board.

#### Rear of Floor Board:



One end of the cable connects here...

...and the other end connects here.

#### Rear of Digital Guitar Amplifier System (AX2 shown here):

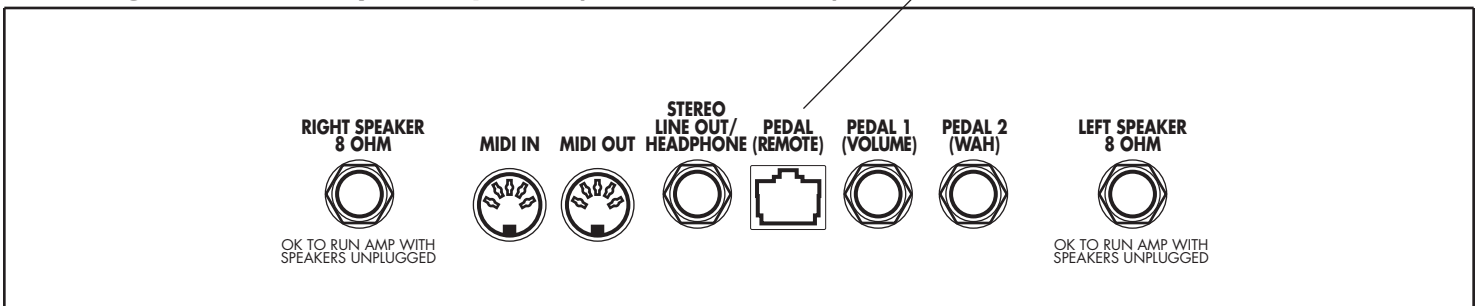

### Cable Specifications

The cable that connects the Floor Board is a standard cable used in the computer industry for connecting networks of computers. We chose this type of cable for the Floor Board because (1) it can carry multiple signals simultaneously, allowing it to transport both power and communications between the Digital Guitar Amplifier System and the Floor Board, eliminating the need for multiple tangled cables or a bulky wall wart; (2) it gives you locking connectors on both ends to insure you don't disconnect from the Digital Guitar Amplifier System or Floor Board by accident when you're jumping up and down on your Floor Board; (3) it has a proven track record for reliability in millions of computer installations around the world; (4) replacement cables are available in a variety of lengths and at low cost at any major computer supply store.

When purchasing a replacement cable, you should specify a:

**Category 5 - 10 Base-T or RJ-45 cable with male connectors on both ends.**

There is a 1 to 5 grading system for computer network cable quality, with 5 being the highest quality. Get the good one.

The connectors on the end of the cable are called RJ-45 connectors; these are the standard type of connector used for 10 Base-T computer networks. So asking for "a 10 Base-T cable" or for "an RJ-45 cable" should get you what you need.

If you're unsure if you've got the right thing, note that the RJ-45 connectors basically look like a wide version of standard US telephone line connectors, with 8 contacts instead of 4.

555 St. Charles Drive, Suite 100, Thousand Oaks, CA 91360  
voice: 805 379-8900  
fax: 805 379-3001  
email: sales@line6.com support@line6.com

**LINE**  
www.line6.com

# How to operate your Floor Board

The Floor Board lets you choose channels on the Digital Guitar Amplifier System, turn individual effects on and off, control the volume and wah pedal functions, operate the tuner, and tap in a tempo for your delay times (tap tempo can also set other effects' speeds if you're using a Flexitone or POD series system).

## Two Modes

When used with Line 6 guitar products, the Floor Board has two main modes of operation: **Channel Select** or **Effect On/Off**; step on this switch to switch between the two modes. **For the Bass POD, this switch acts directly as an effect on/off switch, and there is no separate effects on/off mode.**

### Tuner

Hold down this switch for **at least one second** to enter the tuner mode. Press any switch (including this one) to exit tuner mode. The red lights above the six lower stomp switches show if you are sharp or flat, and the display shows which note you are tuning to. The basic idea is that the lights to the left glow if you're flat, and the lights to the right glow if you're sharp. When you get a note in tune, the two center lights will be lit up at the same time.

See your Digital Guitar Amplifier System's manual for more details on tuning.

### Tap Tempo

This works just like the Tap Tempo button on your Digital Guitar Amplifier System. Tap tempo is always available if you're not in tuner mode.

See your Digital Guitar Amplifier System's manual for details.

### Volume Pedal

The volume pedal gives you foot control over the volume of your Channels.

With an AX2 or AxSys, a Channel can be programmed to respond to the volume pedal before or after the guitar signal reaches the preamp section. If the volume pedal doesn't seem to be affecting the volume of your Channel as you would like it to, you probably have to change the Channel's settings for the volume pedal on the AX2. **The volume pedal will have no effect if a Channel's Volume Pedal On/Off setting is "OFF" on the Comp/Pedals row of the Edit Matrix.**

See your Digital Guitar Amplifier System's manual for details on volume pedal operation.

### Wah Pedal

The wah pedal has an on/off switch under the toe of the pedal. Press down on the toe of the pedal to turn the wah effect on or off. The red arrow light to the left of the pedal lights when the wah is on.

With an AX2 or AxSys, the wah pedal can be used to control other effect parameters also.

See your Digital Guitar Amplifier System's manual for more details on wah pedal operation.

These light up arrows indicate which mode is selected:  
**Effect On/Off**  
or **Channel Select**.

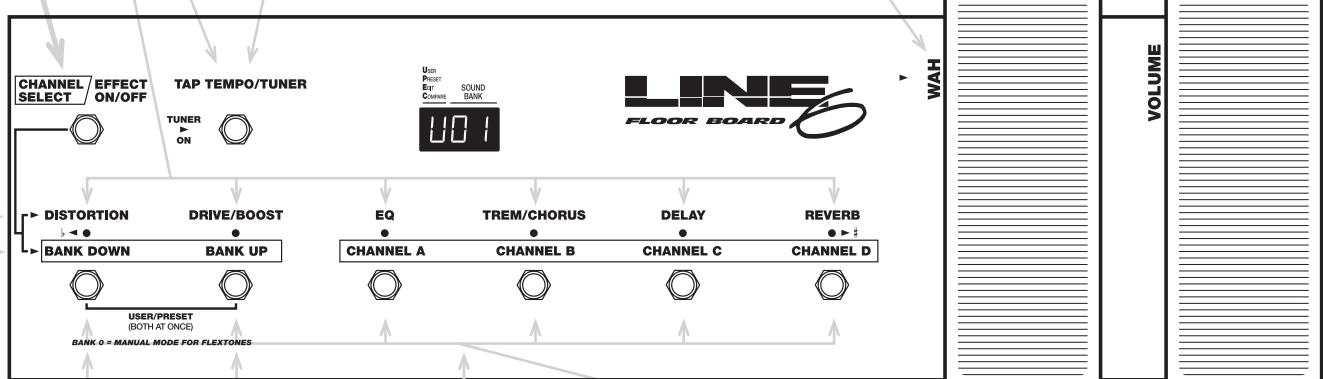

### Bank Select

While in **Channel Select** mode, use these switches to change between Channel banks of the Digital Guitar Amplifier System.

You must press one of the four switches to the right (Channel A, B, C, or D) to actually change to a new Channel in the bank that you select here.

See your Digital Guitar Amplifier System's manual for details on Banks and Channel selection.

PLUS

### User/Preset Bank Select

Press both these switches at once to switch between User and Preset Channel Banks of an AX2 or AxSys when the Floor Board is in **Channel Select** mode.

AND

### Flexitone and POD Manual Mode

If you're using a Flexitone or POD, you can activate **Manual** mode by holding down the channel select switch for the currently selected channel in any bank for at least two seconds.

See your Flexitone or POD manual for details on **Manual** mode.

### Individual Effects On/Off

While in **Effects On/Off** mode, use these switches to turn on and off individual Digital Guitar System effects. The LEDs above the switches light up to show the particular effects that are on. The names above the LEDs show which switch controls which effect.

When you press one of the effect on/off switches, the display shows an "E" next to the Bank number to indicate that you have edited your channel.

Be sure to note that if you store a Channel after you've turned effects on and off, the new setup of effects will be stored with that Channel.

Your stored Channels will not be affected if you turn some effects on or off with these switches, but then do not store the changes before selecting a new Channel.

See your Digital Guitar Amplifier System's manual for details on setting up effects and storing and editing Channels.

**Please refer to your Digital Guitar Amplifier System's manual for more details on channels, effects, tuner functions, etc.**