

PRODUCT OVERVIEW

The TASCAM CD-RW900 builds on the success of the best-selling CD-RW700 and 750 CD Recorders. It adds pitch and key original controls, allowing CDs to be played at a faster or slower speed without changing the pitch. MP3 playback is now standard, making this the ultimate affordable CD recorder and player for professional applications and commercial installations.



FEATURES

- 2U rackmount design
- $\pm 16\%$ pitch control in 0.1% steps (CD audio discs only)
- MP3 Audio playback
- Key control (CD audio discs only)
- Dedicated analog input level controls
- Digital input level control
- Fade in/fade out recording features
- PS/2 keyboard input
- Auto track increment by level with trim function
- Sample rate converter
- Un-finalize for CD-RW
- All, single, program, random play and repeat play modes
- Power-on play
- CD Text and MP3 ID3 tag display
- Unbalanced RCA inputs and outputs
- Coax and Optical S/PDIF digital inputs and outputs
- Wireless remote control

APPLICATIONS

The CD-RW900's feature set is complete enough for many high-end applications, yet the machine is affordable enough for the average user:

Production Studio

Whether installed in a home project studio or a professional commercial studio, the CD-RW900 offers simple, reliable CD recording from analog or digital sources. It's ideally suited to recording a CD master of music or voiceover program in a studio environment.

Installed Sound Recording

The CD-RW750 was a staple in house-of-worship installations, and the CD-RW900 is the latest version of that affordable, reliable workhorse recorder. Corporate meetings, concert events and worship services can easily be recorded to CD, with new track IDs entered from the record button or when the signal drops below a certain level. A PS/2 keyboard input is provided so tracks can be named during recording.

CD and MP3 Playback

In cases where CD recording is an occasional requirement, the CD-RW900 is an exceptional CD player as well. It features a list of CD and MP3 playback modes, including reading ID3 tags and directories of MP3 files. Pitch and key are adjustable, so CDs can be played at a faster tempo without the "chipmunk" effect of changing the pitch.

THE CD-RW900 ADVANTAGE

Rugged reliability, ease-of-use and affordability are tenets of the TASCAM CD recorder lineup. When a CD recorder absolutely needs to be relied on, TASCAM rackmount products remove all doubt from installers, studio owners and resellers who stake their reputation on their installations. TASCAM's CD-RW900 offers the best performance, features and quality at any price point:

Sample Rate Conversion – Since audio CDs must be recorded at 44.1kHz, the CD-RW900 offers sample rate conversion for the digital input. This allows a 48kHz recording session from a digital console, computer DAW system or DAT recorder to be recorded to CD without converting to analog and back to digital. Naturally, the converter can be defeated for a pure digital signal path for digital signals that don't need conversion.

Digital Level Adjustment – The digital signal input of the CD-RW900 can be adjusted as easily as the analog signal level.

Fade In/Fade Out Recording – At the beginning or end of a live event recording or music mix, the signal can be brought up or down with the touch of a button for a smooth, perfect level fade.

PS/2 Keyboard Input – The keyboard input allows the user to name tracks while recording. It also provides keyboard shortcuts to commonly-used recording functions.

MP3 Playback – A CD-R disc can hold hours of MP3 files for playback through the CD-RW900. It allows the user to play MP3s in directory folders and displays the ID3 text information on the MP3 files.

Pitch Control – CD audio discs can be played at $\pm 16\%$ speed for health clubs and other applications

Key Control – This function allows you to change the speed of the CD without changing the pitch.

APPROVED MEDIA LIST

Notes on CD-R Media: Quality and recording characteristics of media from different manufacturers will vary from brand to brand. This has to do with the manufacturing processes of both the CD-R media and CD-R mechanism. Some media that does not work well with one CD-R mechanism may work reasonably well with another.

In order to take the guesswork out of selecting media, we are posting an approved list of media for use with the CD-RW900. At the time of this writing, media from each of these manufacturers was written to and verified.

CD-R / CD-R-DA approved manufacturers:

Sony, TDK, Taiyo Yuden, AMT, CMC, Ritek, Prodisc, Mitsubishi Chemical

CD-RW / CD-RW-DA approved manufacturers:

Sony, Ritek, Prodisc, AMT, CMC, Ricoh, Mitsubishi Chemical.

High-speed media is approved for use, meaning that the unit is not limited to 1x speed media.

MENU STRUCTURE OF THE CD-RW900

This quick reference chart lists the menu structure of the CD-RW900:

Menu Option	Sub-Menu option	Function
PITCH	PLAY MODE	Playback mode setting
	PITCH	Pitch control mode on/off
	PITCH CONT	Pitch control setting
	PITCH STEP	Pitch control variable pitch
	KEY	Key control mode on/off
	KEY LEVEL	Key control level setting
	DIRECTORY	MP3 disc directory mode on/off
REC	VOLUME	Input level setting
	FADE IN	Fade-In time setting
	FADE OUT	Fade-Out time setting
	SRC	Sample rate converter on/off
	SYNC LEVEL	Operation level of sync record
	A_TRK	Auto track mode setting
	A_TRK LEVEL	Auto track operation level
TEXT	TEXT EDIT	Text setting
SYSTEM	KEYBOARD	Setting for keyboard type
	PLAY TIME	Confirming total play time
	REC TIME	Confirming total record time

PANELS AND REMOTE

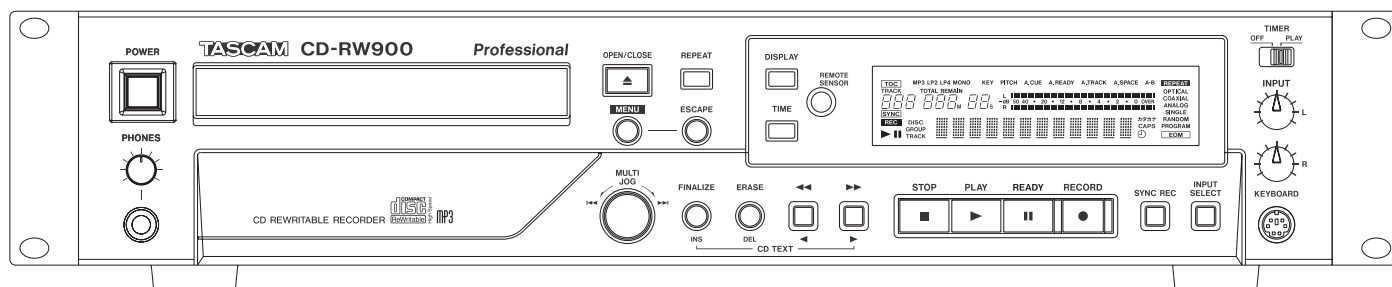
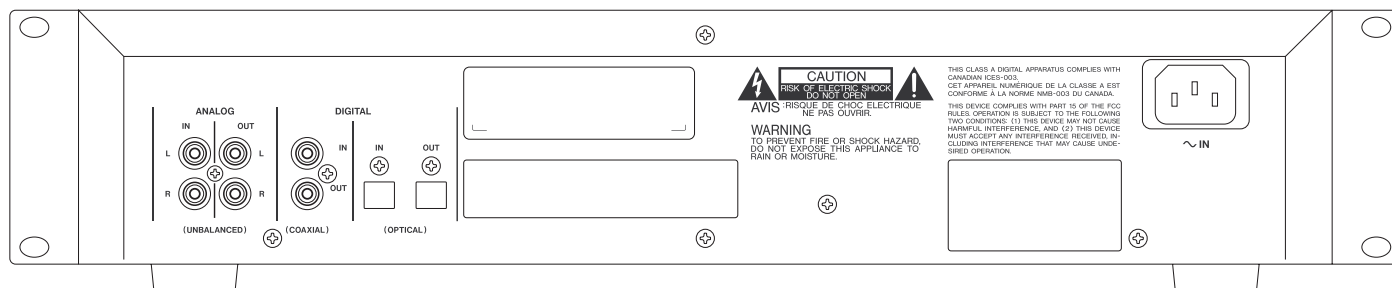

SPECIFICATIONS

Performance Specifications:

Recording Media:	CD-R, CD-RW, CD-RDA, CD-RWDA (high-speed CD-RW is supported)
Recording Resolution:	16-bit
Recording Sample Rate:	44.1kHz
Sample rate conversion from:	32kHz - 48kHz (with bypass)
Frequency Response:	20Hz - 20kHz ± 1 dB
Signal to Noise:	>95dB playback >90dB recording
Total Harmonic Distortion:	<0.006% playback <0.008% recording
Wow and flutter:	Unmeasurable (<0.001%)
Channel separation:	>90dB playback >80dB recording
Analog Inputs:	Unbalanced Input RCA pin, level -10dBV Minimum input level -19dBV Input Impedance 22k Ω $\pm 10\%$
Analog Outputs:	Unbalanced Input RCA pin, level -10dBV Maximum output level +6dBV ± 2 dB Output Impedance 600 Ω $\pm 10\%$
Phones Output:	Stereo (6.3), 20 mW, 32 Ω
Digital Input and Output:	Coaxial RCA, Optical TOSLINK

General Specifications:

Power Requirements:	USA/Canada: 120VAC, 60Hz UK/Europe: 230VAC, 50Hz Australia: 240VAC, 50Hz
Power Consumption:	16W (USA/Canada), 18W (Europe)
Dimensions:	482.6mm W x 94mm H x 308mm D (19" W x 3 7/8" H x 12" D)
Weight:	4.9kg (10.8 lbs)

